

MATERIAL

Aluminium, matte finish.
AISI 304 stainless steel screws and nuts.

STANDARD EXECUTIONS

- **GN 281-BL**: natural aluminium.
- **GN 281-SW**: aluminium, epoxy resin coating, RAL 9005 black colour.

FEATURES AND APPLICATIONS

The assembly hole of GN 281 connecting clamps allows an excellent match with tubes GN 990 (see page 1778).
GN 281 connecting clamps are an assembly of connecting clamps GN 271 (see page 1751) and GN 275 (see page 1756).
The clamping screws d3 may be replaced by clamping kits GN 911 (see page 1782).

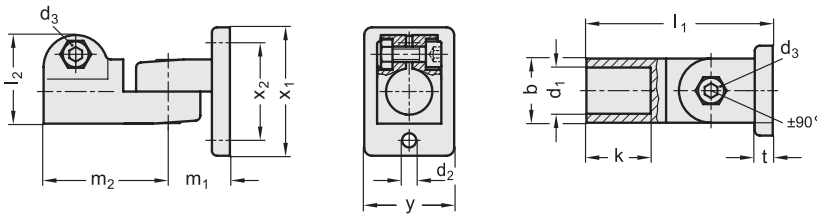
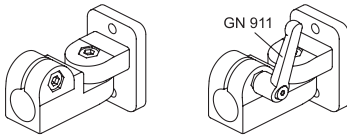

GN 281-BL

Code	Description	b	d1	d2	d3	k	l1	l2	m1	m2	t	x1	x2	y	d3 Clamping kit	⚖️
GN.61011	GN 281-B12-2-BL	25	12	5.5	M6	25	72.5	34.5	24	48.5	7	50	38	35	GN 911-M6-22	126
GN.61031	GN 281-B14-2-BL	25	14	5.5	M6	25	72.5	34.5	24	48.5	7	50	38	35	GN 911-M6-22	122
GN.61051	GN 281-B16-2-BL	25	16	5.5	M6	25	72.5	34.5	24	48.5	7	50	38	35	GN 911-M6-22	120
GN.61071	GN 281-B18-2-BL	25	18	5.5	M6	25	72.5	34.5	24	48.5	7	50	38	35	GN 911-M6-22	116

GN 281-SW

Code	Description	b	d1	d2	d3	k	l1	l2	m1	m2	t	x1	x2	y	d3 Clamping kit	⚖️
GN.61016	GN 281-B12-2-SW	25	12	5.5	M6	25	72.5	34.5	24	48.5	7	50	38	35	GN 911-M6-22	120
GN.61036	GN 281-B14-2-SW	25	14	5.5	M6	25	72.5	34.5	24	48.5	7	50	38	35	GN 911-M6-22	122
GN.61056	GN 281-B16-2-SW	25	16	5.5	M6	25	72.5	34.5	24	48.5	7	50	38	35	GN 911-M6-22	120
GN.61076	GN 281-B18-2-SW	25	18	5.5	M6	25	72.5	34.5	24	48.5	7	50	38	35	GN 911-M6-22	116

