

Conductor end sleeves AH, not insulated

Uninsulated/not-insulated conductor end sleeves for cabinet builders

Info

Now with UL approval

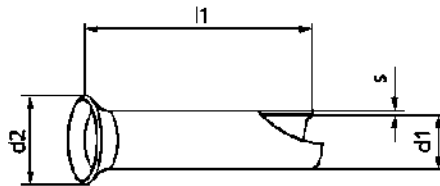

Benefits

Slightly funnel-shaped opening makes it easy to slip it onto the core

Application range

Control cabinet wiring

Norm references / Approvals

In accordance with DIN 46228

UL File No. E507990, see table

Technical Data

Classification ETIM 5:

ETIM 5.0 Class-ID: EC000005

ETIM 5.0 Class-Description: Cable end sleeve

Classification ETIM 6:

ETIM 6.0 Class-ID: EC000005

ETIM 6.0 Class-Description: Cable end sleeve

Material:

Tinned electrolyte copper

Temperature range:

- 55 °C up to +200 °C

Note

Other sizes are available upon request.

Photographs and graphics are not to scale and do not represent detailed images of the respective products.

Prices are net prices without VAT and surcharges. Sale to business customers only.

Conductor end sleeves AH, not insulated

| Article number | Article designation | For mm ² | UL certification | l1 mm | d1 mm | d2 mm | s mm | Suitable crimp insert | Pieces / PU |
|---|---------------------|---------------------|------------------|-------|-------|-------|------|-----------------------|-------------|
| Conductor end sleeves AH, not insulated | | | | | | | | | |
| 62120200 | AH DIN 0,5/6 | 0.5 | yes | 6 | 1 | 2.1 | 0.15 | PEW 12.090 | 500 |
| 62120210 | AH DIN 0,75/6 | 0.75 | yes | 6 | 1.2 | 2.3 | 0.15 | PEW 12.090 | 500 |
| 61721530 | AH DIN 0,75/10 | 0.75 | yes | 10 | 1.2 | 2.3 | 0.15 | PEW 12.090 | 500 |
| 62120220 | AH DIN 1/6 | 1 | yes | 6 | 1.4 | 2.5 | 0.15 | PEW 12.090 | 500 |
| 61721540 | AH DIN 1/10 | 1 | yes | 10 | 1.4 | 2.5 | 0.15 | PEW 12.090 | 500 |
| 62120230 | AH DIN 1,5/7 | 1.5 | yes | 7 | 1.7 | 2.8 | 0.15 | PEW 12.090 | 500 |
| 61721550 | AH DIN 1,5/10 | 1.5 | yes | 10 | 1.7 | 2.8 | 0.15 | PEW 12.090 | 500 |
| 62120240 | AH DIN 2,5/7 | 2.5 | yes | 7 | 2.2 | 3.4 | 0.15 | PEW 12.090 | 500 |
| 61721560 | AH DIN 2,5/12 | 2.5 | yes | 12 | 2.2 | 3.4 | 0.15 | PEW 12.090 | 500 |
| 62120250 | AH DIN 4/9 | 4 | yes | 9 | 2.8 | 4 | 0.2 | PEW 12.090 | 500 |
| 62120260 | AH DIN 6/10 | 6 | yes | 10 | 3.5 | 4.7 | 0.2 | PEW 12.090 | 500 |
| 62120270 | AH DIN 10/12 | 10 | yes | 12 | 4.5 | 5.8 | 0.2 | PEW 12.091 | 500 |
| 62120280 | AH DIN 16/12 | 16 | yes | 12 | 5.8 | 7.5 | 0.2 | PEW 12.091 | 500 |

Last Update (06.06.2023)

©2023 Lapp Group - Technical changes reserved

 Product Management www.lappkabel.de

You can find the current technical data in the corresponding data sheet.

PN 0456 / 02_03_16