

SIRIUS ACT: terminal module (command and LED module), integrated LED green, for front plate mounting



Figure similar

|                          |                 |
|--------------------------|-----------------|
| Product brand name       | SIRIUS ACT      |
| Product designation      | Terminal module |
| Product type designation | 3SU1            |

### Display

|  |     |
|--|-----|
| Display version  |     |
| <ul style="list-style-type: none"> <li>for diagnostic function: Supply voltage monitoring Power LED</li> </ul> | Yes |
| <ul style="list-style-type: none"> <li>status Tx/Rx link</li> </ul>  | No  |

### General technical data

|   |  |
|---|--|
| Product function  |  |
| <ul style="list-style-type: none"> <li>Reverse polarity protection</li> </ul> | Yes; Ribbon cable can be rotated 180°. |
| <ul style="list-style-type: none"> <li>Diagnostics function</li> </ul>        | Yes                                    |
| Firmware version  | 1.0.0                                  |
| Hardware version  | 1                                      |
| Software version with STEP 7 in the TIA Portal required                       | V13 SP1 (V13 SP1 and V14 with HSP0132) |
| Power loss [W] typical  | 0.115 W                                |

|   |        |
|---|--------|
| <b>Degree of pollution</b>                  | 3      |
| <b>Type of voltage</b>                      |        |
| • of the operating voltage                  | DC     |
| • of the input voltage                      | DC     |
| <b>Surge voltage resistance rated value</b> | 0.8 kV |
| <b>Consumed current</b>                     |        |
| • maximum                                   | 27 mA  |
| • Rated value                               | 23 mA  |
| <b>Protection class IP</b>                  | IP20   |
| Equipment marking acc. to DIN EN 81346-2    | K      |

#### Communication/ Protocol

|                              |    |
|------------------------------|----|
| <b>Protocol is supported</b> |    |
| • PROFI-safe protocol        | No |

#### Connections/Terminals

|   |   |
|---|---|
| <b>Type of electrical connection</b>                              | Insulation displacement connection            |
| <b>Type of connectable conductor cross-sections</b>               | Ribbon cable 7-pole, 7 x 0.08 mm <sup>2</sup> |
| <b>Connectable conductor cross-section for auxiliary contacts</b> |   |
| • single or multi-stranded  | 0.08 ... 0.08 mm <sup>2</sup>                 |
| • finely stranded with core end processing                        | 0.08 mm <sup>2</sup>                          |
| <b>Connectable conductor cross-section</b>                        |   |
| • solid   | 0.08 ... 0.08 mm <sup>2</sup>                 |
| • solid with core end processing                                  | 0.08 ... 0.08 mm <sup>2</sup>                 |
| • finely stranded with core end processing                        | 0.08 ... 0.08 mm <sup>2</sup>                 |
| • finely stranded without core end processing                     | 0.08 ... 0.08 mm <sup>2</sup>                 |
| <b>AWG number as coded connectable conductor cross section</b>    | 28 ... 28                                     |

#### Lamp

|                                  |       |
|----------------------------------|-------|
| <b>Color of the light source</b> | green |
|----------------------------------|-------|

#### Safety related data

|                             |      |
|-----------------------------|------|
| <b>Service life maximum</b> | 20 y |
|-----------------------------|------|



#### Ambient conditions

|  |  |
|--|--|
| <b>Ambient temperature</b>   |  |
| • during operation   | -25 ... +60 °C   |
| • during storage   | -40 ... +80 °C   |
| Environmental category during operation acc. to IEC 60721                            | 3M6, 3S2, 3B2, 3K6 (with relative air humidity of 10 ... 95 %, no condensation in operation permitted) |
| <b>Explosion protection marking for intrinsic safety of related equipment EEx ia</b> | No   |
| <b>Explosion protection marking for intrinsic safety of related equipment EEx ib</b> | No   |

## Installation/ mounting/ dimensions

|  |                  |
|--|------------------|
| Mounting type of modules and accessories | Snap-on mounting |
| Height                                   | 32.6 mm          |
| Width                                    | 30 mm            |
| Depth                                    | 31.5 mm          |

## Certificates/approvals

| General Product Approval  | Declaration of Conformity   | Test Certificates   | other  |
|---|---|---|--|
| <br>UL |  | <br>EG-Konf. | <a href="#">Declaration of the Compliance with the order</a><br><a href="#">Special Test Certificate</a><br><a href="#">Confirmation</a> |

## Further information

### Information- and Downloadcenter (Catalogs, Brochures,...)

<http://www.siemens.com/industrial-controls/catalogs>

### Industry Mall (Online ordering system)

<https://mall.industry.siemens.com/mall/en/en/Catalog/product?mlfb=3SU1401-1MC40-1CA1>

### Cax online generator

<http://support.automation.siemens.com/WW/CAXorder/default.aspx?lang=en&mlfb=3SU1401-1MC40-1CA1>

### Service&Support (Manuals, Certificates, Characteristics, FAQs,...)

<https://support.industry.siemens.com/cs/ww/en/ps/3SU1401-1MC40-1CA1>

### Image database (product images, 2D dimension drawings, 3D models, device circuit diagrams, EPLAN macros, ...)

[http://www.automation.siemens.com/bilddb/cax\\_de.aspx?mlfb=3SU1401-1MC40-1CA1&lang=en](http://www.automation.siemens.com/bilddb/cax_de.aspx?mlfb=3SU1401-1MC40-1CA1&lang=en)

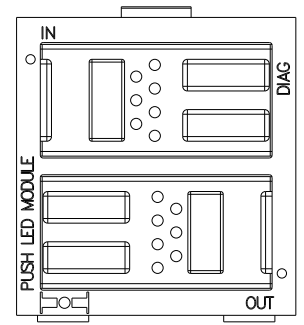
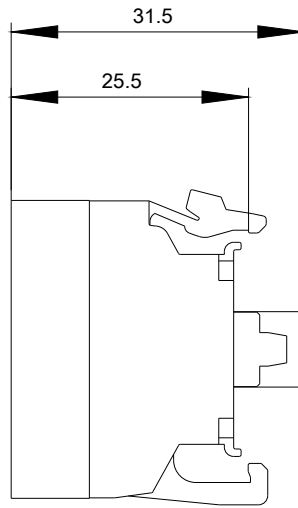
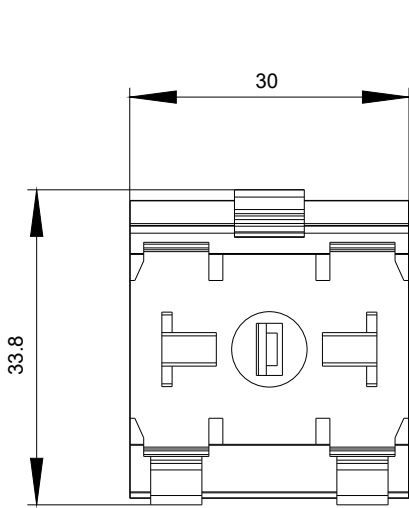

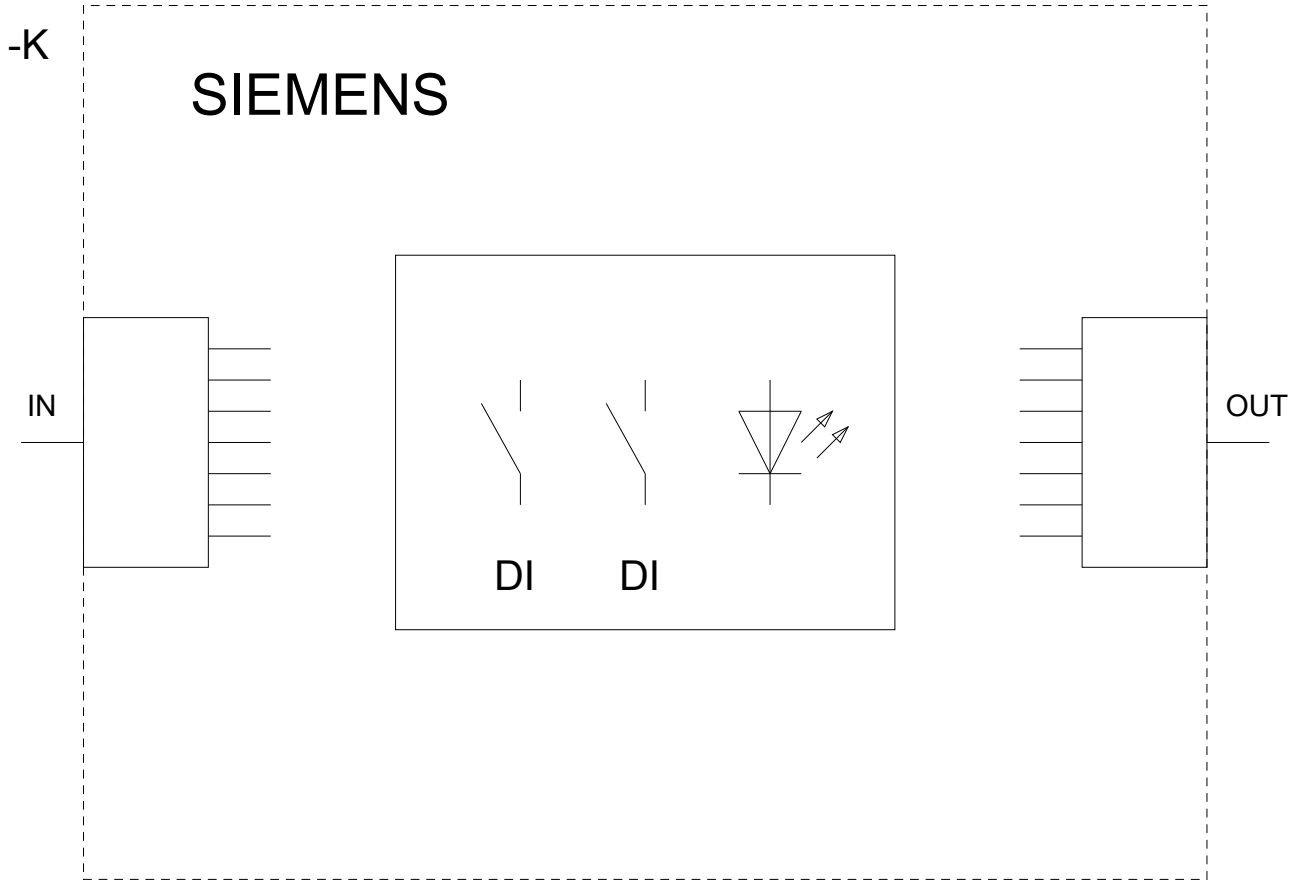

last modified:

09/25/2017