

PT 1,5 series

PCB terminal blocks with screw connection up to 1.5 mm²

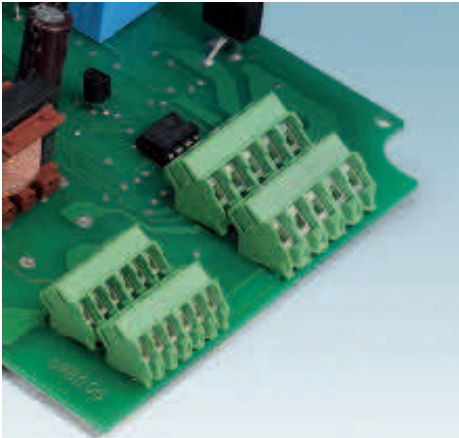

- High terminal block capacity thanks to rectangular terminal block space
- 3.5 mm pitch
- Highly flexible conductor protection for easy, repeat connection
- Rugged design with high current carrying capacity
- Plus/minus screw

Notes:
1) Please observe the current carrying capacity curves. Other current carrying capacity curves are available on request.
2) When using ferrules, a maximum of 125 V is only achieved in combination with surge voltage category/pollution degree II/2.

Accessories		
For all types	Type	Page
	Marker cards SK 3,5/2,8	841
	Screwdriver SZS 0,4 x 2,5 Order No. 1205037	

Current carrying capacity curve

Type: PTA 1,5/5-3,5
 Tested in accordance with DIN EN 60512-5-2:2003-01
 Reduction factor = 1
 No. of positions: 5

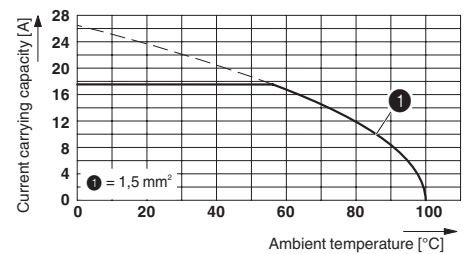

Technical data	PT 1,5/...-3,5-H			PT 1,5/...-3,5-V			PTA 1,5/...-3,5			No. of pos.	Dim. a [mm]
Technical data according to IEC/DIN VDE											
Rated current / conductor cross section [A] / [mm ²]	17.5 ¹⁾ / 1.5			17.5 ¹⁾ / 1.5			17.5 ¹⁾ / 1.5			2	3.50
Rated insulation voltage for pollution degree 2 [V]	200			200			200			3	7.00
Pitch [mm]	3.5			3.5			3.5			4	10.50
Connection capacity										5	14.00
Solid / stranded [mm ²] / [mm ²] / AWG	0.2 - 1.5 / 0.2 - 1.5 / 26 - 16			0.2 - 1.5 / 0.2 - 1.5 / 26 - 16			0.14 - 1.5 / 0.14 - 1.5 / 26 - 16			6	17.50
Stranded with ferrules without plastic sleeve [mm ²]	-			-			-			7	21.00
Stranded with ferrules with plastic sleeve [mm ²]	0.25 - 0.75 ²⁾			0.25 - 0.75 ²⁾			0.25 - 0.75 ²⁾			8	24.50
Multi-conductor connection capacity (two conductors with the same cross section)										9	28.00
Solid / stranded [mm ²]	0.2 - 0.34 / 0.2 - 0.5			0.2 - 0.34 / 0.2 - 0.5			0.14 - 0.5 / 0.14 - 0.5			10	31.50
Stranded with ferrules without plastic sleeve [mm ²]	-			-			-			11	35.00
Stranded with TWIN ferrule with plastic sleeve [mm ²]	-			-			-			12	38.50
Insulation coordination										13	42.00
Surge voltage category / pollution degree	III / 3	III / 2	II / 2	III / 3	III / 2	II / 2	III / 3	III / 2	II / 2	14	45.50
Rated insulation voltage [V]	160	200	400	160	200	400	160	200	400	15	49.00
Rated surge voltage [kV]	2.5	2.5	2.5	2.5	2.5	2.5	2.5	2.5	2.5	16	52.50
Approval data (UL/CUL) Use Group	B	C	D	B	C	D	B	C	D		
Nominal voltage [V]	300	-	300	300	-	300	300	-	300		
Nominal current [A]	10	-	10	10	-	10	10	-	10		
Connection capacity AWG	26 - 16	-	26 - 16	26 - 16	-	26 - 16	26 - 16	-	26 - 16		
Approval data (CSA) Use Group	B	C	D	B	C	D	B	C	D		
Nominal voltage [V]	-	-	-	-	-	-	-	-	-		
Nominal current [A]	-	-	-	-	-	-	-	-	-		
Connection capacity AWG	-	-	-	-	-	-	-	-	-		
General data											
Stripping length [mm]	5			5			5				
Screw thread	M2			M2			M2				
Tightening torque [Nm]	0.22 - 0.25			0.22 - 0.25			0.22 - 0.25				
Type of insulation material / insulation material group	PA / I			PA / I			PA / I				
Inflammability class according to UL 94	V0			V0			V0				
Drill hole diameter / pin dimensions [mm]	1.2 / 0.9 mm			1.2 / 0.9 mm			1.2 / 0.9 mm				

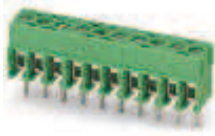

PCB screw terminal blocks, connection direction horizontal to the PCB

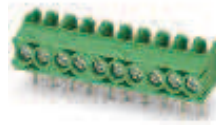

PCB screw terminal blocks, connection direction vertical to the PCB

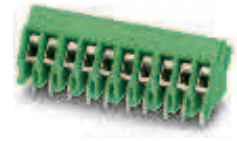

PCB screw terminal blocks with 45° angled connection direction



Dimensional drawing

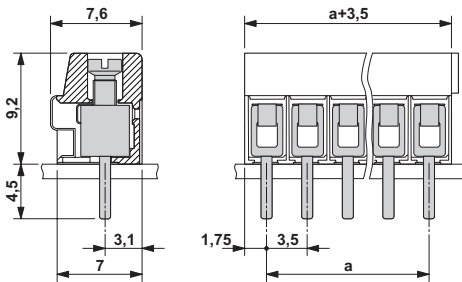

Drilling diagram

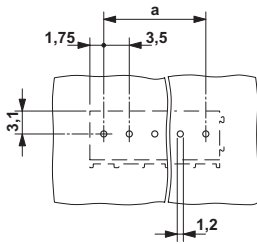

Dimensional drawing

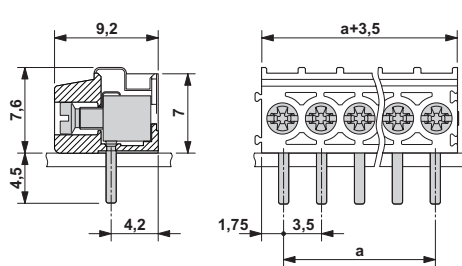

Drilling diagram

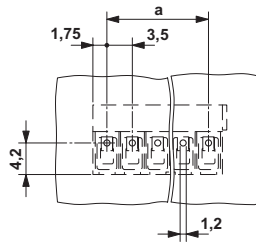

Dimensional drawing

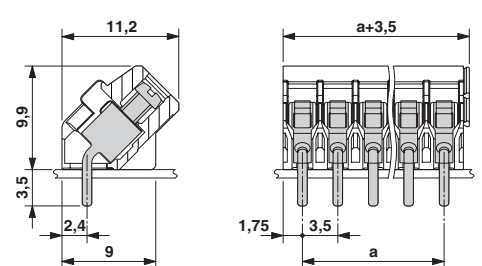

Drilling diagram

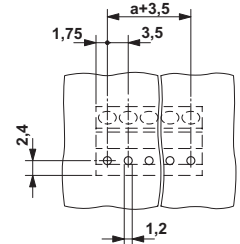

Ordering data

Type	Order No.	Pcs. / Pkt.
3.5 mm pitch, color: green		
PT 1,5/ 2-3,5-H	1984617	250
PT 1,5/ 3-3,5-H	1984620	250
PT 1,5/ 4-3,5-H	1984633	250
PT 1,5/ 5-3,5-H	1984646	100
PT 1,5/ 6-3,5-H	1984659	100
PT 1,5/ 7-3,5-H	1984662	100
PT 1,5/ 8-3,5-H	1984675	100
PT 1,5/ 9-3,5-H	1984688	100
PT 1,5/10-3,5-H	1984691	100
PT 1,5/11-3,5-H	1984701	50
PT 1,5/12-3,5-H	1984714	50
PT 1,5/13-3,5-H	1984727	50
PT 1,5/14-3,5-H	1984730	50
PT 1,5/15-3,5-H	1984743	50
PT 1,5/16-3,5-H	1984756	50

Ordering data

Type	Order No.	Pcs. / Pkt.
3.5 mm pitch, color: green		
PT 1,5/ 2-3,5-V	1984769	250
PT 1,5/ 3-3,5-V	1984772	250
PT 1,5/ 4-3,5-V	1984785	250
PT 1,5/ 5-3,5-V	1984798	100
PT 1,5/ 6-3,5-V	1984808	100
PT 1,5/ 7-3,5-V	1984811	100
PT 1,5/ 8-3,5-V	1984824	100
PT 1,5/ 9-3,5-V	1984837	100
PT 1,5/10-3,5-V	1984840	100
PT 1,5/11-3,5-V	1984853	50
PT 1,5/12-3,5-V	1984866	50
PT 1,5/13-3,5-V	1984879	50
PT 1,5/14-3,5-V	1984882	50
PT 1,5/15-3,5-V	1984895	50
PT 1,5/16-3,5-V	1984905	50

Ordering data

Type	Order No.	Pcs. / Pkt.
3.5 mm pitch, color: green		
PTA 1,5/ 2-3,5	1988956	250
PTA 1,5/ 3-3,5	1988969	250
PTA 1,5/ 4-3,5	1988972	250
PTA 1,5/ 5-3,5	1988985	100
PTA 1,5/ 6-3,5	1988998	100
PTA 1,5/ 7-3,5	1989007	100
PTA 1,5/ 8-3,5	1989010	100
PTA 1,5/ 9-3,5	1989023	100
PTA 1,5/10-3,5	1989036	100
PTA 1,5/11-3,5	1989049	50
PTA 1,5/12-3,5	1989052	50
PTA 1,5/13-3,5	1989065	50
PTA 1,5/14-3,5	1989078	50
PTA 1,5/15-3,5	1989081	50
PTA 1,5/16-3,5	1989094	50