

BUILT-IN FUSE BASE FOR CYLINDRICAL FUSES
 SIZE 14X51MM 50A, 1POLE+N



Figure similar

Model		
product brand name		SETRON
General technical data		
Number of poles		1
Mechanical Design		
Height	mm	90
Width	mm	54
Depth	mm	70
Certificates		
Equipment marking		F
<ul style="list-style-type: none"> • acc. to DIN EN 61346-2 • acc. to DIN EN 81346-2 		F
General Product Approval	Declaration of Conformity	Test Certificates



[other](#)

Further information

Information- and Downloadcenter (Catalogs, Brochures,...)

<http://www.siemens.com/lowvoltage/catalogs>

Industry Mall (Online ordering system)

<https://eb.automation.siemens.com/mall/en/WW/Catalog/Product/3NW7151>

Service&Support (Manuals, Certificates, Characteristics, FAQs,...)

<http://support.automation.siemens.com/WW/view/en/3NW7151/all>

Image database (product images, 2D dimension drawings, 3D models, device circuit diagrams, ...)

http://www.automation.siemens.com/bilddb/cax_en.aspx?mlfb=3NW7151

CAX-Online-Generator

<http://www.siemens.com/cax>

Tender specifications

<http://ausschreibungstexte.siemens.com/tiplv>

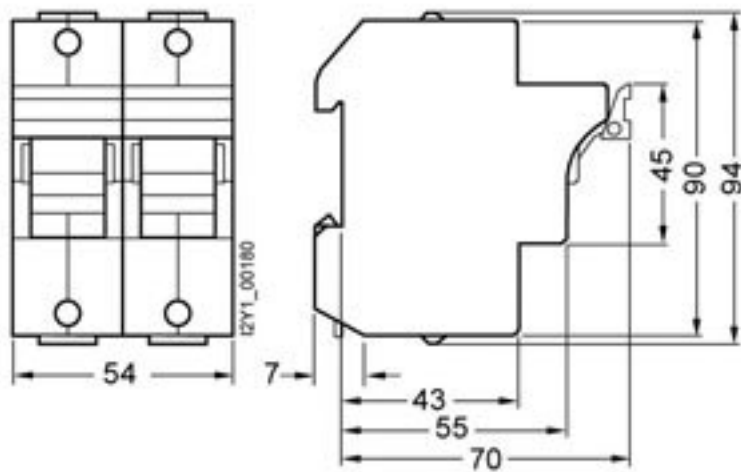

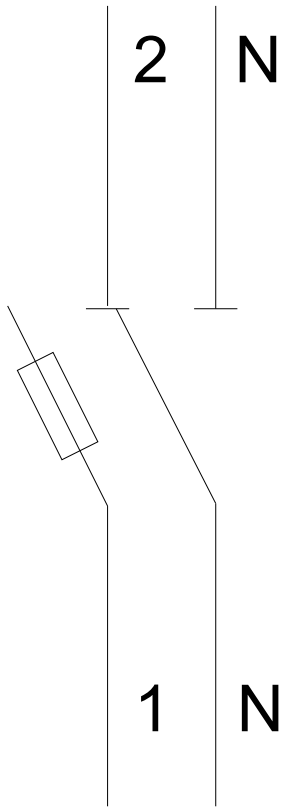

last modified:

11.03.2015