

EAO – Your Expert Partner for Human Machine Interfaces

704.631.1 - Pushbutton actuator round

704.631.1 - Pushbutton actuator round

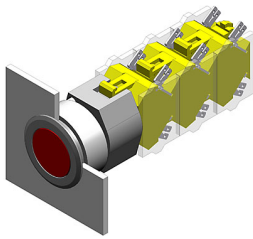

Attention: The preview is based on a sample product. This can differ from your current configuration.

Mounting

Mounting cut-out Design \varnothing 22,3 mm raised

Front

Front dimension \varnothing 29 mm
Front shape round

Other Attributes

Weight 0,009 kg

Operating-/Indication part

Lens illumination illuminative

IP-Rating

Front protection IP65

Actuator

Housing material Plastic
Housing colour grey
Switching action Momentary

Switching element

max. number of switching elements 3

Function

Pushbutton

EAO – Your Expert Partner for Human Machine Interfaces

704.631.1 - Pushbutton actuator round

Dimensions

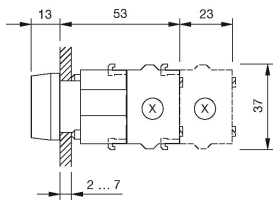

X = Screw terminal

Mounting cut-outs

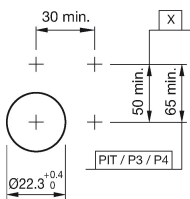

PIT = Push-in terminal

Wiring diagram



Additional information

Max. 3 switching elements can be clipped on

Legend

Switching action: B = Momentary