

## WE-R Male stud elbow

EO 24° cone end / Male BSPP thread – metal sealing edge (ISO 1179)

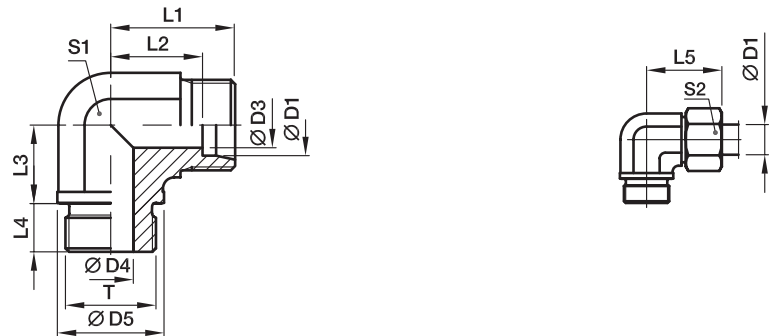

Series	D1	T	D3	D4	D5	L1	L2	L3	L4	L5	S1	S2	Weight g/1 piece	Order code*	PN (bar) <sup>1)</sup>		
															CF	71	MS
L <sup>3)</sup>	22	G 3/4 A	19	18	32	35	27.5	26	16	44	27	36	168	<b>WE22LR</b>	160	160	100
	28	G 1 A	24	23	39	38	30.5	30	18	47	36	41	305	<b>WE28LR</b>	160	160	100
	35	G 1 1/4 A	30	30	49	45	34.5	34	20	56	41	50	465	<b>WE35LR</b>	160	160	100
	42	G 1 1/2 A	36	36	55	51	40.0	39	22	63	50	60	706	<b>WE42LR</b>	160	160	100
S <sup>4)</sup>	20	G 3/4 A	16	16	32	37	26.5	26	16	48	27	36	210	<b>WE20SR</b>	400	400	250
	25	G 1 A	20	20	39	42	30.0	30	18	54	36	46	388	<b>WE25SR</b>	250	250	160
	30	G 1 1/4 A	25	25	49	49	35.5	34	20	62	41	50	630	<b>WE30SR</b>	160	160	100
	38	G 1 1/2 A	32	32	55	57	41.0	39	22	72	50	60	888	<b>WE38SR</b>	160	160	100

<sup>1)</sup> Pressure shown = item deliverable

<sup>3)</sup> L = light series; <sup>4)</sup> S = heavy series

$\frac{\text{PN (bar)}}{10} = \text{PN (MPa)}$

Delivery without nut and ring. Information on ordering complete fittings see page 17.

Order code suffixes		
Material	Suffix surface and material	Example
Steel, zinc plated, Cr(VI)-free	CFX	WE20SRCFX
Stainless Steel	71X	WE20SR71X
Brass	MSX	WE20SRMSX

\*Please add the **suffixes** below according to the material/surface required.