

# EAO – Your Expert Partner for Human Machine Interfaces

## 82-5151.1124 - Illuminated pushbutton 19 mm stainless-steel, momentary

### 82-5151.1124 - Illuminated pushbutton 19 mm stainless-steel, momentary



Attention: The preview is based on a sample product. This can differ from your current configuration.

#### Mounting

Mounting cut-out	Ø 19 mm
Design	flush

#### Front

Front dimension	Ø 22 mm
Front shape	round
Front ring shape	flush
Front bezel material	Stainless steel

#### Other Attributes

Operating voltage	24 V AC/DC
Weight	0,018 kg
Operation current	7 mA

#### Operating-/Indication part

Lens optics	opaque
Lens material	Stainless steel
Lens profile	flat
Lens illumination	illuminative
Lens colour	Stainless steel

#### IP-Rating

Front protection	IP65, IP67
------------------	------------

#### Connection Method

Terminal	Solder 2.8 x 0.5 mm
----------	---------------------

#### Actuator

Switching action	Momentary
------------------	-----------

#### Switching element

Switching current	3 A
Contact material	Silver
Contacts	1 C
Switching system	Snap-action switching element
Switching voltage	240 V AC/DC

#### Illumination

Illumination	Ring with blue LED
--------------	--------------------

#### Function

Illuminated pushbutton	
------------------------	--

# EAO – Your Expert Partner for Human Machine Interfaces

82-5151.1124 - Illuminated pushbutton 19 mm stainless-steel, momentary

## Dimensions

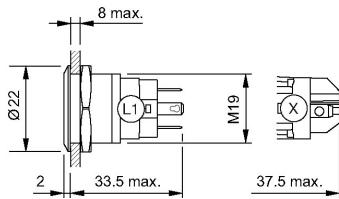

## Mounting cut-outs

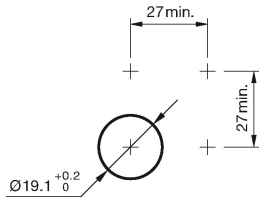

## Wiring diagram

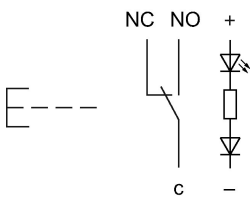

## Component layout

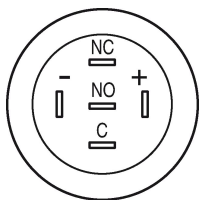

## Legend

Switching action: B = Momentary  
Contacts: C = Changeover