



## RM Cores

**Series/Type:** RM 5

The following products presented in this data sheet are being withdrawn.

| Ordering Code   | Substitute Product | Date of Withdrawal | Deadline Last Orders | Last Shipments |
|-----------------|--------------------|--------------------|----------------------|----------------|
| B65805C0000R026 | B65805C0000R048    | 2002-08-02         | 2002-12-31           | 2003-03-31     |
| B65805J0000Y042 | B65805J0000Y066    | 2002-08-02         | 2002-12-31           | 2003-03-31     |
| B65806K1004D002 | B65806K1006D002    | 2003-08-08         | 2004-02-29           | 2004-08-31     |
| B65539C1003X101 | B65539C1003X001    | 2004-01-23         |                      |                |
| B65806A50000000 |                    | 2004-10-18         | 2005-03-31           | 2005-09-30     |
| B65806A3002X022 | B65806C3001X022    | 2003-08-08         | 2004-02-29           | 2004-08-31     |
| B65539C1002X101 | B65539C1003X001    | 2003-08-08         | 2004-02-29           | 2004-08-31     |

For further information please contact your nearest EPCOS sales office, which will also support you in selecting a suitable substitute. The addresses of our worldwide sales network are presented at [www.epcos.com/sales](http://www.epcos.com/sales).

**RM 5**
**Core**
**B65805**

- In accordance with IEC 60431
- Core without center hole for transformer applications
- RM cores are supplied in sets

**Magnetic characteristics (per set)**

|              | with center hole | without center hole |                  |
|--------------|------------------|---------------------|------------------|
| $\Sigma l/A$ | 1,0              | 0,93                | mm <sup>-1</sup> |
| $l_e$        | 20,8             | 22,1                | mm               |
| $A_e$        | 20,8             | 23,8                | mm <sup>2</sup>  |
| $A_{min}$    | —                | 18                  | mm <sup>2</sup>  |
| $V_e$        | 430              | 526                 | mm <sup>3</sup>  |

**Approx. weight (per set)**

| $m$ | 2,9 | 3,0 | g |
|-----|-----|-----|---|
|     |     |     |   |

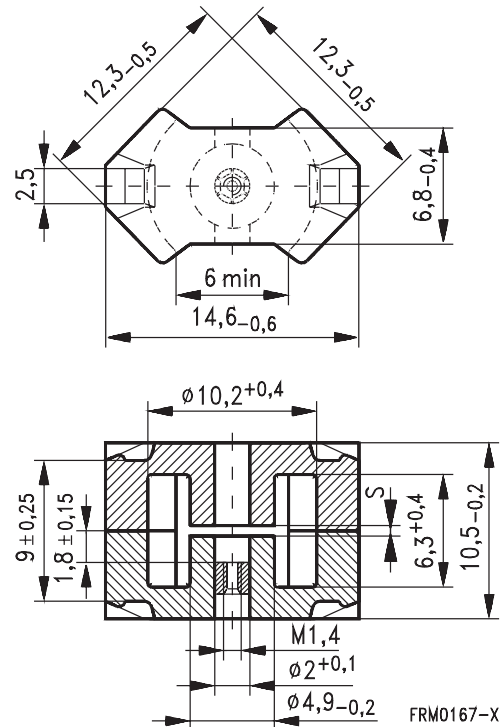
**Gapped**

| Material | $A_L$ value | $s$<br>approx.<br>mm | $\mu_e$ | Ordering code <sup>1)</sup><br>-C with center hole<br>-N with threaded sleeve |
|----------|-------------|----------------------|---------|---|
|          | nH          |                      |         |   |
| K1       | 25 ± 3 %    | 1,0                  | 19,9    | B65805-+25-A1   |
|          | 40 ± 3 %    | 0,40                 | 31,8    | B65805-+40-A1   |
| M33      | 63 ± 3 %    | 0,4                  | 50,2    | B65805-+63-A33  |
|          | 100 ± 3 %   | 0,2                  | 79,6    | B65805-+100-A33   |
| N48      | 160 ± 3 %   | 0,12                 | 128     | B65805-+160-A48   |
|          | 250 ± 3 %   | 0,06                 | 200     | B65805-+250-A48   |
|          | 315 ± 3 %   | 0,03                 | 255     | B65805-+315-A48   |

1) Replace the + by the code letter "C" or "N" for the required version.

**Ungapped**

| Material          | $A_L$ value<br>nH | $\mu_e$ | $A_{L1min}$<br>nH | $P_V$<br>W/set                      | Ordering code<br>-C with center hole<br>-J w/o center hole |
|-------------------|-------------------|---------|-------------------|-------------------------------------|--|
| N26               | 1800 + 30/- 20 %  | 1430    |                   |                                     | B65805-C-R26   |
| T57 <sup>1)</sup> | 2600 + 30/- 20 %  | 1920    |                   |                                     | B65805-J-R57   |
| N30               | 3500 + 30/- 20 %  | 2590    |                   |                                     | B65805-J-R30   |
| T38               | 6700 + 40/- 30 %  | 4960    |                   |                                     | B65805-J-Y38   |
| T42               | 9600 + 40/- 30 %  | 7090    |                   |                                     | B65805-J-Y42   |
| N49               | 1300 + 30/- 20 %  | 960     | 810               | < 0,06<br>(50 mT, 500 kHz, 100 °C)  | B65805-J-R49   |
| N87               | 2000 + 30/- 20 %  | 1470    | 1200              | < 0,32<br>(200 mT, 100 kHz, 100 °C) | B65805-J-R87   |
| N97 <sup>1)</sup> | 2000 + 30/- 20 %  | 1470    | 1200              | < 0,24<br>(200 mT, 100 kHz, 100 °C) | B65805-J-R97   |
| N41               | 2600 + 30/- 20 %  | 1920    | 1200              | < 0,10<br>(200 mT, 100 kHz, 100 °C) | B65805-J-R41   |

1) Preliminary data

**Coil former**

Material: GFR thermosetting plastic (UL 94 V-0, insulation class to IEC 60085:

$H \cong \max.$  operating temperature 180 °C), color code blue

Solderability: to IEC 60068-2-20, test Ta, method 1 (aging 3): 235 °C, 2 s

Resistance to soldering heat: to IEC 60068-2-20, test Tb, method 1B: 350 °C, 3,5 s

Winding: see "Processing Notes", page 153

Pins squared in the start-of-winding area

For matching clamps and insulating washers see page 197

| Sections | $A_N$<br>mm <sup>2</sup> | $l_N$<br>mm | $A_R$ value<br>$\mu\Omega$ | Pins             | Ordering code  |
|----------|--------------------------|-------------|----------------------------|------------------|--|
| 1        | 9,5                      | 25          | 90                         | 4<br>5<br>6<br>8 | B65806-K1004-D1<br>B65806-K1005-D1<br>B65806-K1006-D1<br>B65806-K1008-D1 |
| 2        | 8,7                      | 25          | 94                         | 4<br>5<br>6      | B65806-K1004-D2<br>B65806-K1005-D2<br>B65806-K1006-D2                    |

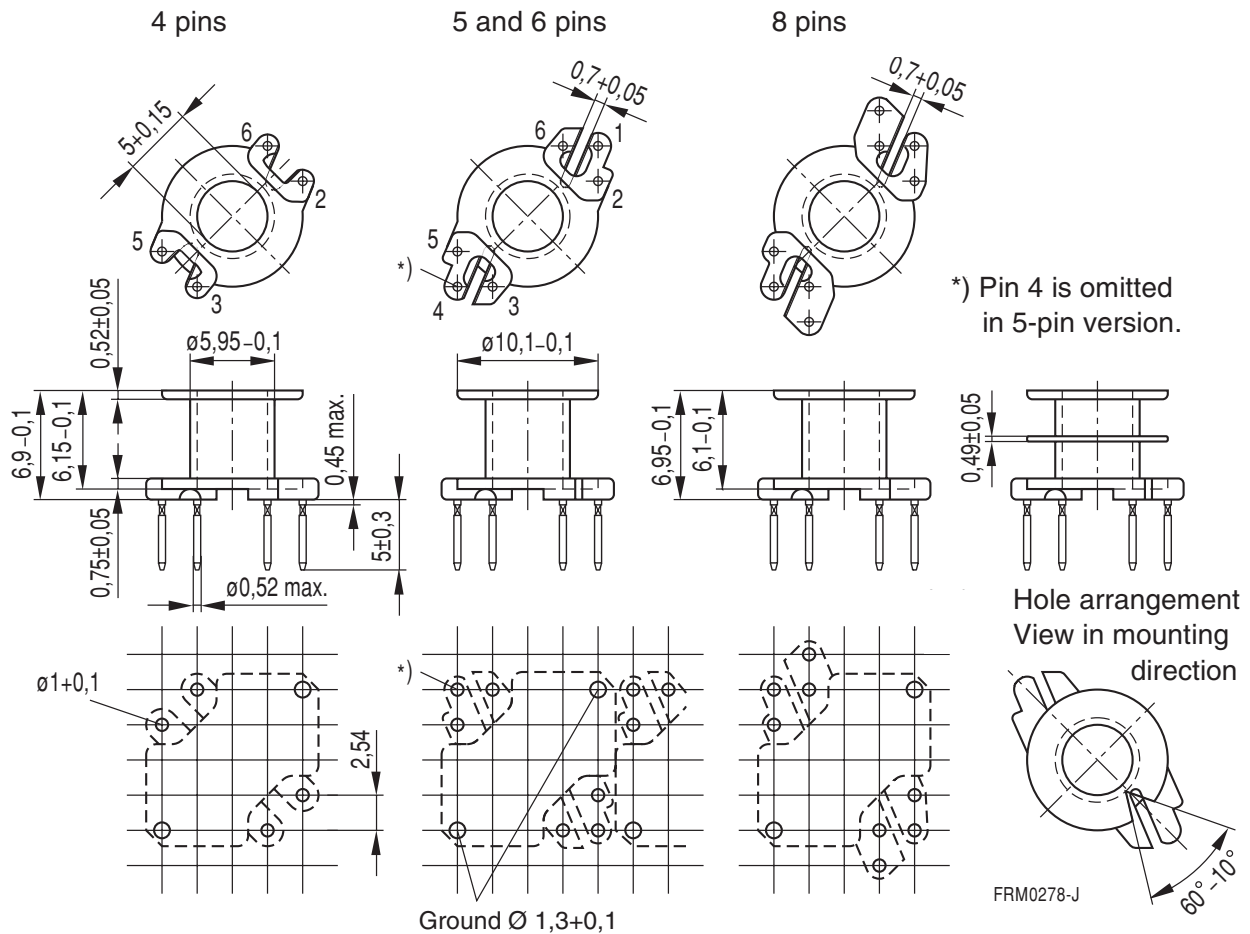

**Clamp**

- With ground terminal, made of stainless spring steel (tinned), 0,335 mm thick
- Solderability to IEC 60068-2-20, test Ta, method 1 (aging 3): 235 °C, 2 s
- Also available as strip clamp on reels

**Insulating washer 1** between core and coil former

- For tolerance compensation and for insulation
- Made of polycarbonate (UL 94 V-0, insulation class to IEC 60085: E  $\geq$  120 °C), 0,06 mm thick

**Insulating washer 2** for double-clad PCBs

- Made of polycarbonate (UL 94 V-0, insulation class to IEC 60085: E  $\geq$  120 °C), 0,3 mm thick

|   | Ordering code |
|---|---------------|
| Clamp (ordering code per piece, 2 are required) | B65806-A2203  |
| Insulating washer 1 (reel packing, PU = 1 reel) | B65806-A5000  |
| Insulating washer 2 (bulk)                      | B65806-D2005  |

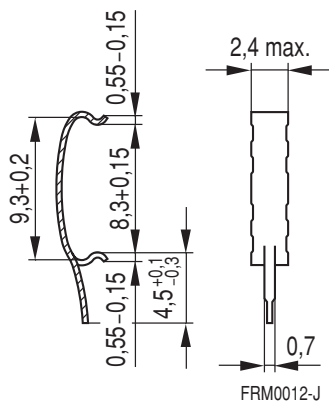
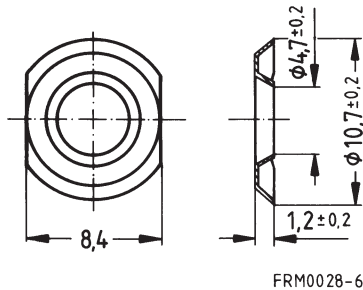
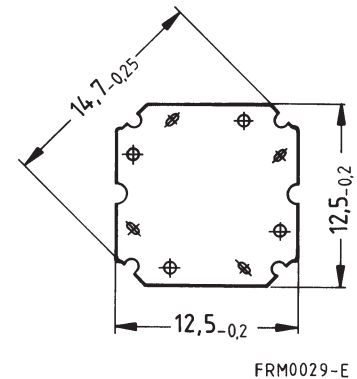
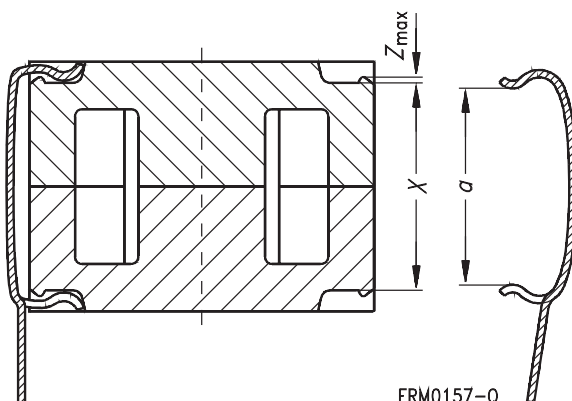
**Clamp**

**Insulating washer 1**

**Insulating washer 2**

**Clamping forces for RM 5**

$F_{min}$ : Extension of clamp from  $a$  to  $a_2 = X_{min}$   
 $F_{max}$ : Extension of clamp from  $a$  to  $a_1 = X_{max}$

|                              |           |            |
|------------------------------|-----------|------------|
| Clamp opening $a$ (mm)       |           | 8,3 + 0,15 |
| Core nose $Z_{max}$ (mm)     |           | 0,15       |
| Height of core pair $X$ (mm) | $X_{min}$ | 8,75       |
|                              | $X_{max}$ | 9,25       |
| Clamping force $F$ (N)       | $F_{min}$ | 5          |
|                              | $F_{max}$ | 40         |

**SMD**
**SMD coil former with gullwing terminals**

Material: GFR liquid crystal polymer (UL 94 V-0, insulation class to IEC 60085:

F  $\triangleq$  max. operating temperature 155 °C), color code black

Solderability: to IEC 60068-2-20, test Ta, method 1 (aging 3): 350 °C, 1 s

Resistance to soldering heat: to IEC 60068-2-20, test Tb, method 1B: 350 °C, 3,5 s

permissible soldering temperature for wire-wrap connection on coil former: 400 °C, 1 s

Winding: see "Processing Notes", page 160

**Clamp**

- Without ground terminal, made of stainless spring steel, 0,335 mm thick
- Also available as strip clamp (each carton containing 2 reels) on request

| Sections  | $A_N$<br>mm <sup>2</sup> | $l_N$<br>mm | $A_R$ value<br>$\mu\Omega$ | Terminals | Ordering code   |
|---|--------------------------|-------------|----------------------------|-----------|-----------------|
| 1   | 11,1                     | 25          | 77                         | 8         | B65822-F1008-T1 |
| 2   | 10,2                     | 25          | 85                         | 8         | B65822-F1008-T2 |
| Clamp (ordering code per piece, 2 are required) |                          |             |                            |           | B65806-J2204    |

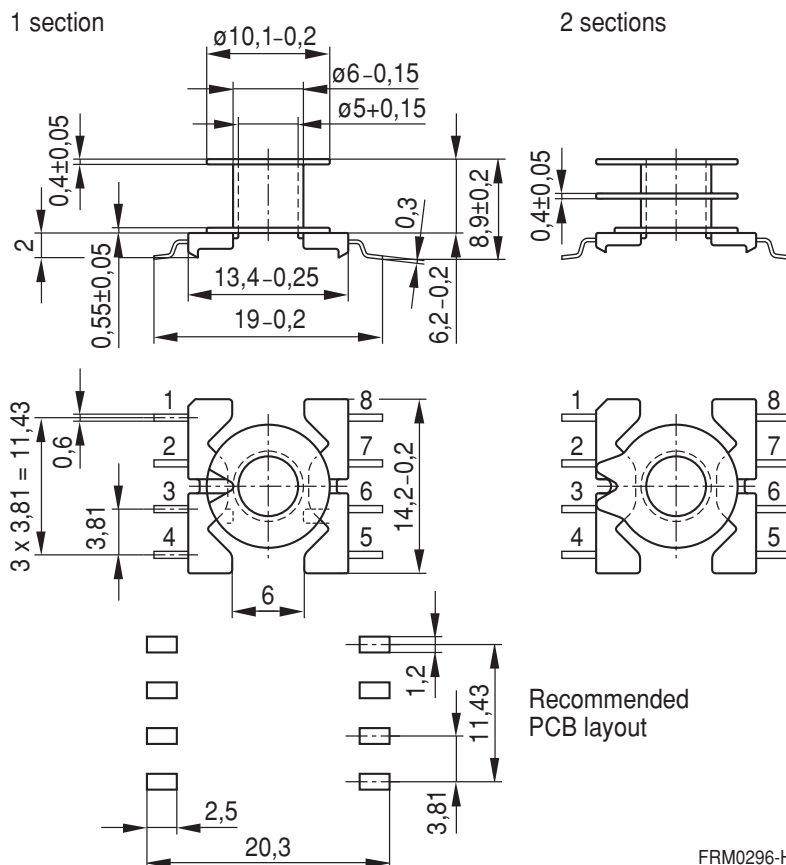
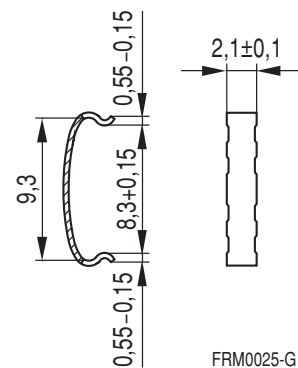
**Coil former**

**Clamp**

**SMD**
**SMD coil former with J terminals**

Material: GFR liquid crystal polymer (UL 94 V-0, insulation class to IEC 60085:

F  $\triangleq$  max. operating temperature 155 °C), color code black

Solderability: to IEC 60068-2-20, test Ta, method 1 (aging 3): 350 °C, 1 s

Resistance to soldering heat: to IEC 60068-2-20, test Tb, method 1B: 350 °C, 3,5 s

permissible soldering temperature for wire-wrap connection on coil former: 400 °C, 1 s

Winding: see "Processing Notes", page 160

**Clamp**

- Without ground terminal, made of stainless spring steel, 0,335 mm thick
- Also available as strip clamp (each carton containing 2 reels) on request

| Sections | $A_N$<br>mm <sup>2</sup>                  | $l_N$<br>mm | $A_R$ value<br>$\mu\Omega$ | Terminals | Ordering code   |
|----------|---|-------------|----------------------------|-----------|-----------------|
| 1        | 11,1                                      | 25          | 73                         | 8         | B65822-J1008-T1 |
| Clamp    | (ordering code per piece, 2 are required) |             |                            |           | B65806-J2204    |

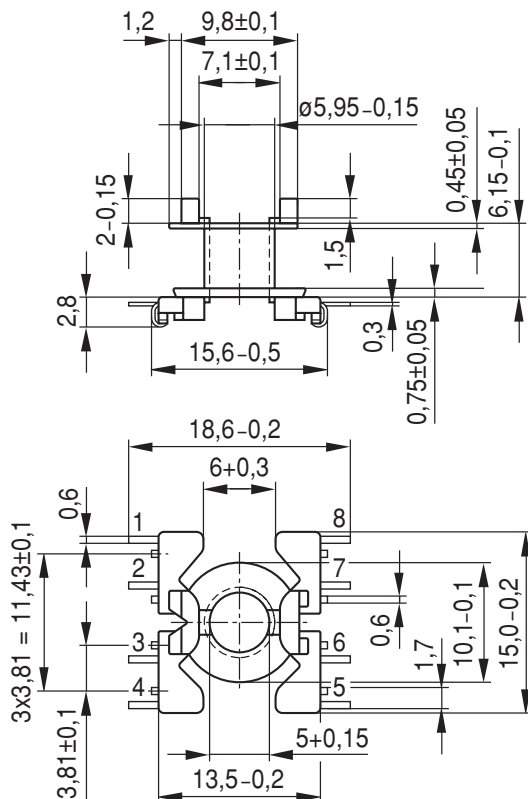
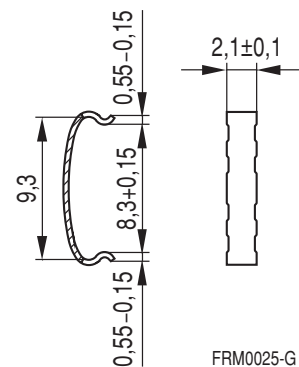
**Coil former**

**Clamp**

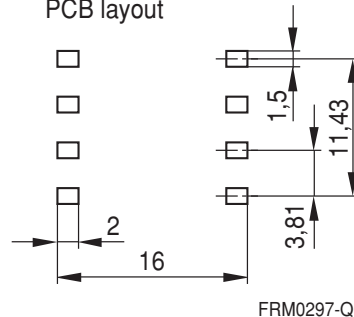
FRM0025-G

**Recommended PCB layout**

FRM0297-Q

### Adjusting screw

- Tube core with thread and core brake made of GFR polyterephthalate

Plastic **adjusting screwdriver** (not shown)

Plastic **handle** for adjusting screwdriver (not shown)

| Core RM 5                    |                         | Adjusting screw |                               |          |            | Min. adjusting range % | Ordering code     |
|------------------------------|-------------------------|-----------------|-------------------------------|----------|------------|------------------------|-------------------|
| Material                     | A <sub>L</sub> value nH | Fig.            | Tube core<br>∅ × length<br>mm | Material | Color code |                        |                   |
| K 1                          | 25                      | a               | 1,81 × 2,0                    | Si 1     | black      | 13                     | B65539-C1003-X101 |
|                              | 40                      | a               | 1,81 × 2,0                    | K 1      | yellow     | 16                     | B65539-C1003-X1   |
| M 33                         | 63                      | a               | 1,81 × 2,7                    | Si 1     | white      | 11                     | B65539-C1002-X101 |
|                              | 100                     | a               | 1,81 × 2,0                    | K 1      | yellow     | 14                     | B65539-C1003-X1   |
| N 48                         | 160                     | a               | 1,81 × 2,7                    | N 22     | red        | 15                     | B65539-C1002-X22  |
|                              | 250<br>315              | b               | 1,81 × 3,4                    | N 22     | green      | 13<br>9                | B65806-C3001-X22  |
|                              | 315                     | b               | 1,90 × 3,4                    | N 22     | blue       | 12                     | B65806-A3002-X22  |
| <b>Adjusting screwdriver</b> |                         |                 |                               |          |            |                        | B63399-B4         |
| <b>Handle</b>                |                         |                 |                               |          |            |                        | B63399-B5         |

### Adjusting screws

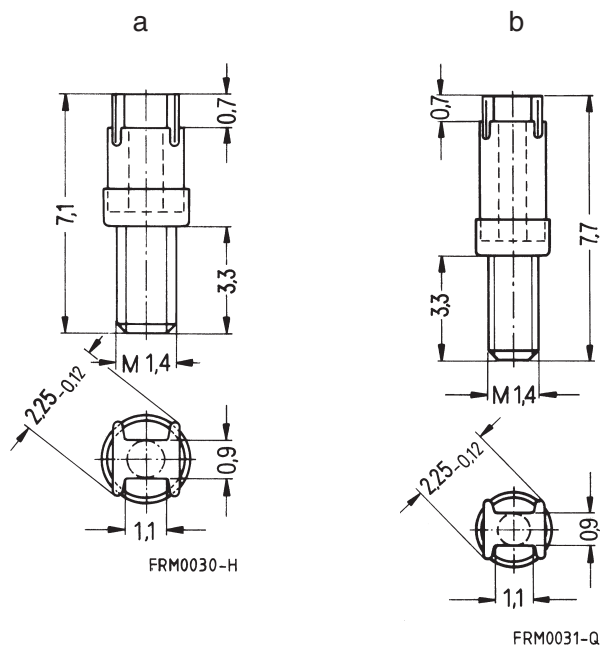



**Herausgegeben von EPCOS AG**

**Marketing Kommunikation, Postfach 80 17 09, 81617 München, DEUTSCHLAND**

© EPCOS AG 2000. Alle Rechte vorbehalten. Vervielfältigung, Veröffentlichung, Verbreitung und Verwertung dieser Broschüre und ihres Inhalts ohne ausdrückliche Genehmigung der EPCOS AG nicht gestattet.

Mit den Angaben in dieser Broschüre werden die Bauelemente spezifiziert, keine Eigenschaften zugesichert. Bestellungen unterliegen den vom ZVEI empfohlenen Allgemeinen Lieferbedingungen für Erzeugnisse und Leistungen der Elektroindustrie, soweit nichts anderes vereinbart wird.

Diese Broschüre ersetzt die vorige Ausgabe.

Fragen über Technik, Preise und Liefermöglichkeiten richten Sie bitte an den Ihnen nächstgelegenen Vertrieb der EPCOS AG oder an unsere Vertriebsgesellschaften im Ausland.

Bauelemente können aufgrund technischer Erfordernisse Gefahrstoffe enthalten. Auskünfte darüber bitten wir unter Angabe des betreffenden Typs ebenfalls über die zuständige Vertriebsgesellschaft einzuholen.

**Published by EPCOS AG**

**Marketing Communications, P.O. Box 80 17 09, 81617 Munich, GERMANY**

© EPCOS AG 2000. All Rights Reserved. Reproduction, publication and dissemination of this brochure and the information contained therein without EPCOS' prior express consent is prohibited.

The information contained in this brochure describes the type of component and shall not be considered as guaranteed characteristics. Purchase orders are subject to the General Conditions for the Supply of Products and Services of the Electrical and Electronics Industry recommended by the ZVEI (German Electrical and Electronic Manufacturers' Association), unless otherwise agreed.

This brochure replaces the previous edition.

For questions on technology, prices and delivery please contact the Sales Offices of EPCOS AG or the international Representatives.

Due to technical requirements components may contain dangerous substances. For information on the type in question please also contact one of our Sales Offices.