

## Spring Plungers with Ball and Internal Hexagon

**Material type black oxidized:** Body: Steel, black oxide finish.  
Ball: Steel, hardened. Spring: Stainless steel. Standard spring tension.

**Material type stainless:** Body: Stainless steel 1.4305 (AISI 303). Ball: Stainless steel, hardened.  
Spring: Stainless steel. Standard spring tension.

Temperature range: -40°C to +250°C.

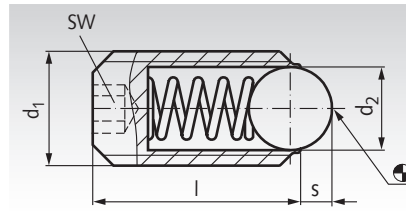

Ordering Details: e.g.: Product No. 65490300, Spring Plunger, black oxidized M3

Product No. black oxidized	Product No. stainless	d <sub>1</sub> mm	d <sub>2</sub> mm	l mm	s mm	SW mm	Spring Tension*		Weight g
							Initial N	End N	
654 903 00	654 999 03	M3	1,5	8	0,4	1,5	3,0	4,5	0,3
654 904 00	654 999 04	M4	2,5	12	0,8	2	8,5	14	0,7
654 905 00	654 999 05	M5	3,0	14	0,9	2,5	8,0	14	1,2
654 906 00	654 999 06	M6	3,5	15	1	3	11	18	2
654 908 00	654 999 08	M8	4,5	18	1,5	4	18	31	4
654 910 00	654 999 10	M10	6	23	2	5	24	45	8
654 912 00	654 999 12	M12	8	26	2,5	6	26	49	12
654 916 00	654 999 16	M16	10	33	3,5	8	41	86	31
654 920 00	654 999 20	M20	12	43	4,5	10	66	111	64
654 924 00	654 999 24	M24	15	48	5,5	12	81	151	100

\* Statistical average.

## Spring Plungers with Ball and Internal Hexagon, Strong Spring Tension

**Material type black oxidized:** Body: Steel, black oxide finish.  
Ball: Steel, hardened. Spring: Stainless steel. Strong spring tension.

**Material type stainless:** Body: Stainless steel 1.4305 (AISI 303). Ball: Stainless steel, hardened.  
Spring: Stainless steel. Strong spring tension.

Temperature range: -40°C to +250°C.

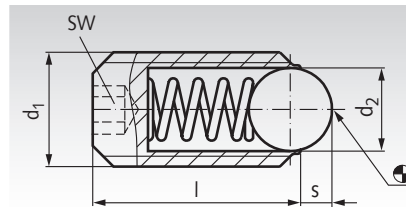

Ordering Details: e.g.: Product No. 65490300V Spring Plunger, strong, M3

Product No. black oxidized	Product No. stainless	d <sub>1</sub> mm	d <sub>2</sub> mm	l mm	s mm	SW mm	Spring Tension*		Weight g
							Initial N	End N	
654 903 00V	654 999 03V	M3	1,5	8	0,4	1,5	5	9	0,3
654 904 00V	654 999 04V	M4	2,5	12	0,8	2	12	18	0,8
654 905 00V	654 999 05V	M5	3,0	14	0,9	2,5	15	22	1,2
654 906 00V	654 999 06V	M6	3,5	15	1	3	19	28	2
654 908 00V	654 999 08V	M8	4,5	18	1,5	4	36	62	4
654 910 00V	654 999 10V	M10	6	23	2	5	57	104	8
654 912 00V	654 999 12V	M12	8	26	2,5	6	61	110	12
654 916 00V	654 999 16V	M16	10	33	3,5	8	68	142	31
654 920 00V	654 999 20V	M20	12	43	4,5	10	84	166	64
654 924 00V	654 999 24V	M24	15	48	5,5	12	127	237	100

\* Statistical average.

### Note

Used for fixation or as device to press something in or push it out.