

TECHNICAL SPECIFICATIONS

D-Sub Hood:

Material: UL 94 V-0 Plastic Material
 Plating: Nickel over Copper
 Operating Temperature: -55°C to +110°C
 Cable Entry: Side Entry
 Thumbscrews: UNC 4-40 (Standard)
 Cable O.D: Up to 11,5mm

Female D-Sub Solder Cup:

Insulator: PBT, Black, UL94 V-0
 Shell: Steel, Tin Plated
 Contact pins: Copper Alloy
 Stamped & Formed Pins: Class 3, 100 inserts min.
 Machined Contact Pins: Class 1, 500 inserts min.
 Contact Plating: Selective Gold over Nickel
 Operating Temperature: -55°C to +105°C
 Withstanding voltage: 1000V for 1 minute
 Insulator resistance: 1000MΩ min.

Features:

- Available in sizes 9-15-25-37
- Suitable for any common Sub-D Connector
- Strain relief inserts ensure a secure termination
- Re-openable
- Recyclable

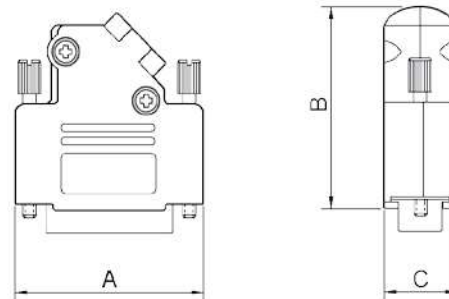

D-Sub-Hood

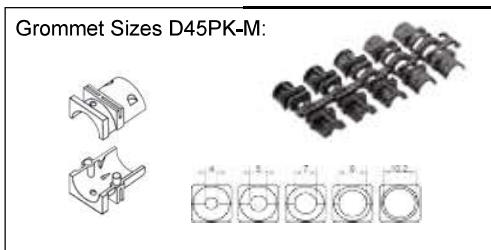

| Size D45PK-M | Dim A | Dim B | Dim C |
|--------------|-------|-------|-------|
| 9-way | 31,0 | 36,3 | 15,0 |
| 15-way | 39,5 | 40,3 | 15,0 |
| 25-way | 53,2 | 40,3 | 15,0 |
| 37-way | 69,7 | 40,3 | 15,0 |

Ordering information:

Class 3 D-Sub Connector Kits (100 inserts min.)

| Size: | P/N - Kitted: | Product Code - FEMALE Conn. Kit |
|--------|---------------|---------------------------------|
| 9-way | 6355-0009-11 | D45PK-M-09-DBS-K |
| 15-way | 6355-0009-12 | D45PK-M-15-DBS-K |
| 25-way | 6355-0009-13 | D45PK-M-25-DBS-K |
| 37-way | 6355-0009-14 | D45PK-M-37-DBS-K |

Ordering information:

Class 1 D-Sub Connector Kits (500 inserts min.)

| Size: | P/N - Kitted: | Product Code - FEMALE Conn. Kit |
|--------|---------------|---------------------------------|
| 9-way | 6355-0010-11 | D45PK-M-09-DMS-K |
| 15-way | 6355-0010-12 | D45PK-M-15-DMS-K |
| 25-way | 6355-0010-13 | D45PK-M-25-DMS-K |
| 37-way | 6355-0010-14 | D45PK-M-37-DMS-K |