

# Socketless FC332, 2556

Socketless  
Fittings

Socketless  
Armaturen

Raccords  
réutilisables  
„Socketless“

Raccordi  
riutilizzabili  
“Socketless”

Racores  
reutilizables  
“Socketless”

Banjo, DIN 7642

Ringstutzen, DIN  
7642

Banjo, DIN 7642

Nipplo ad occhio,  
DIN 7642

Banjo, DIN 7642

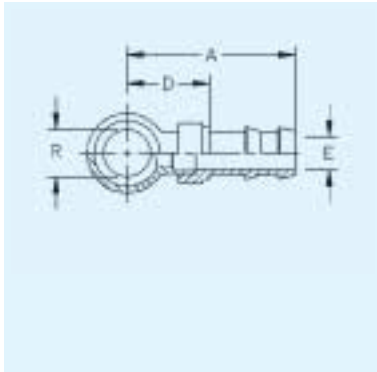

Part Number	Thread T	Flange Tube O.D. mm	Hose ND	Hose Size	A mm	D mm	H mm	E Ø mm	K Ø mm	R Ø mm	HEX [1]	HEX Nut [2]
11.057-4-4			6	-4	41	21		4		10		
11.057-6-4			6	-4	41	22		4		12		
11.057-8-6			10	-6	45	23		8		14		
11.057-10-6			10	-6	48	26		8		16		
11.057-13-8			12	-8	54	28		10		18		
11.057-16-10			16	-10	70	31		12		22		
11.057-20-12			19	-12	75	36		16		26		

Hose cap must be ordered separately.

Schlauchkappe muss separat bestellt werden.

Le bouchon de tuyauterie être commandé séparément.

Tappo del tubo flessibile deve essere ordinata esclusivamente.

El casquillo de la manguera se debe pedir por separado.

JIC Female Swivel

JIC-Dichtkopf

Femelle JIC

Femmina girevole  
JIC

Hembra loca JIC

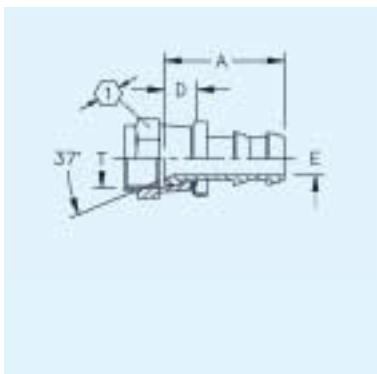

Part Number	Thread T	Flange Tube O.D. mm	Hose ND	Hose Size	A mm	D mm	H mm	E Ø mm	K Ø mm	R Ø mm	HEX [1]	HEX Nut [2]
4797-4B *	7/16-20		6	-4	29	10		4			14,2	
4741-6B	9/16-18		10	-6	32	10		8			19,05	
4797-8B *	3/4-16		12	-8	37	11		10			22,3	
4797-10B *	7/8-14		16	-10	51	12		12			25,4	
4741-12B	1 1/16-12		20	-12	53	14		16			31,7	

Partnumber complete with hose cap.  
Material: B=Brass.  
\* Universal (37° / 45°)

Teilnummer komplett mit Schlauchkappe.  
Material: B=Brass (Messing).  
\* Universal (37° / 45°)

Numéro d'article complet tuyauterie avec bouchons de protection.  
Matériau: B=Brass (Laiton).  
\* Universal (37° / 45°)

Numero dell'articolo completo con la protezione del tubo flessibile.  
Materiale: B=Brass (Ottone).  
\* Universal (37° / 45°)

Número del artículo completo con el casquillo de la manguera.  
Material: B=Brass (Latón).  
\* Universal (37° / 45°)

BSP-Female Swivel

BSP-Dichtkopf

Globeseal BSP

Femmina girevole  
gas

Hembra loca BSP

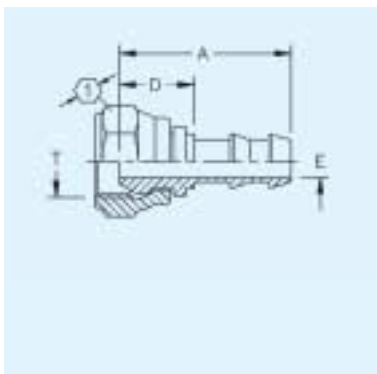

Part Number	Thread T	Flange Tube O.D. mm	Hose ND	Hose Size	A mm	D mm	H mm	E Ø mm	K Ø mm	R Ø mm	HEX [1]	HEX Nut [2]
11.390-4-4	G 1/4"		6	-4	37	17		4			17	
11.390-6-6	G 3/8"		10	-6	39	17		8			22	
11.390-8-8	G 1/2"		12	-8	44	18		10			27	
11.390-10-10	G 5/8"		16	-10	58	19		12			27	
11.390-12-12	G 3/4"		19	-12	58	19		16			32	

Hose cap must be ordered separately.

Schlauchkappe muss separat bestellt werden.

Le bouchon de tuyauterie être commandé séparément.

Tappo del tubo flessibile deve essere ordinata esclusivamente.

El casquillo de la manguera se debe pedir por separado.