



Figure similar

TEMPERATURE MONITORING RELAY
THERMOCOUPLE J,K,T,E,N,S,R,B, 2 THRESHOLDS,
DIGITAL, -99 DEGREES C TO 1800 DEGREES C
(SENSOR-DEPENDENT), 24 V TO 240 V AC/DC, 2 X 1
CO + 1 NO, WIDTH 45 MM,

General technical data:

Type of voltage		AC/DC
Supply voltage frequency		
<ul style="list-style-type: none"> • 1 for auxiliary and control current circuit — Initial rated value — Final rated value 	Hz	50
	Hz	60
Control supply voltage 1 with AC at 50 Hz		
<ul style="list-style-type: none"> • Initial rated value • Final rated value 	V	24
	V	240
Control supply voltage 1 with AC at 60 Hz		
<ul style="list-style-type: none"> • Initial rated value • Final rated value 	V	24
	V	240
Control supply voltage 1 for DC		
<ul style="list-style-type: none"> • Initial rated value • Final rated value 	V	24
	V	240
Product function		
<ul style="list-style-type: none"> • Fault storage • External reset 		Yes
		Yes
Number of measuring circuits		1
Number of NC contacts for auxiliary contacts		0
Number of NO contacts for auxiliary contacts		1
Number of CO contacts for auxiliary contacts		2
Measurable temperature		
<ul style="list-style-type: none"> • initial value • Full-scale value 	°C	-99
	°C	1 800

Equipment marking acc. to DIN EN 61346-2		K
Equipment marking acc. to DIN 40719 extended according to IEC 204-2 acc. to IEC 750		K
Ambient temperature during operation	°C	-25 ... +60

Mechanical data:

Type of electrical connection		spring-loaded terminals
<ul style="list-style-type: none"> • for auxiliary and control current circuit • Plug-in socket 		Yes
Design of the sensor connectable		type J, K, T, E, N (thermocouple)
Width	mm	45
Height	mm	108
Depth	mm	91

Certificates/ approvals:

General Product Approval	other
---------------------------------	--------------



[Environmental Confirmations](#)

[Declaration of Conformity](#)

Further information

Information- and Downloadcenter (Catalogs, Brochures,...)

<http://www.siemens.com/industrial-controls/catalogs>

Industry Mall (Online ordering system)

<http://www.siemens.com/industrymall>

Cax online generator

<http://support.automation.siemens.com/WW/CAXorder/default.aspx?lang=en&mlfb=3RS11422GW80>

Service&Support (Manuals, Certificates, Characteristics, FAQs,...)

<http://support.automation.siemens.com/WW/view/en/3RS11422GW80/all>

Image database (product images, 2D dimension drawings, 3D models, device circuit diagrams, EPLAN macros, ...)

<http://www.automation.siemens.com/bilddb/index.aspx?attID9=3RS11422GW80&lang=en>

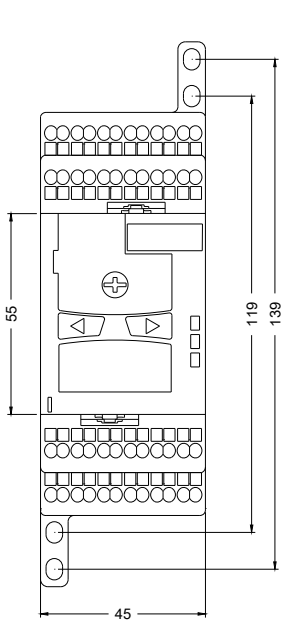

last modified:

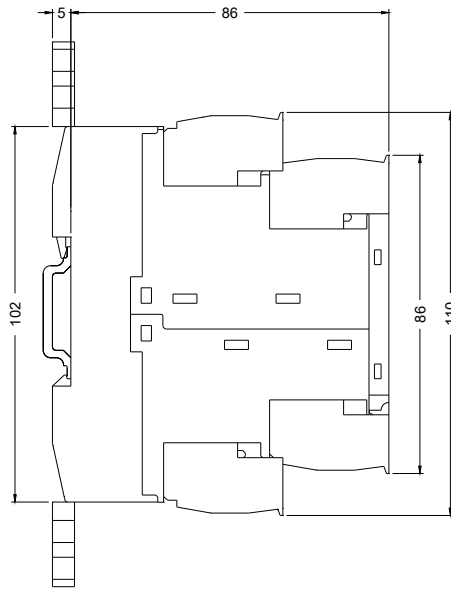

09.03.2015