

# Series CE1

Dimensions:  $\phi 12$ ,  $\phi 20$

Both ends tapped style:

CE1B Bore size — Stroke

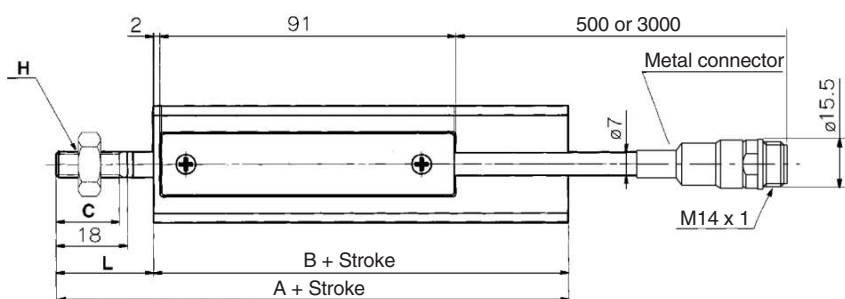
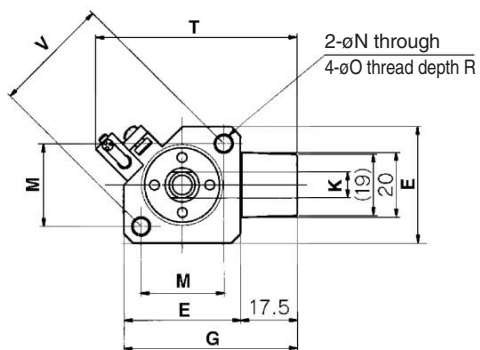
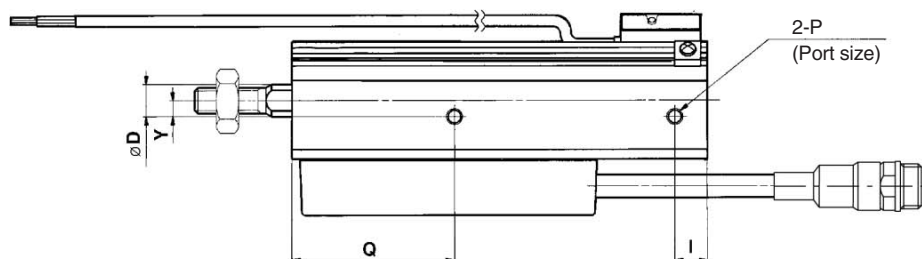

Bore size (mm)	Standard stroke	A	B	C	D	E	G	H	I	K	L	M
12	25, 50, 75, 100, 125, 150	94	69	15	6	25	42.5	M5 x 0.8	16	5.2	25	15.5
20	25, 50, 75, 100, 125, 150, 175, 200	106	78	15.5	10	36	53.5	M8 x 1.25	10	8	28	25.5

Bore size (mm)	N	O	P	Q	R	T*	V	Y
12	—	M4 x 0.7	M5 x 0.8	47	7	53.5	22	7
20	5.5	M6 x 1	M5 x 0.8	50	15	62.5	36	5

\* For rod nut and accessory bracket, refer to page 10-12-20. \* Dimensions for auto switch model D-F79W.