

Top View of Assembly

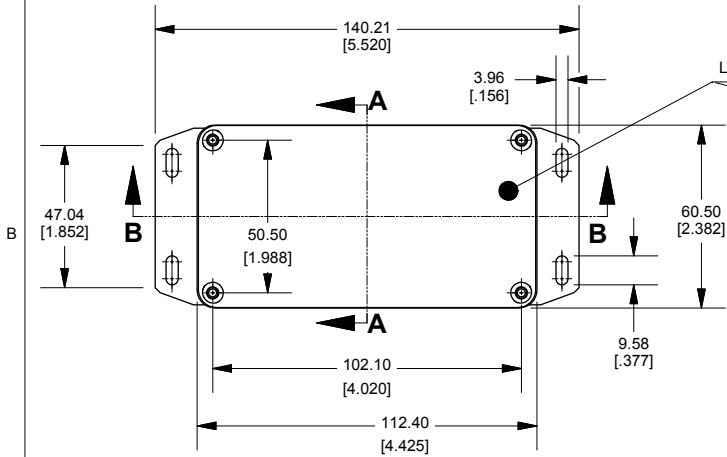

SECTION A-A End View of Assembly

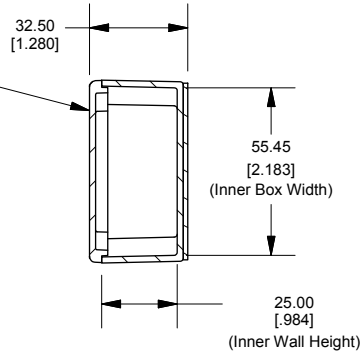

SECTION B-B Side View of Assembly

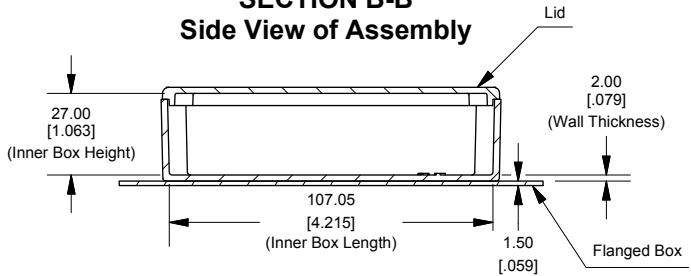

Top View Looking Inside Box

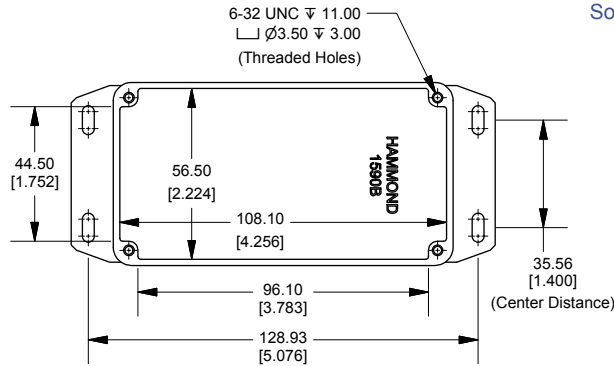

Lid

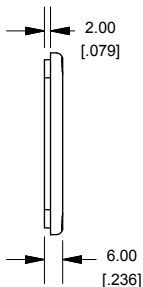
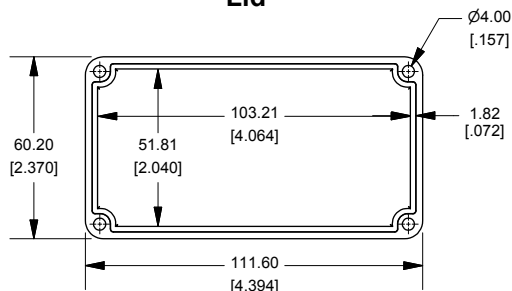

Enclosures can be Factory Modified (Milling, Drilling, Printing etc.)
 Contact Factory mjm@hammondmfg.com for quotes
 Solid models of this enclosure available in STEP or IGES.

NOTE

Purchased assembly includes box, lid and 4 cover screws.
 Box and lid are made from Diecast Aluminum Alloy.
 Silicone Gasket supplied with liquid resistant enclosure.
 Bottom Flange is Welded.

PART NUMBERS

1590BF Enclosure	
Natural Finish Enclosure	1590BF
Black Textured Enclosure	1590BFBK
1590BF Liquid Resistant Enclosure (Silicone Gasket)	
Natural Finish Enclosure	1590WBF
Black Textured Enclosure	1590WBFBK

ACCESSORIES

Recommended Torque: 75 ozf.in / 55 cN.m

Liquid Resistant Cover Screws

Stainless Steel Cover Screws (Pkg 100) [6-32 x 1/2" With O-Ring]	1590WMS100
Black Stainless Steel Cover Screws (Pkg 100) [6-32 x 1/2" With O-Ring]	1590WMS100BK
Standard Cover Screws	
Plated Cover Screws (Pkg 100) [6-32 x 1/2"]	1590MS100
Black Cover Screws (Pkg 100) [6-32 x 1/2"]	1590MS100BK

**HAMMOND
MANUFACTURING™**

1590BF

www.hammondmfg.com

Dimensions:
mm
[inches]