

16

NEB/J 21 R

Power supply connectors



Power supply chassis socket, angular version, with break contact, for printed circuit boards

---

State: Active

---

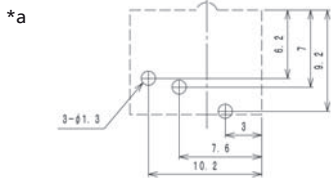
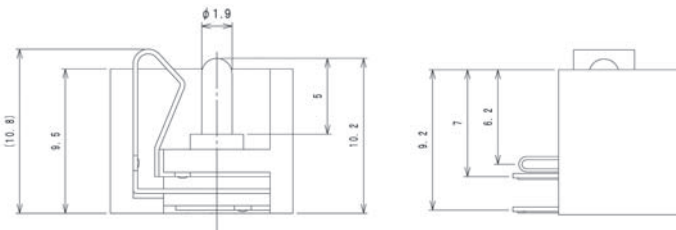
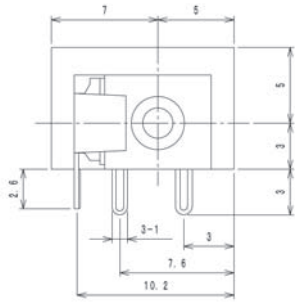

\*a printed circuit board layout, solder side view

**Environmental conditions**

Temperature range -20 °C/+70 °C

**Materials**

Insulating body PF  
Contact CuZn/CuSn, nickel-plated/silver-plated  
Housing PBT, HB according to UL94

**Mechanical data**

Diameter opening 6,0 mm  
Diameter center pin 1,9 mm  
Mating cycles  $\geq 5000$   
Insertion force  $\leq 30$  N  
Withdrawal force 3–30 N



**Electrical data (at T<sub>amb</sub> 20 °C)**

Contact resistance  $\leq 30$  m $\Omega$   
Rated current 0,5 A  
Rated voltage 12 V DC  
Rated impulse voltage 500 V/60 s  
Insulation resistance  $\geq 100$  M $\Omega$

**Associated products**

Counterparts  
 ☞ 1633 02      ☞ 1633 03      ☞ NES/J 21  
 ☞ NES/J 21 W      ☞ NES/J 210      ☞ XNES/J 210

16

NEB/J 21 R

Designation	Pole Number	PU (Pieces)	MDQ (Pieces)
NEB/J 21 R	2	250	750

**Packaging:**

in bulk, in a cardboard box or a plastic bag