

# Blade Connector



## FEATURES:

Nylon, fully-insulated

Male disconnect

Funnel entry

## SPECIFICATION:

Cross-section	1.5...2.5 mm <sup>2</sup>
Colour	Blue
Diameter (D)	4.4 mm
Material	Brass
Insulation material	Nylon
Surface material	Tin-plated
Diameter (d1)	2.3 mm
Temperature range	max. +105 °C
Length (L)	25 mm
Width (W)	6.4 mm
E	12.5 mm
F	8.1

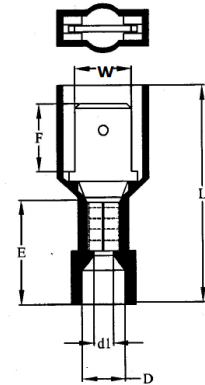

UL certified: E502428

Art. Nr.

RND 465-00696