

REFERENCE DRAWING

REV.	ECN.NO.	MODIFY.CONTENT	DATE
		SEE PAGE 1	

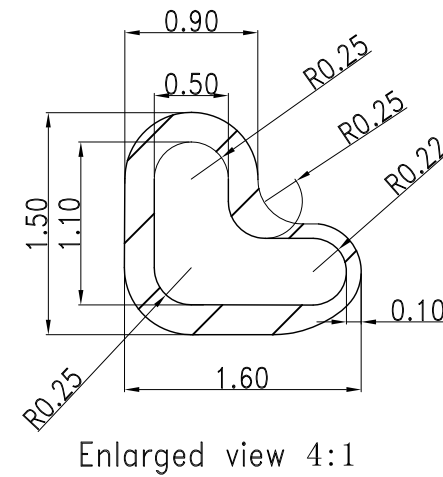

RECOMMENDED PCB LAYOUT
(Tolerance=±0.05)

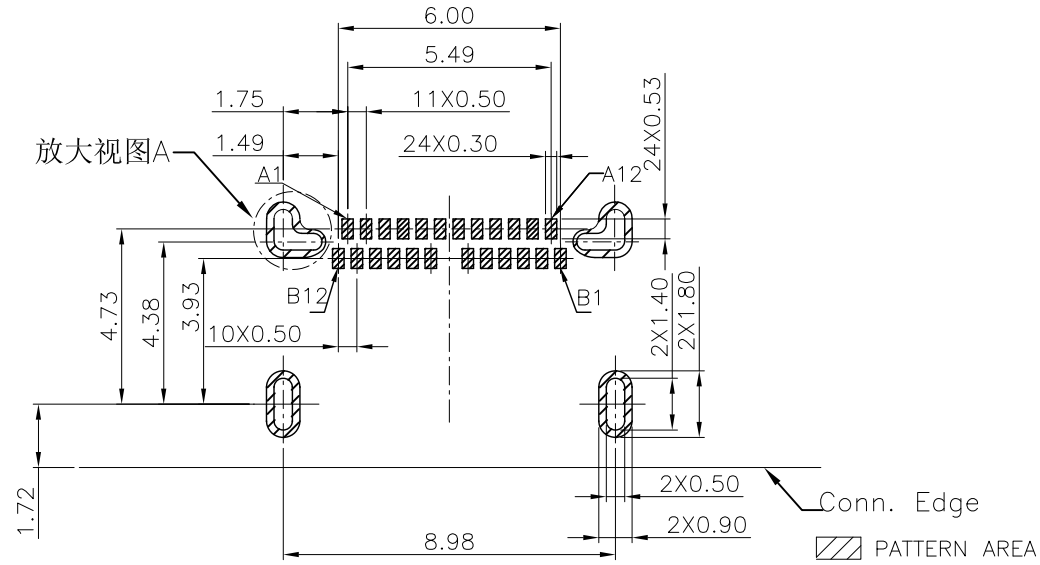
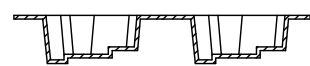
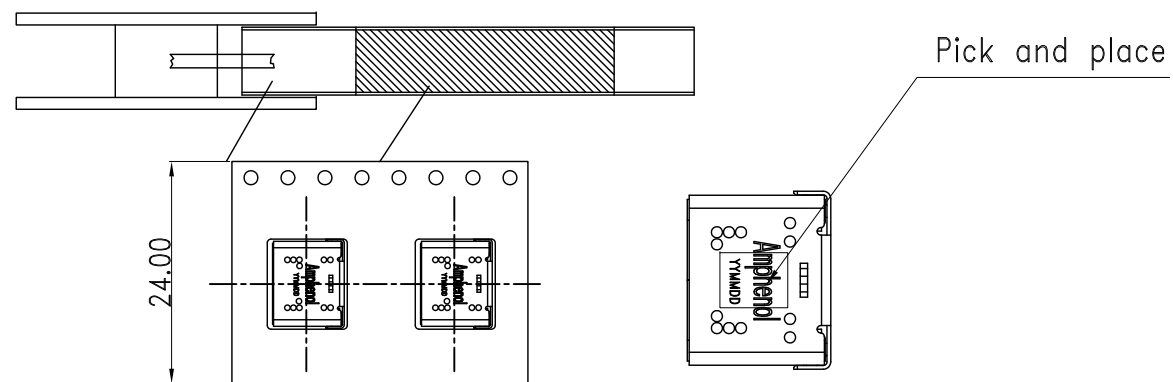

customer unwinding direction

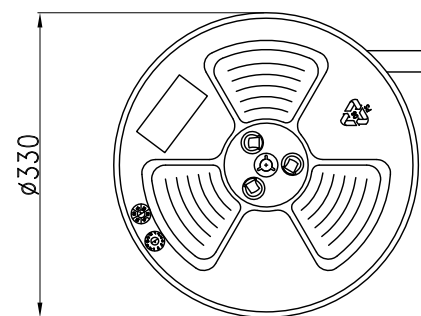

NOTES:

- 1.MATERIAL :SEE TABLE
- 2.COPLANARITY : 0.10 Max.
- 3.ELECTRICAL CHARACTERISTICS
 LOW LEVEL CONTACT RESISTANCE: 40mΩ Max
 INSULATION RESISTANCE:100MΩ MIN
 DIELECTRIC WITHSTANDING VOLTAGE:100 VAC:
 CONTACT CURRENT RATING:5A Max
- 4.MECHANICAL CHARACTERISTICS
 INSERTION FORCE: 5~20N
 EXTRACTION FORCE: 8~20N
 AFTER DURABILITY EXTRACTION FORCE: 6~20N
- 5.DURABILITY: 10000 CYCLES
- 6.PACKAGING TYPE: CARRIER TAPE.
- 7.SALT SPRAY : 8 HOURS
- 8.MATERIAL SHOULD BE FULFILLED AMPHENOL SPEC# SSN002 AND CUSTOMER REQUIREMENTS, FOR HALOGEN FREE PRODUCTS, ALSO NEED TO MEET SSN004

GENERAL TOLERANCE	FILE.NO.	C12401902	PART.NO.	12401902E212A	DRAWN	SUNNY.FAN	MATERIAL	SCALE	1:1
X.±0.50	REV.	X3	TITLE	USB TYPE C CONNECTOR TOP MOUNT	CHECKED	WEISON.LU	DATE	04-26-2018	MM
.X±0.38	SIZE		SHEET	20F2	APPROVED	TOM	Amphenol Shouhmin Industry		
.XX±0.20	A4								