



ER22G68

Lithium-thionyl Chloride
(Li-SOCl₂) Battery

ELECTRICAL CHARACTERISTICS

(typical values for cells stored for one year or less, at 25°C)

<p>● Nominal capacity</p> <p>(at 0.5 mA, +25°C, 2.0V cut off. The capacity restored by the cell varies according to current drain, temperature and cut off voltage.)</p>	0.4Ah
<p>● Rated voltage</p>	3.6V
<p>● Maximum recommended continuous current</p> <p>(To get 50% of the nominal capacity at +25°C with 2.0V cut off. Higher currents possible, consult EVE.)</p>	5mA
<p>● Maximum pulse current capability</p> <p>Rated 1 sec. pulse capability(to 3V)</p> <p>Pulse capability varies according to pulse characteristics (frequency and duration), temperature, cell history (storage conditions prior to usage) and the application's acceptable minimum voltage.</p>	20mA 10mA
<p>● Storage (recommended)</p> <p>(for more severe condition consult EVE)</p>	30°C max
<p>● Operating temperature range</p> <p>(Operation at temperature different from ambient may lead to reduced capacity and lower voltage plateau readings.)</p>	-55°C / +85°C
<p>● Typical weight</p>	6g

KEY FEATURES

- ✓ High and stable operating voltage
- ✓ High minimum voltage during pulsing
- ✓ Low self discharge rate (less than 1% after 1 year of storage at +25°C)
- ✓ Stainless steel container
- ✓ Hermetic glass-to-metal sealing
- ✓ Non-flammable electrolyte
- ✓ Compliant with IEC 86-4 safety standard and EN 50020 intrinsic safety
-  Underwriters Laboratories (UL) Component Recognition (File Number MH28717)

MAIN APPLICATIONS

- ✓ Utility metering
- ✓ Alarms and security devices
- ✓ Memory back-up
- ✓ Tracking systems
- ✓ Automotive electronics
- ✓ Professional electronics ... etc.

WARNING:

Fire, explosion and severe burn hazard. Do not recharge, crush, disassemble, heat above 100°C, incinerate, or expose contents to water.

Note: Any representations in this data sheet concerning performance are for informational purpose only and are not construed as warranties, either expressed or implied, of future performance.

1. DISCHARGE CHARACTERISTICS@+25°C

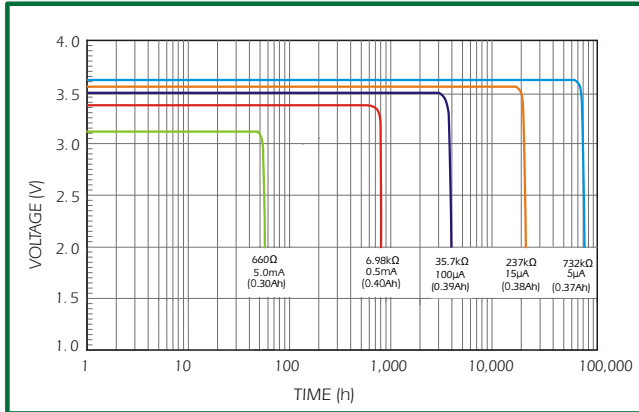

ER22G68

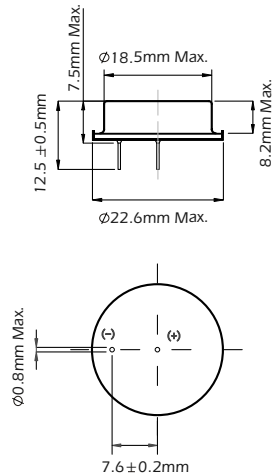

2. VOLTAGE VS. TEMPERATURE

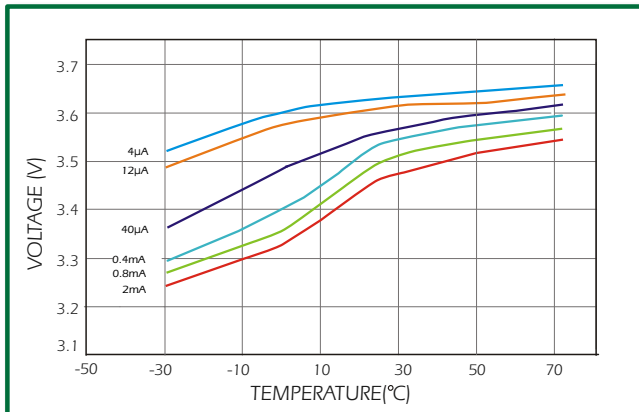

3. CAPACITY VS. CURRENT

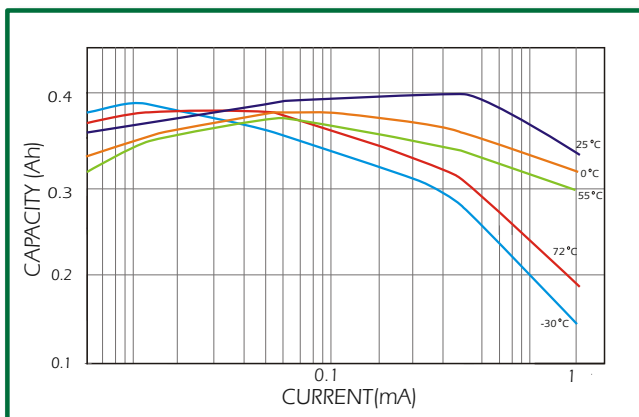

4. STORAGE CHARACTERISTICS

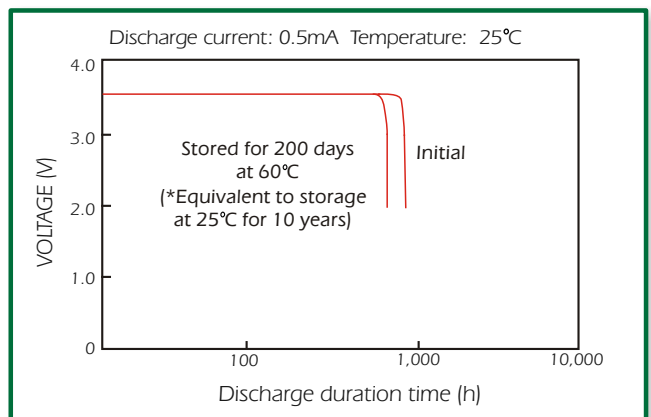

EVE ENERGY CO., LTD.

Address: EVE Industrial Park, XiKeng Industrial zone, Huihuan Town, Huizhou, Guangdong, China
 Operator: (86-752)260 6966 Direct: (86-752)261 0582
 Fax: (86-752)260 6033 PC: 516006

<http://www.evebattery.com> Email: sales@evebattery.com

Latest version can be downloaded from the EVE website