

# Ergo-tek Micro-Shear Cutters

The new Ergo-tek handles for the Ideal-tek Micro-Shears line were designed with a user centered design (UCD) philosophy. Ergo-tek Micro-Shears are designed to maximize productivity while minimizing worker repetitive motion injuries.

## New Ergo-tek Micro-Shears **features:**

- superior ergonomics
- bi-component design
- particulate free grip surface

## New Ergo-tek Micro-Shears **benefits:**

- Ergonomic handle reduces repetitive motion strain
- Anti-slip rubber outer surface for improved grip
- Perfect stiffness for increased productivity
- Easy pick up with or without gloves
- Ultimate operator comfort from UCP intelligent design
- ESD-safe material

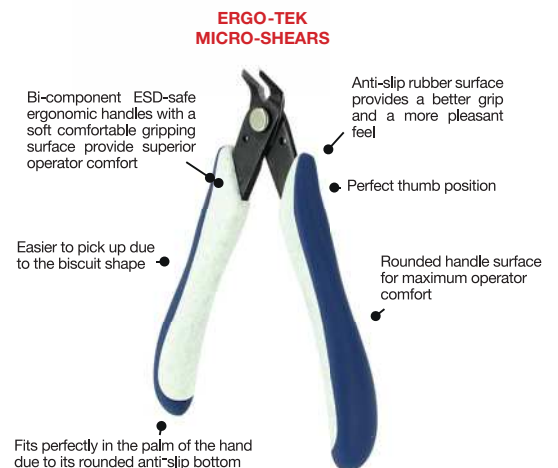

## → UCD Approach

User-Centered Design (UCD) is a design philosophy and a process in which the needs, wants, and limitations of end-users are given extensive attention at each stage of the design process.

User-centered design can be characterized as a multi-stage problem solving process that not only requires designers to analyze and foresee how users are likely to use a tool, but also to test the validity of their assumptions with regards to user behaviour in real world tests with actual users.

1. Understand User activity and environment
2. **Measure Usability**
3. Interactive design
4. Market implementation

**Micro-Shear®** Lightweight shear action tools

Micro-shears utilize a shearing cut to provide a clean and smooth cut. Anti-shock shear cutting greatly reduces mechanical shock delivered to the component and requires less effort to cut a wire as compared to compression wire cutters.

*Shear flush cutters utilize a shearing cut, with the by-pass cutting edges slicing cleanly through the metal*

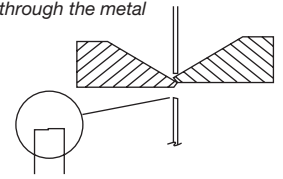

**EX9100**

Oval Head Micro-Shear® Flush Cutter - ESD safe  
 Strong and Durable. Size and shape reflect the latest advances in enhanced ergonomics.  
 Cutting edges are an ultra durable 56-58 RC.  
 Cutting capacity: 12 AWG (2.0 mm) soft wire.



**EX9200**

Tapered Head Micro-Shear® Flush Cutter - ESD safe  
 Tapered Head version of 9100AS. Improved access in high density areas and added precision.  
 Precision-ground Micro-Shear® cutting edges guarantee a clean cut.  
 Cutting capacity: 14 AWG (1.6 mm) soft wire.



**EX410**

Micro-Shear® Flush Cutter - ESD safe  
 Size and shape are optimized to work in high density areas.  
 Rockwell hardness of 55-57 RC.  
 Cutting capacity: 18 AWG (1.02 mm) soft wire.



**EX420**

Angled Micro-Shear® Flush Cutter - ESD safe  
 Slim profile for accessibility allows easier cutting in difficult areas.  
 Angled head provides excellent sight lines when used in either the vertical or horizontal position.  
 Cutting capacity: 20 AWG (0.8 mm) soft wire.



**EX2175**

Maxi-Shear™ Flush Cutter - ESD safe  
 Extremely durable and versatile wire cutter.  
 Tough enough for harnesses and cables with the precision to cut material less than 1 mm thick or work in high density areas.  
 Cutting capacity: 12 AWG (2.0 mm) soft wire.



**EX2193**

Music Wire Shear - ESD safe  
 Designed specifically for cutting music wire and other types of hardened wire.  
 Used to cut hardened and tempered steel wire up to 12 AWG.  
 Cuts music wire up to 0.040" (1.0 mm) diameter.  
 Cutting capacity: 12 AWG (2.0 mm) hard wire.



**EXLX**

Micro-Shear® Flush Cutter - ESD safe  
 Ultra slim profile for access in high density areas.  
 Extra tough high carbon steel blades.  
 Sized for smaller hands and maximum maneuverability.  
 Cutting capacity: 16 AWG (1.29 mm) soft wire.



**EX175**

Micro-Shear® Flush Cutter - ESD safe  
 Carefully crafted precision cutting blades combine seamlessly with curved, palm shaped handles to deliver effortless lead cutting.  
 Lead Catcher  
 Cutting capacity: 18 AWG (copper, nickel, etc. up to 1mm)



Scissors

**EX440**

Mini-Shear - ESD safe

Ultra precise scissor, cuts fine or delicate items with a clean, square edge.

Innovative design lessens operator hand strain.

Cutting capacity: 20 AWG (0.8 mm) soft wire.  
0.005" (0.127 mm) mylar, plastic and shielded cable.



**EX9180**

Kevlar® Fiber Shear - ESD safe

Designed and manufactured specifically for cutting the Kevlar® fiber strength component of fiber optic cables.

Serrated edge prevents the fibers from sliding out the front of the shear while cutting. Cutting edges 58-60 RC.

Cutting capacity: 12 AWG (2.0 mm) soft wire.  
030" (0.8 mm) soft sheet metal.



Jewellery Crimper

**494 - Four in One Crimper**

A bead crimping plier that precisely crimps/folds 1, 2, and 3 millimeter crimp tubes and includes a chain nose plier for handling delicate beads, micro-crimps and for adding an extra squeeze to your crimps.

The folding stations are designed to fit three different size crimp tubes (1, 2 & 3 mm) and ensure a secure and attractive result. Crimper has soft rubber hand grips and a return spring that opens the tool after each squeeze.

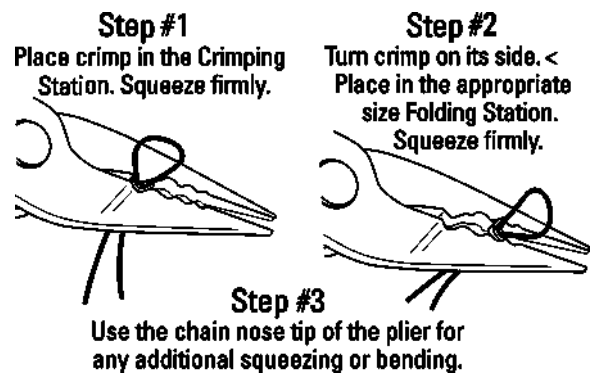
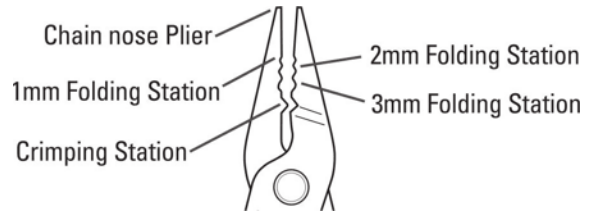

Split Ring Plier

**496**

Designed for performance and ease of use, the split ring plier's curved catch tip opens the ring and securely grasps it, simplifying installation of clasps, charms or other jewelry pieces. Low profile return spring automatically brings tool back to open position after each installation.

