

# 5000 series

## Toggle switches

OPTIONS  
● ● ●

### AGENCY APPROVALS

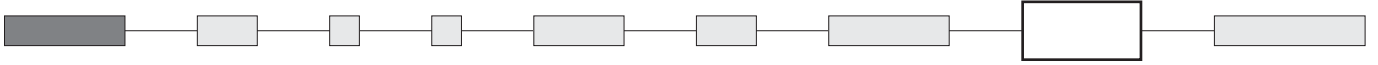

UL  
CSA  
CECC

All standard models, except 5200MIWR

Standard models 5600 - 5200

**Availability** : consult factory for details of approved combinations or options.

**Marking** : to order switches marked UL, CSA or CECC, complete above box with desired approvals, in this order & without space (ex. : ULCSACECC). Blank : no agency approval required.

**VDE (with UL & CSA)**

Refer to 55000 series on the following pages.

Preferential lists : see specifications.

### INSULATING CAPS AND PADDLES

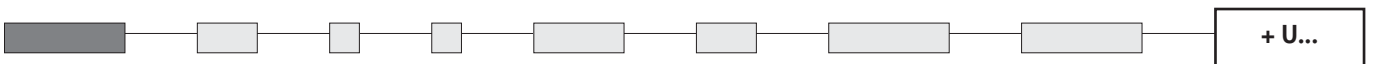

#### Insulating caps

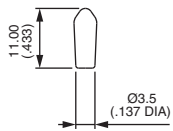

**U270**

For lever 13 and threaded bushing only

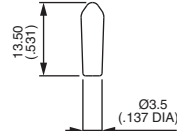

**U1040**

For lever 13 and plain bushing only

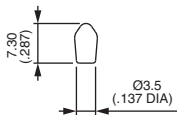

**U1710**

For lever 17 and threaded bushing  
For lever 7 and plain bushing

#### Cap colours

Replace last  
"0" by number

- |     |           |
|-----|-----------|
| 1   | blue      |
| 1/4 | dark blue |
| 2   | black     |
| 3   | green     |
| 4   | grey      |
| 5   | yellow    |
| 6   | red       |
| 7/1 | white     |
| 9   | orange    |



Insulating caps are not available in ivory colour.