

Standard Thermocouple Connector Duplex Socket



Features

- Rugged glass filled polyester bodies
- Contacts are polarised to prevent incorrect connection
- Rugged glass filled polyester bodies, suitable for industrial applications



Specification

Sensor Type	K
Connector Size	Standard
Connector Type	Duplex Socket
Colour	Yellow
Max. Temperature	220 °C
+Positive Contact	NiCr
-Negative Contact	NiAl
Standards Met	BS EN 50212:1997; RoHS

Drawing

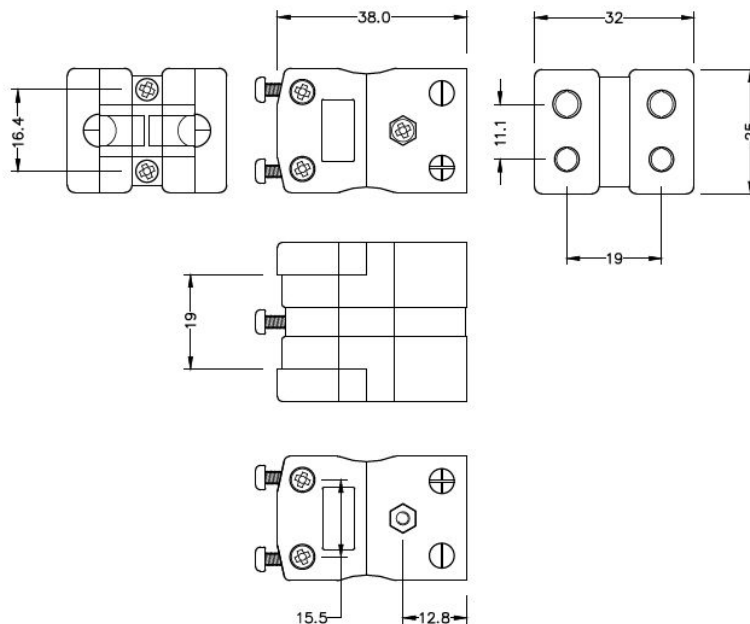

Standard Duplex in-line Socket
(dimensions in mm)

Art. Nr.
RND 410-00208