

# EAO – Your Expert Partner for Human Machine Interfaces

## 82-5562.1000 - Pushbutton 19 mm Aluminium

### 82-5562.1000 - Pushbutton 19 mm Aluminium



*Attention: The preview is based on a sample product. This can differ from your current configuration.*

#### Mounting

Mounting cut-out Ø 19 mm  
Design flush

#### Front

Front dimension Ø 22 mm  
Front shape round  
Front ring shape flush  
Front bezel material Aluminium

#### Other Attributes

Weight 0,020 kg

#### Operating-/Indication part

Lens optics opaque  
Lens material Aluminium  
Lens colour natural anodized  
Lens profile flat (raised)  
Lens illumination non-illuminative

#### IP-Rating

Front protection IP65, IP67

#### Connection Method

Terminal Screw terminal

#### Actuator

Switching action Momentary

#### Switching element

Switching current 3 A  
Contact material Silver  
Contacts 1 C  
Switching system Snap-action switching element  
Switching voltage 240 V AC/DC

#### Function

Pushbutton

# EAO – Your Expert Partner for Human Machine Interfaces

82-5562.1000 - Pushbutton 19 mm Aluminium

## Dimensions

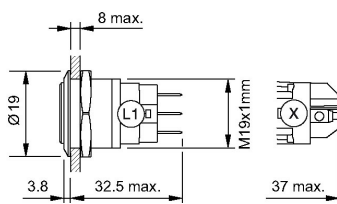

## Mounting cut-outs

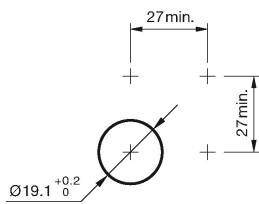

## Wiring diagram

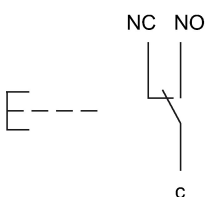

## Component layout

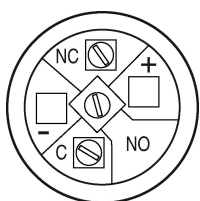

## Legend

Switching action: B = Momentary  
Contacts: C = Changeover