

Wirewound Resistors in Aluminium Housing

300 W



Aluminium housing for direct heat sink attachment
Excellent heat transfer and small dimensions
Good electrical stability, reliability and mechanical rigidity

SPECIFICATION:

Rated output	300 W
Dielectric strength	2500 V
Connection	M6 Screw Connectors
Temperature range	-25...+250 °C
Test voltage against housing	5 kV
Insulation resistance	10 GΩ

DIMENSIONS:

$L \pm 0.5$ (mm)	127
A max. (mm)	180
H (mm)	73
$PX \pm 0.3$ (mm)	52
PX1 (mm)	-
$PY \pm 0.3$ (mm)	59
$M \pm 0.5$ (mm)	6.6
B max. (mm)	20.5
C max. (mm)	45
D (mm)	5.5

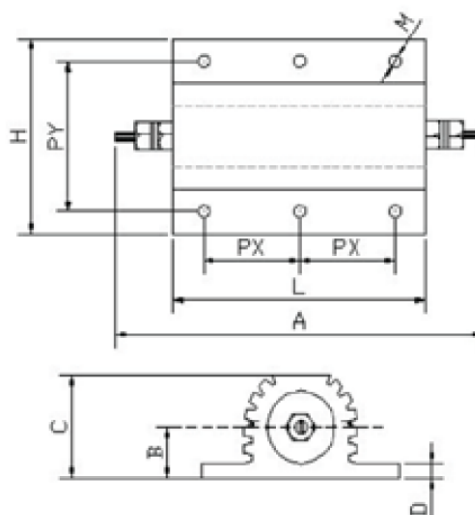

PRODUCT RANGE:

Art. Nr.	Resistance	Temperature coefficient	Tolerance
RND 155-300 1R0 F	1.0 Ω	± 60 ppm/ $^{\circ}$ C	± 1 %
RND 155-300 1R5 F	1.5 Ω	± 60 ppm/ $^{\circ}$ C	± 1 %
RND 155-300 2R2 F	2.2 Ω	± 60 ppm/ $^{\circ}$ C	± 1 %
RND 155-300 3R3 F	3.3 Ω	± 60 ppm/ $^{\circ}$ C	± 1 %
RND 155-300 4R7 F	4.7 Ω	± 60 ppm/ $^{\circ}$ C	± 1 %
RND 155-300 6R8 F	6.8 Ω	± 60 ppm/ $^{\circ}$ C	± 1 %
RND 155-300 10R F	10 Ω	± 60 ppm/ $^{\circ}$ C	± 1 %
RND 155-300 15R F	15 Ω	± 60 ppm/ $^{\circ}$ C	± 1 %
RND 155-300 22R F	22 Ω	± 60 ppm/ $^{\circ}$ C	± 1 %
RND 155-300 33R F	33 Ω	± 60 ppm/ $^{\circ}$ C	± 1 %
RND 155-300 47R F	47 Ω	± 60 ppm/ $^{\circ}$ C	± 1 %
RND 155-300 68R F	68 Ω	± 60 ppm/ $^{\circ}$ C	± 1 %
RND 155-300 100R F	100 Ω	± 30 ppm/ $^{\circ}$ C	± 1 %
RND 155-300 150R F	150 Ω	± 30 ppm/ $^{\circ}$ C	± 1 %
RND 155-300 220R F	220 Ω	± 30 ppm/ $^{\circ}$ C	± 1 %
RND 155-300 330R F	330 Ω	± 30 ppm/ $^{\circ}$ C	± 1 %
RND 155-300 470R F	470 Ω	± 30 ppm/ $^{\circ}$ C	± 1 %
RND 155-300 680R F	680 Ω	± 30 ppm/ $^{\circ}$ C	± 1 %
RND 155-300 1K0 F	1.0 k Ω	± 30 ppm/ $^{\circ}$ C	± 1 %
RND 155300 R10 J	0.1 Ω	± 60 ppm/ $^{\circ}$ C	± 5 %
RND 155300 R22 J	0.22 Ω	± 60 ppm/ $^{\circ}$ C	± 5 %
RND 155300 R47 J	0.47 Ω	± 60 ppm/ $^{\circ}$ C	± 5 %