

# PCB TERMINAL BLOCKS

## 5mm Pitch Commercial Standard Profile Screw Terminal Blocks

- 2-12 pole solid block
- End stackable
- Moulded in grey UL94-V0 flame retardant PC
- Wire protector terminals
- 0.5-4.0mm<sup>2</sup> (30-12AWG) solid cable
- 0.5-2.5mm<sup>2</sup> (30-12AWG) stranded cable
- Captive screw
- Anti solder wicking terminal
- Guided pin alignment
-  approved

CTB1500

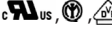

| TYPE NO.   | POLES | LENGTH |
|------------|-------|--------|
| CTB1500/2  | 2     | 10mm   |
| CTB1500/3  | 3     | 15mm   |
| CTB1500/4  | 4     | 20mm   |
| CTB1500/5  | 5     | 25mm   |
| CTB1500/6  | 6     | 30mm   |
| CTB1500/7  | 7     | 35mm   |
| CTB1500/8  | 8     | 40mm   |
| CTB1500/9  | 9     | 45mm   |
| CTB1500/10 | 10    | 50mm   |
| CTB1500/11 | 11    | 55mm   |
| CTB1500/12 | 12    | 60mm   |

### SPECIFICATION

|                           |   |
|---------------------------|---|
| Rating                    | 24A/250V<br>UL=18A/300V, VDE&IMQ=24A/250V |
| Dielectric strength       | ≥2.5kV                                    |
| Impulse withstand voltage | 4kV                                       |
| Working temperature       | 85°C                                      |
| Moulding                  | UL94-V0 flame retardant PC                |
| Pin/terminal              | Tinned, nickel plated brass               |
| Wire protector            | Tinned, plated phosphor bronze            |
| Screw/torque              | M2.5 steel zinc plated, 0.5Nm             |
| Recommended PCB hole size | ø1.3mm                                    |

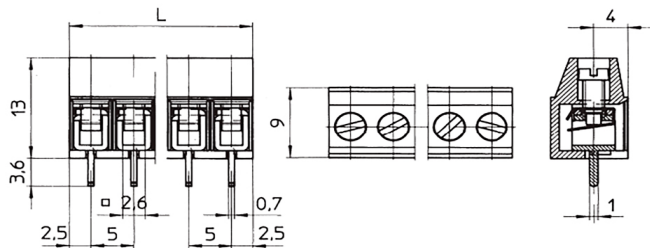

PCB  
TERMINAL  
BLOCKS

INTER-  
CONNECTION

FUSES &  
FUSE-  
HOLDERS

LEDs &  
INDICATORS

MINIATURE  
SWITCHES

LIMIT &  
SAFETY  
SWITCHES

CONTROL  
PRODUCTS

INTERFACE  
MODULES &  
SUPPORTS

RELAY  
BASES

DIN RAIL  
ENCLOSURES

BATTERIES

SOLAR  
PANELS

TRANS-  
FORMERS