

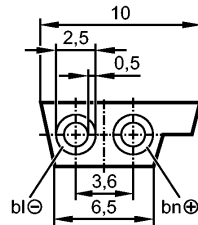

Flat cable 100 meter EPDM bk

Bus system AS-Interface



Product characteristics

AS-i flat cable

Reverse polarity protection due to special shape  
for use of insulation displacement technology

Electrical data

Electrical design		external 24 V power supply
Operating voltage [V]		24 V DC
Environment		
Ambient temperature [°C]		-40...85
Protection		IP 67
Mechanical data		
Weight [kg]		6.891
Electrical connection		
Connection		/ 100 m; 2 x 1.5 mm <sup>2</sup>
Material		EPDM; halogen-free
Sheath colour		black
Remarks		
Remarks		100 m Form supplied: coiled
Pack quantity [piece]		1