

PCB Terminal Blocks

5.0mm pitch



SPECIFICATION:

Material

Screws	M2.5 Steel, Zinc Plated
Clamp	Brass, Ni Plated
Pin Header	Brass, Tin Plated
Housing	PA66, UL94V-0

Electrical

Standard	IEC	
Rated Voltage	300V	250V
Rated Current	8A	15A
Wire Range	26-16AWG	0.14-1.5mm ²
Contact Resistance	20mΩ	
Insulation Resistance	500MΩ/DC500V	
Withstand Voltage	AC2000V/1Min	

Mechanical

Temperature Range	-40°C~+105°C
Max. Torque	0.4Nm (3.5Lb.in)
Strip Length	6-7mm

Size

Pitch	5.0mm (.197")
Poles	2P-8P

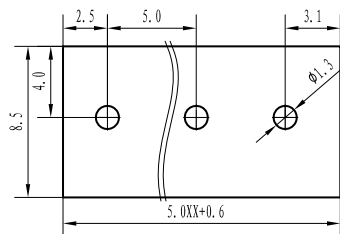

P.C.B. LAYOUT

