



LED COVER YELLOW, FOR POSITION SWITCH METAL 3SE51, HOUSING TO EN50041, 2 LEDS, YELLOW/GREEN, 230 V AC,

Product designation	cover with LEDs 230 V AC, for EN 50041 enclosures, metal, yellow
---------------------	--

**General technical data:**

Degree of pollution	class 3
Shock resistance	30g / 11 ms
Vibration resistance	0.35 mm / 5g
Protection class IP	IP66/IP67
Explosion protection category for dust	none
Explosion protection category for gas	none

**Enclosure:**

Design of the housing	block, narrow
Coating of the enclosure	cathodic immersion coating

**Drive Head:**

Design of the operating mechanism	without
-----------------------------------	---------

**Communication/ Protocol:**

Design of the interface	without
-------------------------	---------

**Ambient conditions:**

<b>Ambient temperature</b>		
• during operation	°C	-25 ... +60
• during storage	°C	-40 ... +90

**Supply voltage:**

<b>Type of voltage of the supply voltage</b>	
• of the optional LED indicator	AC

<b>Supply voltage</b> • of LED	V	230
-----------------------------------	---	-----

**Installation/ mounting/ dimensions:**

<b>mounting position</b>		any
<b>Mounting type</b>		screw fixing

**Certificates/ approvals:**

General Product Approval	Declaration of Conformity	Test Certificates
 CCC	 EAC	 EG-Konf.
 CSA	 UL	<a href="#">Special Test Certificate</a>

**other**

[Confirmation](#)

**Further information**

**Information- and Downloadcenter (Catalogs, Brochures,...)**

<http://www.siemens.com/industrial-controls/catalogs>

**Industry Mall (Online ordering system)**

<http://www.siemens.com/industrymall>

**Cax online generator**

<http://support.automation.siemens.com/WW/CAXorder/default.aspx?lang=en&mlfb=3SE51103AA001AG0>

**Service&Support (Manuals, Certificates, Characteristics, FAQs,...)**

<http://support.automation.siemens.com/WW/view/en/3SE51103AA001AG0/all>

**Image database (product images, 2D dimension drawings, 3D models, device circuit diagrams, EPLAN macros, ...)**

[http://www.automation.siemens.com/bilddb/cax\\_de.aspx?mlfb=3SE51103AA001AG0&lang=en](http://www.automation.siemens.com/bilddb/cax_de.aspx?mlfb=3SE51103AA001AG0&lang=en)

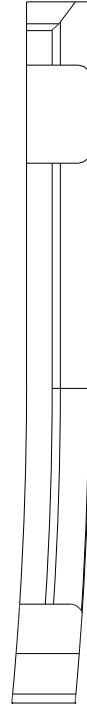
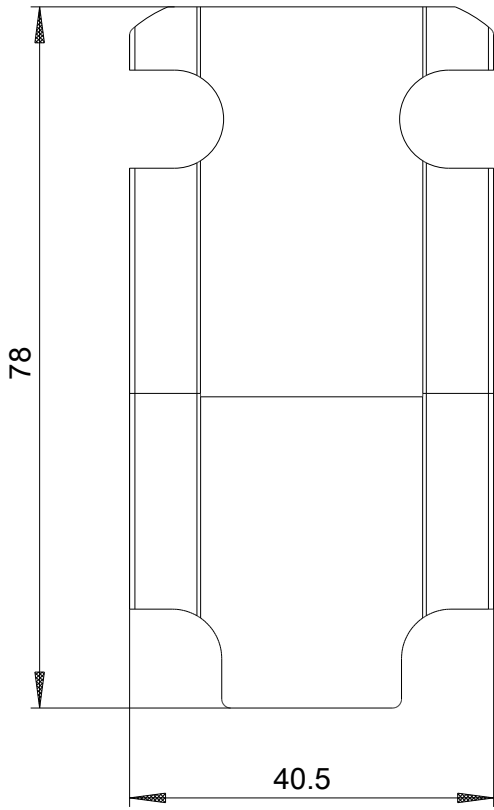

last modified:

16.03.2015