

# EAO – Your Expert Partner for Human Machine Interfaces

## 704.405.0 - Selector switch actuator 3 positions, short lever

### 704.405.0 - Selector switch actuator 3 positions, short lever

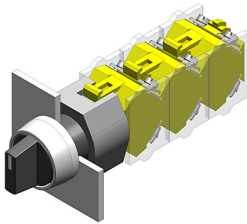

*Attention: The preview is based on a sample product. This can differ from your current configuration.*

#### Mounting

Mounting cut-out	Ø 22,3 mm
Design	raised

#### Front

Front dimension	Ø 29 mm
Front shape	round
Front bezel colour	natural anodized
Front bezel material	Aluminium

#### Other Attributes

Weight	0,037 kg
--------	----------

#### Operating-/Indication part

Lever material	Plastic
Lever colour	black
Switching angle	
Lever illumination	non-illuminative
Lever shape	short

#### IP-Rating

Front protection	IP65
------------------	------

#### Actuator

Switching action	
------------------	--

#### Switching element

Rotary positions	3
max. number of switching elements	3

#### Function

Selector switch	
-----------------	--

# EAO – Your Expert Partner for Human Machine Interfaces

## 704.405.0 - Selector switch actuator 3 positions, short lever

### Dimensions

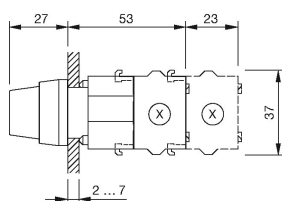

X = Screw terminal

### Mounting cut-outs

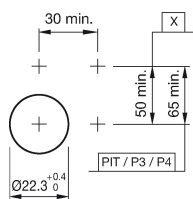

PIT = Push-in terminal

### Wiring diagram

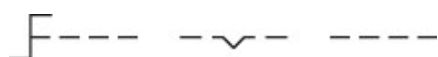

### Switching positions

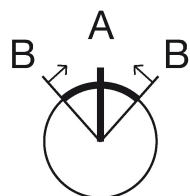

### Additional information

Max. 3 switching elements can be clipped on  
The colour of anodized aluminium parts can vary due to technical production reasons

### Legend

Switching action: A = Rest, B = Momentary