

**Mains plugs**

<b>Order code</b>	<b>Manufacturer code</b>	<b>Description</b>
23-0305	n/a	13A WHITE NYLON MAINS PLUG 3A
23-0315	n/a	13A WHITE NYLON MAINS PLUG 13A
23-0325	n/a	13A BLACK NYLON MAINS PLUG 13A

<b>Mains plugs</b>	<b>Page 1 of 2</b>
The enclosed information is believed to be correct, Information may change 'without notice' due to product improvement. Users should ensure that the product is suitable for their use. E. & O. E.	Revision A 04/07/2003

**MATERIAL SPECIFICATION**

Nylon Base and Top.  
 Brass Pins with nylon insulation.  
 Brass Terminal screws.  
 Brass plated steel cover and cord grip screws.

**NYLON 13A MAINS PLUG**

**TEST SPECIFICATION**

Each plug is 100% tested to the following:-

Earth Continuity	25A
Polarity	500V.d.c.
Insulation Resistance L-N	500V.d.c.
Electrical Strength L-N	2.4kV.50Hz
Insulation Resistance L-N-E	500V.d.c.
Electrical Strength L-N-E	2.4kV.50Hz
Safety Test	4.4kV.50Hz

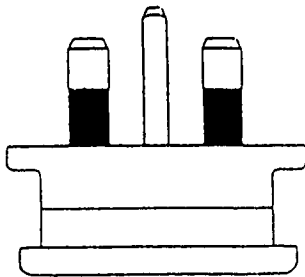

FRONT VIEW

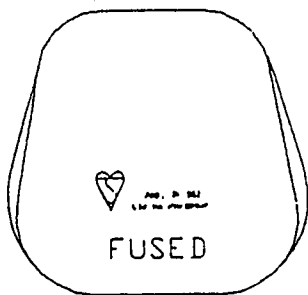

TOP VIEW

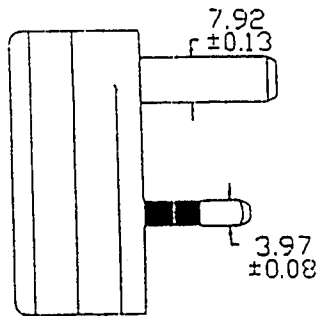

SIDE VIEW

**COVER SCREWS**

Minimum torque : 0.6Nm ( 6.1kgf/cm )  
 Maximum torque : 1.2Nm ( 12.2kgf/cm )

**CORD GRIP SCREWS**

Minimum torque : 0.4Nm ( 4.1kgf/cm )  
 Maximum torque : 0.6Nm ( 6.1kgf/cm )

**TERMINAL SCREWS**

Minimum torque : 0.4Nm ( 4.1kgf/cm )  
 Maximum torque : 0.7Nm ( 7.1kgf/cm )

**IMPORTANT NOTE**

It is essential that the shape of the blade of the screwdriver suits the head of the screw and the screw is not tightened in jerks.

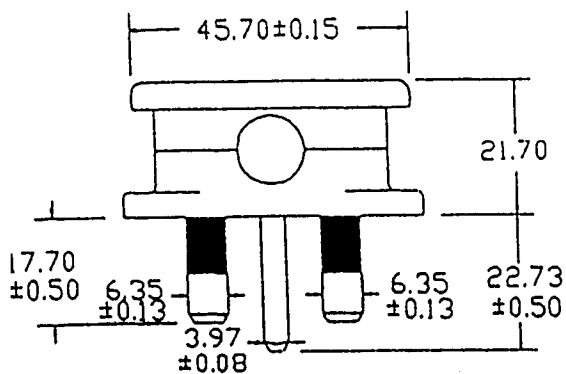

REAR VIEW