

IM5118

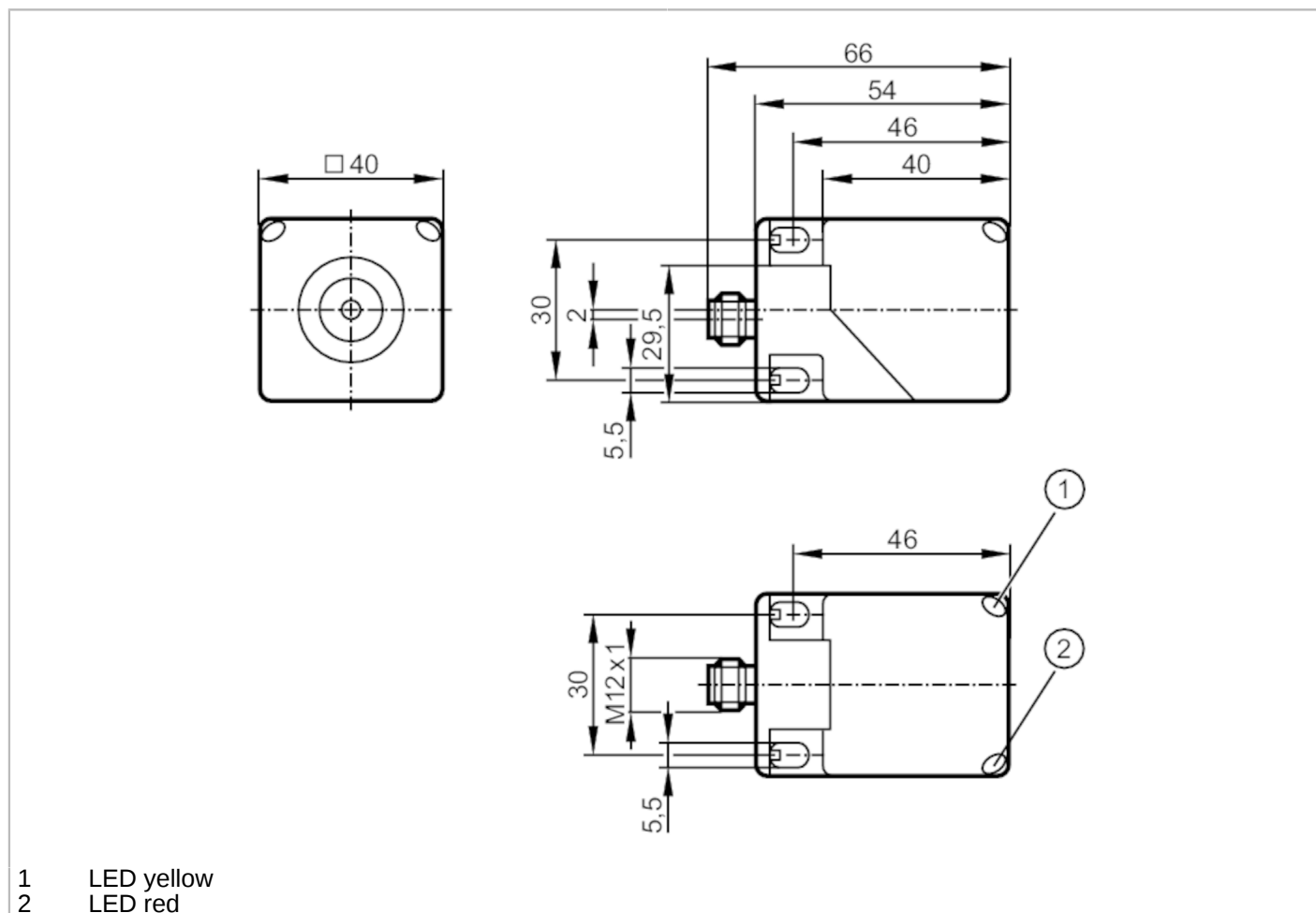

Inductive AS-Interface sensor

IMC2015-ASI /US-100-DPS



Product characteristics

Electrical design		AS-i
Sensing range	[mm]	15
Housing		rectangular
Dimensions	[mm]	40 x 40 x 54

Electrical data

Operating voltage	[V]	26.5...31.6 DC
Current consumption	[mA]	< 35
Protection class		III
Reverse polarity protection		yes

Outputs

Electrical design		AS-i
Switching frequency DC	[Hz]	100

Detection zone

Sensing range	[mm]	15
Operating distance	[mm]	0...12.1

IM5118



Inductive AS-Interface sensor

IMC2015-ASI /US-100-DPS

Accuracy / deviations					
Correction factor	steel: 1 / stainless steel: 0.7 / brass: 0.5 / aluminium: 0.5 / copper: 0.4				
Hysteresis [% of Sr]	1...20				
Switch point drift [% of Sr]	-10...10				
Operating conditions					
Ambient temperature [°C]	-25...70				
Protection	IP 67				
Tests / approvals					
EMC	EN 61000-4-2 ESD	4 kV CD / 8 kV AD			
	EN 61000-4-3 HF radiated	10 V/m			
	EN 61000-4-4 Burst	2 kV			
	EN 61000-4-6 HF conducted	10 V			
	EN 55011	class B			
MTTF [years]	958				
AS-i classification					
AS-i version	3.0				
Extended addressing mode possible	yes				
AS-i I/O configuration [hex]	0				
AS-i ID code [hex]	A.E				
AS-i certificate	71901				
Assignment of the data bits	Designation	switching signal	unsafe zone	readiness for operation	not used
	status = 0	target outside the active zone, yellow LED off	target within the uncertain zone, red LED flashes	unit faulty or distance to medium < 10 %, red LED flashes	-
	status = 1	target within the active zone, yellow LED on	target outside the uncertain zone, red LED off	readiness for operation, red LED off	default value
Mechanical data					
Weight [g]	151.5				
Housing	rectangular				
Sensing face	5 positions selectable				
Mounting	flush mountable				
Dimensions [mm]	40 x 40 x 54				
Materials	PBT; PPE				
Displays / operating elements					
Display	switching status	1 x LED, yellow			
	function	1 x LED, red			
Remarks					
Pack quantity	1 pcs.				
Electrical connection - plug					
Connector: 1 x M12; Locking: locking, rotatable					

IM5118



Inductive AS-Interface sensor

IMC2015-ASI /US-100-DPS



Connection

