

Weller®

WX
compatible



**WXP 65, WXP 80, WXP 120, WXP 200,
WXMP (MS), WXMT (MS), WXDP 120,
WXDP 120 Robust, WXDV 120**

- | | |
|---|---|
| DE Originalbetriebsanleitung | CZ Překlad původního návodu k používání |
| GB Translation of the original instructions | PL Tłumaczeniem instrukcji oryginalnej |
| ES Traducción del manual original | HU Eredeti használati utasítás fordítása |
| FR Traduction de la notice originale | SK Preklad pôvodného návodu na použitie |
| IT Traduzione delle istruzioni originali | SL Prevod izvirnih navodil |
| PT Tradução do manual original | EE Algupärase kasutusjuhendi tõlge |
| NL Vertaling van de oorspronkelijke gebruiksaanwijzing | LV Instrukciju tulkojumam no oriģinālvalodas |
| SV Översättning av bruksanvisning i original | LT Originalios instrukcijos vertimas |
| DK Oversættelse af den originale brugsanvisning | BG Превод на оригиналната инструкция |
| FI Alkuperäisten ohjeiden käännös | RO Traducere a instructiunilor originale |
| GR Μετάφραση του πρωτοτύπου των οδηγιών χρήσης | HR Prijevod originalnih uputa |
| TR Orijinal işletme talimatı çevirisi | RU Оригинальное руководство по эксплуатации |

For your safety

Thank you for the confidence you have shown in buying this device.

The device has been manufactured in accordance with the most rigorous quality standards which ensure that it operates perfectly.



Read these instructions and the accompanying safety information carefully before starting up the device and starting work with the device.

Keep these instructions in a place that is accessible to all users.

These instructions contain important information which will help you to start up, operate and service the device safely and correctly as well as to eliminate simple faults and malfunctions yourselves.

The device has been manufactured in accordance with state-of-the-art technology and acknowledged regulations concerning safety.

There is nevertheless the risk of personal injury and damage to property if you fail to observe the safety information set out in the accompanying booklet and the warnings given in these instructions.

Safety information

For safety reasons, children and youths under the age of 16, as well as persons who are not familiar with these operating instructions, may not use the device. Children should be supervised in order to ensure that they do not play with the tool.

This device is not intended for use by persons (including children) with limited physical, sensory or mental aptitude, or by persons who lack knowledge or experience in handling the device.



Warning! Electrical shock

- Carefully read the attached safety information, the safety information accompanying these operating instructions as well as the operating instructions for your control unit before putting the control unit into operation and observe the safety precautions specified therein.
- The soldering iron may only be used in combination with Weller WX Supply Units.
- Do not work on electrically live parts. Antistatic plastics are provided with conductive fillers to prevent the build-up of static charge. This also reduces the insulating properties of the plastic.
- Repairs must always be referred to a Weller-trained specialist.
- If the supply cord of this power tool is damaged, it cannot be replaced, and the power tool shall be scrapped.



Warning! Risk of burns

The soldering tip becomes hot during soldering and desoldering processes. There is a risk of burns from touching the tips. Tools may still be hot long after they have been switched off.

- Only connect the vacuum and hot air at the designated points.
- Do not direct hot air soldering tools at people or inflammable objects.
- Do not touch the hot soldering tips and keep them away from inflammable objects.



Warning! Fire and explosion hazard!

Hot tools represent a fire hazard

- Always place the soldering tool in the safety rest while not in use.
- Do not place or leave the hot soldering or desoldering tip on the worktop or on plastic surfaces.
- Avoid unintentional operation. Disconnect the soldering tool from the power supply while not in use.
- Do not direct hot air soldering tools at people or inflammable objects.
- Keep explosive and flammable objects well away from the device.
- Do not cover the device.

Specified Conditions Of Use

Use the soldering / desoldering iron exclusively for the purpose indicated in the operating instructions of releasing, accommodating and depositing electronic components under the conditions specified herein.

Intended use of the soldering station/ desoldering station also includes the requirement that you

- adhere to these instructions,
- observe all other accompanying documents,
- comply with national accident prevention guidelines applicable at the place of use.



WXDP 120 (Robust), WXDV 120

Flammable gases and liquids may not be extracted.

The device may only be used with correctly fitted and suitable filter cartridges.

Replace filter cartridges when full.

The manufacturer will not be liable for unauthorised modifications to the device.

User groups

Due to differing degrees of risk and potential hazards, several work steps may only be performed by trained experts.

Work step	User groups
Replacing electrical replacement parts	Electricians
Default maintenance intervals	Safety expert
Operation Filter change	Non-specialists
Operation Filter change Replacing electrical replacement parts	Technical trainees under the guidance and supervision of a trained expert

Soldering and desoldering

Caution!

Please be sure to read and follow the operating instructions for your Weller WX Supply Unit.



Warning!

Wear appropriate protective clothing to protect yourself against burns. Protect your eyes by wearing eye protectors.

Handling the soldering tips

- Coat the selective and tinnable soldering tip with solder when heating it up for the first time. This removes oxide coatings which have formed during storage and impurities from the soldering tip.
- Make sure that the soldering tip is well coated with solder during breaks between soldering work and prior to storage of the device.
- Do not use aggressive fluxing agents.

- Always make sure that the soldering tips are fitted properly.
- Select as low a working temperature as possible.
- Select the largest possible soldering tip shape for the application. Rule of thumb: the soldering tip should be roughly as large as the soldering pad.
- Coat the soldering tip well with solder to ensure that there is efficient heat transfer between the soldering tip and the soldering area.
- Prior to extended breaks between soldering work, switch off the soldering system or use the Weller function to reduce the temperature when the soldering equipment is not in use.
- Coat the tip with solder prior to storage if you do not intend to use the soldering iron for an extended period of time.
- Apply solder directly to the soldering area, not to the soldering tip.
- Do not apply mechanical force to the soldering tip.

Care and maintenance



Warning!

Before doing any work on the machine, pull the plug out of the socket.



Warning! Risk of burns

- Only replace solder tips when cold
- Replace and clean suction nozzles only when hot and using the suitable tool
- Only replace hot air nozzles using the suitable tool
- Only clean or replace solder collection tubes when cold

Keep the heat transfer surfaces of the soldering tip and heating element clean. The heating element must not come into contact with soldering tin.

Filter change WXDP 120 (Robust), WXDV 120

To ensure that the filtration system functions properly, the filter must be replaced as follows:

- at least once a year or
- when indicated or
- as per maintenance schedule

Contaminated filters must be treated as special waste.

Dispose of replaced equipment parts, filters or old devices in accordance with the rules and regulations applicable in your country.

Wear suitable protective gear.

Soldering iron: The soldering tool must be left switched off in the safety rest for at least 3 minutes until the soldering tip has cooled down. The LED status indicator must be at „OFF“.

Desoldering iron: Replace the suction nozzles when warm using the PDN desoldering nozzle pliers. For safety reasons, we recommend that the desoldering iron be cleaned only when cool.



Warning!

Use original replacement parts only.

Technical Data

Soldering iron	WXP 65	WXP 80	WXP 120	WXP 200	WXMP
Temperature range °C	100°C - 450°C	100°C - 450°C	100°C - 450°C	100°C - 450°C	100°C - 450°C
Temperature range °F	212°F- 850°F	212°F- 850°F	212°F- 850°F	212°F- 850°F	212°F- 850°F
Power consumption	65 W	80 W	120 W	200 W	40 W (RT11: 55 W)
Voltage	24 V / AC	24 V / AC	24 V / AC	24 V / AC	12 V / AC
Heat-up time (50°C to 350°C) (120°F to 660°F)	7 s	10 s	10 s	25 s	3 s
Tip type series	XNT	LT	XT	XHT	RT
Supply unit	WX / WXD / WXA / WXR				

Desoldering tweezers / Desoldering iron	WXMT	WXDP 120 / WXDP 120 Robust	WXDV 120
Temperature range °C	100°C - 450°C	100°C-450°C	100°C-450°C
Temperature range °F	212°F- 850°F	212°F-850°F	212°F-850°F
Power consumption	80 W (2x40 W)	120 W	120 W
Voltage	12 V / AC	24 V / AC	24 V / AC
Heat-up time (50°C to 350°C) (120°F to 660°F)	3 s	35 s	35 s
Tip type series	RTW	XDS	XDS
Supply unit	WX / WXD / WXA / WXR	WXD / WXR	

Symbols



Caution!



Read the operating instructions!



Soldering



Desoldering



Hot air



Disposal

Do not dispose of electric tools together with household waste material! In observance of European Directive 2012/19/EU on waste electrical and electronic equipment and its implementation in accordance with national law, electric tools that have reached the end of their life must be collected separately and returned to an environmentally compatible recycling facility. Dispose of replaced equipment parts, filters or old devices in accordance with the rules and regulations applicable in your country.



CE mark of conformity

Warranty

Claims by the buyer for physical defects are time-barred after a period of one year from delivery to the buyer. This does not apply to claims by the buyer for indemnification in accordance with §§ 478, 479 BGB (German Federal Law Gazette).

We shall only be liable for claims arising from a warranty furnished by us if the quality or durability warranty has been furnished by use in writing and using the term

„Warranty“.

The warranty shall be void if damage is due to improper use and if the device has been tampered with by unauthorised persons.

Subject to technical alterations and amendments.

For more information please visit www.weller-tools.com.

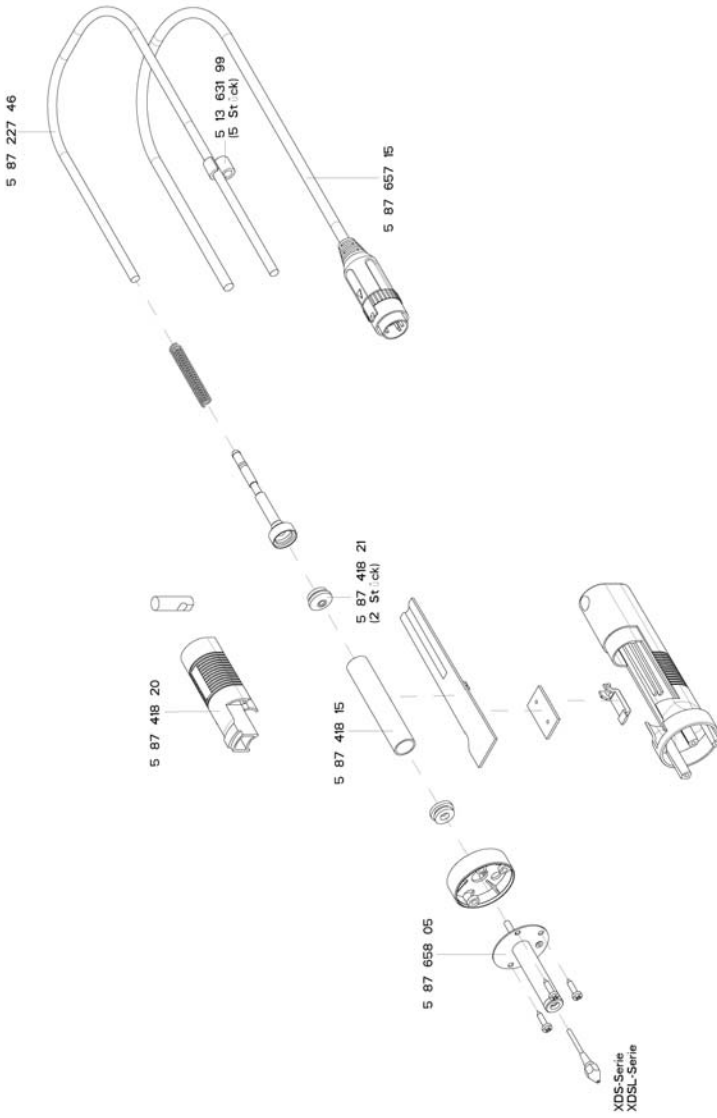

GERMANY

Weller Tools GmbH
Carl-Benz-Straße 2
74354 Besigheim

Tel: +49 (0)7143 580-0
Fax: +49 (0)7143 580-108

ITALY

Apex Tool S.r.l.
Viale Europa 80
20090 Cusago (MI)

Tel: +39 (02)9033101
Fax: +39 (02)90394231

USA

Apex Tool Group, LLC
14600 York Rd. Suite A
Sparks, MD 21152

Tel: +1 (800)688-8949
Fax: +1 (800)234-0472

GREAT BRITAIN

Apex Tool Group (UK Operations) Ltd
4th Floor Pennine House
Washington, Tyne & Wear
NE37 1LY

Tel: +44 (0) 191 419 7700
Fax: +44 (0) 191 417 9421

SWITZERLAND

Apex Tool Switzerland Sàrl
Crêt-St-Tombet 15
2022 Bevaix

Tel: +41 (0) 24 426 12 06
Fax: +41 (0) 24 425 09 77

CANADA

Apex Tools – Canada
5925 McLaughlin Rd.
Mississauga, Ontario L5R 1B8

Tel. +1 (905) 501-4785
Fax. +1 (905) 387-2640

FRANCE

Apex Tool Group S.N.C.
25 Avenue Maurice Chevalier B.P. 46
77832 Ozoir-la-Ferrière Cedex

Tel: +33 (0)1.64.43.22.00
Fax: +33 (0)1.64.43.21.62

CHINA

Apex Tool Group
A-8 building
No. 38 Dongsheng Road
Heqing Industrial Park, Pudong
Shanghai 201201

Tel: +86 (21)60880288
Fax: +86 (21)60880289

AUSTRALIA

Apex Tools
P.O. Box 366
519 Nuringong Street
Albury, N.S.W. 2640
Australia

Tel: +61 (2)6058-0300
Fax: +61 (2)6021-7403