

Notes:

1. Electrical Characteristics:

- 1.1 Contact resistance: 20mΩ Max.
- 1.2 Dielectric withstanding voltage: 500V AC for 1 minute
- 1.3 Insulation resistance: 1000MΩ Min.

2. Enviroment characteristics:

- 2.1 Operating temperature: 0°C to +85°C
- 2.2 Storage temperature: -20°C to +70°C

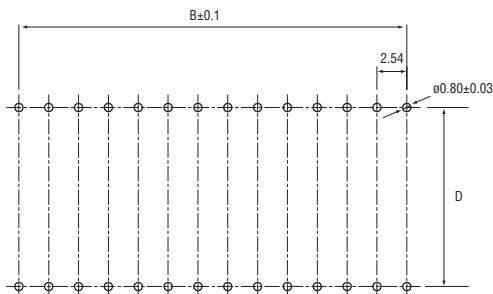
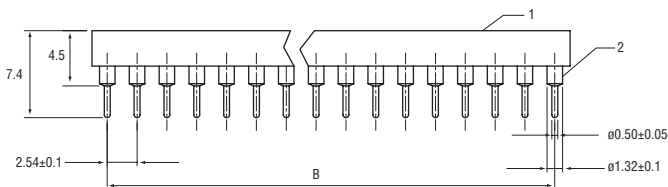
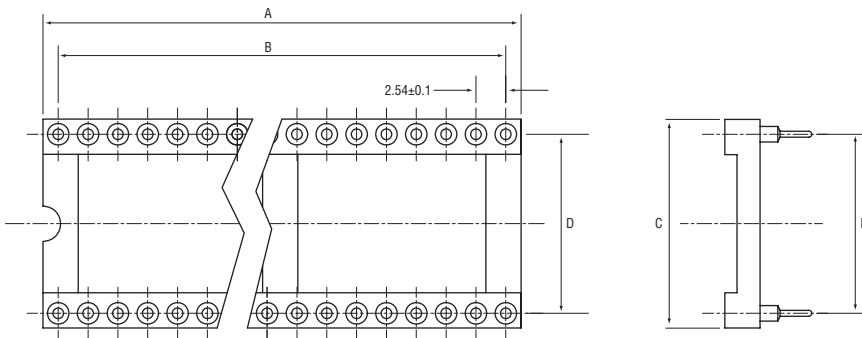

Recommend PCB Layout (Tolerance=±0.05)

Part No.	Pins	Dimensions			
		A±0.5	B±0.3	C	D±0.2
22-1757	08	10.16	7.62	10.16	7.62
22-1758	14	17.78	15.24	10.16	7.62
22-1759	16	20.32	17.78	10.16	7.63
22-1760	18	22.86	20.32	10.16	7.62
22-1761	20	25.40	22.86	10.16	7.62
22-1762	24	30.48	27.94	10.16	7.62
22-1763	28	35.56	33.02	10.16	7.62
22-1764	24	30.48	27.94	17.78	15.24
22-1765	28	35.56	33.02	17.78	15.24
22-1766	32	40.64	38.10	17.78	15.24
22-1767	40	50.80	48.26	17.78	15.24

Item	Part Name	Materials	Finished
1	Housing	Thermoplastic	UL 94 V - 0
2	Contact	Copper alloy	Gold plated