

OG5128

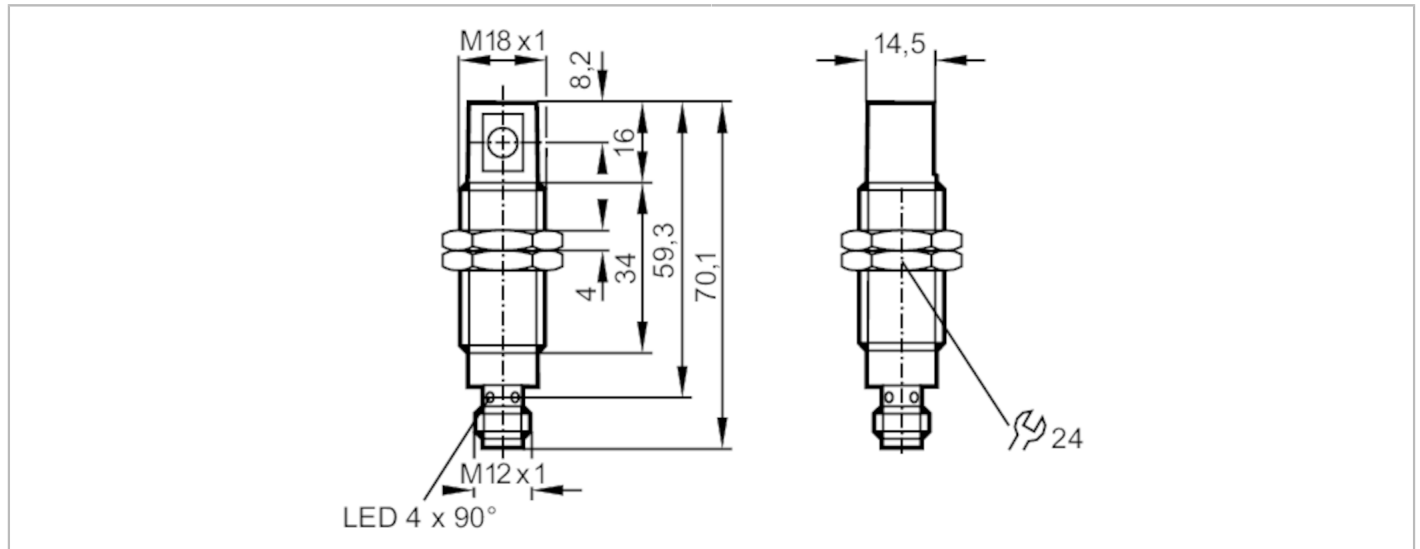

Through-beam sensor receiver

OGE-DPKG/US/90°



Product characteristics

Type of light	red light
Housing	threaded type
Dimensions [mm]	M18 x 1 / L = 59.3

Application

Function principle	Through-beam sensor
--------------------	---------------------

Electrical data

Operating voltage [V]	10...30 DC; ("supply class 2" to cULus)
Current consumption [mA]	< 12
Protection class	II
Reverse polarity protection	yes
Type of light	red light
Wave length [nm]	660

Outputs

Electrical design	PNP
Output function	dark-on mode
Max. voltage drop switching output DC [V]	2.5
Permanent current rating of switching output DC [mA]	200
Switching frequency DC [Hz]	500
Short-circuit protection	yes
Type of short-circuit protection	pulsed
Overload protection	yes

Detection zone

Transmitter / receiver	receiver
Range [m]	< 9
Range adjustable	no

OG5128



Through-beam sensor receiver

OGE-DPKG/US/90°

Operating conditions		
Ambient temperature	[°C]	-25...60
Protection		IP 68
Tests / approvals		
EMC		EN 60947-5-2
		EN 55011
		class B
MTTF	[years]	953
Mechanical data		
Weight	[g]	58.4
Housing		threaded type
Dimensions	[mm]	M18 x 1 / L = 59.3
Thread designation		M18 x 1
Materials		stainless steel; ABS
Lens material		PMMA
Displays / operating elements		
Display	switching status	1 x LED, yellow
	operation	1 x LED, green
Accessories		
Accessories (supplied)		Nuts: 2 x lock washers: 2 x
Remarks		
Pack quantity		1 pcs.
Electrical connection		
Connector: 1 x M12		
		

OG5128



Through-beam sensor receiver

OGE-DPKG/US/90°

Connection

