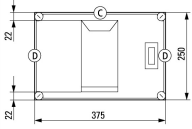

Ci43 individual enclosure; including one NH00 disconnecter

Part no. XNH00-CI43E
Catalog No. 184457

Delivery program

Dimensions		mm	
Product range			Ci insulated enclosures
Basic function			Enclosures with devices fitted
Product function			Individual enclosures with NH fuse switch-disconnectors
Single unit/Complete unit			Stand-alone device
Degree of Protection			IP65
Description			Metric cable entry knockouts in all sides Integrated pressure-relief mechanism for short-circuits Fuse switch-disconnector fitted to steel mounting plate Fixing straps for wall fixing Sealable cover fasteners
Type cover			Transparent
Information about equipment supplied			Terminal for connecting the 4th conductor (PEN)
Width		mm	375
Height		mm	250
Depth		mm	150
Rated operational current	I_e	A	160
Rated operational voltage	U_e	V AC	690
Fuse cartridge		Size	NH00
5 th conductor can be retrofitted			K95/1N/BR

Notes

C

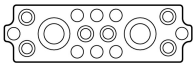

2 x M50/20

6 x M25/16

8 x M20

D

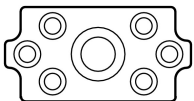

1 x M50/32

6 x M25/16

Additional product information (links)

AWA32-567 Ci insulated enclosure

AWA32-567 Ci insulated enclosure ftp://ftp.moeller.net/DOCUMENTATION/AWA_INSTRUCTIONS/05670392.pdf

IL0131109ZU Fuse switch-disconnector XNH

IL0131109ZU Fuse switch-disconnector XNH ftp://ftp.moeller.net/DOCUMENTATION/AWA_INSTRUCTIONS/IL0131109ZU2015_11.pdf

Manufacturer's Declaration CI-RoHS ftp://ftp.moeller.net/DOCUMENTATION/PDF/2013-01-31_Ci_RoHS.pdf

Declaration of conformity ftp://ftp.moeller.net/DOCUMENTATION/PDF/ci_ce.pdf