

SMT-Mini-Taster liegend, 3,3x3,3mm, Bauhöhe 1,5mm SMT Mini Tactile Switches horizontal, 3.3x3.3mm, 1.5mm Profile

Technische Daten / Technical Data

Gehäuse/Abdeckung/Hebel	Thermoplast/Stahl/Thermoplast, UL-94 HB
Case/Cover/Actuator	Thermoplastic/Steel/Thermoplastic, UL-94 HB
Kontaktmaterial	Messing
Contact Material	Brass
Kontaktbelastbarkeit	50mA, 12V _{DC}
Contact Rating	50mA, 12V _{DC}
Kontaktoberfläche	Versilbert
Contact Surface	Silver plated
Oberfläche Lötanschluss	Versilbert
Plating Solder Side	Silver plated
Lötbarkeit	IEC 60512-12A
Solderability	IEC 60512-12A
Durchgangswiderstand	< 100mΩ im Auslieferungszustand
Contact Resistance	< 100mΩ at initial state
Isolationswiderstand	> 100MΩ im Auslieferungszustand
Insulation Resistance	> 100MΩ at initial state
Spannungsfestigkeit	250V _{AC}
Test Voltage	250V _{AC}
Temperaturbereich	-20°C ... +70°C
Temperature Range	-20°C ... +70°C
Mechanische Lebensdauer	min. 100 000 Schaltvorgänge (160g)
Mechanical Life	min. 50 000 Schaltvorgänge (250g)
	min. 100 000 operations (160g)
	min. 50 000 operations (250g)
Verarbeitung	260°C max. für 5s
Processing	260°C max. for 5s

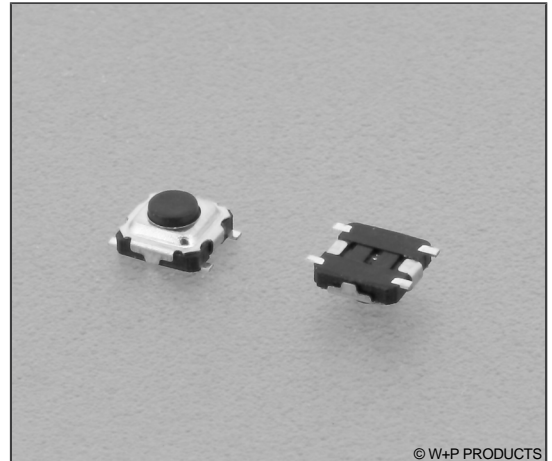

© W+P PRODUCTS

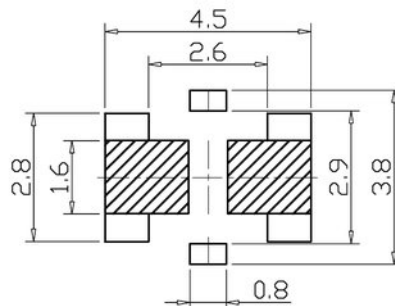
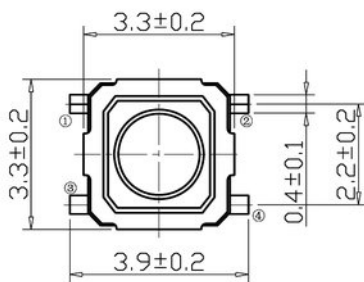

P. C. B. Layout

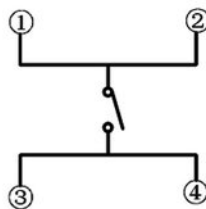
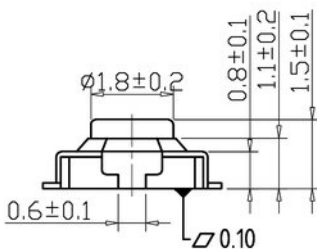

Series

516

516 Zweifachkontakte
Double contacts

Height

1

1 H=1.50mm

Force*

40

30 160g±30
40 250g±50

Packaging

TR

TR

* Dies ist ein **Bestellbeispiel** - bitte durch Ihre Spezifikationen ersetzen.
* This is an **order example** - please replace by your specifications.

Lieferformen / Packaging Options:
TR Tape & Reel (Option) / Tape & Reel (Option)