

**2755 / 2755B / GH275
GH435 / GH755
GH810 (-6 to -10)**

**Nipples without
wire trap**

**Nippel ohne
Ausreiß-
sicherung**

**Nipples sans
gorge pour
nappes**

**Nipples senza
protezione da
strappo**

**Manguitos
roscados sin
seguro de
arranque**

2755(B) / GH275 / GH435 / GH810 (-6 to -10)

GH755

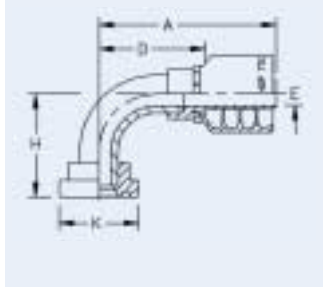
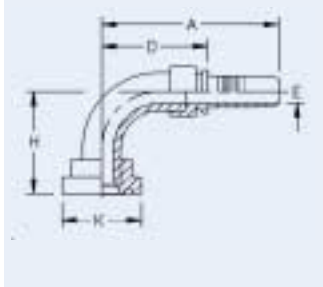

FLB (3000 psi)

**SAE Flange Code 61, 90° Elbow
Flansch-Code 61, 90° Krümmer
Bride code 61, coude 90°
Flangia codice 61 a 90°
Brida-código 61 acodado a 90°**

Part Number Skive Steel	Part Number Skive Stainless Steel	Part Number TTC Steel	Part Number TTC Stainless Steel	Thread T	Flange	Tube O.D. mm	Hose ND	Hose Size	A mm	D mm	H mm	E mm	K Ø mm	HEX [1]	HEX [2]
GC8727-8*		1T8FLB8**			1/2"		12	-8	83,5	50,0	47,0	9,0	30,2		
GC8727-12-10*		1T12FLB10**			3/4"		16	-10	93,3	56,7	53,8	12,0	38,1		
GC8727-12*		1T12FLB12**			3/4"		19	-12	84,5	47,5	45,0	15,0	38,1		
GC8727-16-12*		1T16FLB12**			1"		19	-12	110,0	73,0	68,0	15,0	44,4		
GC8727-16*	GC8727-16BA*	1T16FLB16**			1"		25	-16	118,5	78,0	73,0	20,0	44,4		
GC8727-20-16*		1T20FLB16**			1 1/4"		25	-16	118,5	78,0	73,5	20,0	50,8		

2755(B) / GH275 / GH435 / GH810 (-6 to -10)

GH755

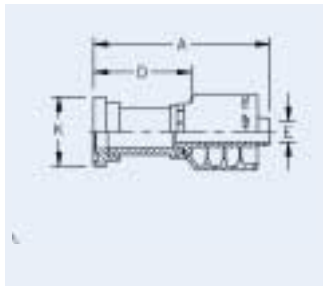
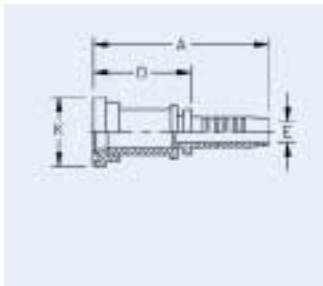

FH (6000 psi)

**SAE Flange Code 62
Flansch-Code 62
Bride code 62
Flangia codice 62
Brida-código 62**

Part Number Skive Steel	Part Number Skive Stainless Steel	Part Number TTC Steel	Part Number TTC Stainless Steel	Thread T	Flange	Tube O.D. mm	Hose ND	Hose Size	A mm	D mm	H mm	E mm	K Ø mm	HEX [1]	HEX [2]
GC8853-8*		1T8FH8**			1/2"		12	-8	80,7	47,7		9,0	31,8		
GC8853-12-8*		1T12FH8**			3/4"		12	-8	84,5	51,5		9,0	41,3		
GC8853-8-10* ¹		1T8FH10**			1/2"		16	-10	87,2	50,6		12,0	31,8		
GC8853-12-10*	GC8853-12-10BA*	1T12FH10**			3/4"		16	-10	90,5	53,9		12,0	41,3		
GC8853-12*		1T12FH12**			3/4"		19	-12	88,5	51,5		15,0	41,3		
GC8853-16-12*		1T16FH12**			1"		19	-12	91,5	54,5		15,0	47,6		
GC8853-12-16* ¹		1T12FH16**			3/4"		25	-16	110,0	69,5		20,0	41,3		
GC8853-16*		1T16FH16**			1"		25	-16	114,5	74,0		20,0	47,6		
GC8853-20-16*		1T20FH16**			1 1/4"		25	-16	119,5	79,0		20,0	54,0		

¹ Assembly with full flange is not possible, use split flanges.

¹ Zusammenbau mit Vollflansch ist nicht möglich, benutze Halbflansche.

¹ Embouts où la pleine-bride n'est pas possible, à assembler avec demi bride.

¹ L'assemblaggio con la flangia completa non è possibile, usare la semi-flangia.

¹ No es posible el Montaje con bridas enteras, utilizar medias bridas.

* Sockets must be ordered separately.

* Fassungen müssen separat bestellt werden.

* Les jupes doivent être commandées sép.

* Le boccole devono essere ordinate sep.

* Los manguitos tienen que pedirse por separado.

** Part numbers include sockets.

** Teil-Nr. beinhaltet Fassung.

** L'embout-Nr. avec la jupe.

** Part Number include la boccola.

** Los números de parte incluyen los manguitos.