

- 1
- 2
- 3
- 4
- 5
- 6
- 7
- 8
- 9
- 10
- 11
- 12
- 13
- 14
- 15
- 16
- 17
- 18
-

MATERIAL

Aluminium, epoxy resin coating, RAL 9005 black colour, matte finish.
AISI 304 stainless steel screws and nuts.

STANDARD EXECUTIONS

- **GN 146.1-B**: without sliding bushing.
- **GN 146.1-G**: with a polyamide based (PA) or polytetrafluoroethylene based (PTFE) technopolymer sliding bushing.

FEATURES AND APPLICATIONS

GN 146.1 connecting clamps can normally be matched with the linear actuators.

By clamping the guide hole d_1 it is possible to adjust the actuator positioning and to lock the slider after having set up the final position.
The clamping screws d_3 may be replaced by clamping kits GN 911 (see page 1782).

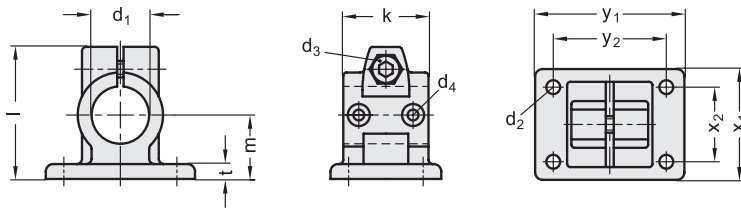
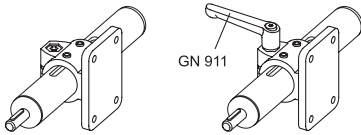

Code	Description	d1#	d1##	d2	d3	d4	k	l	m	t	x1	x2	y1	y2	d3 Clamping kit	
GN.46406	GN 146.1-B30-2-SW	30	-	6.5	M8	M4	40	62	30	7	52	35	70	53	GN 911-M8-32	155
GN.46416	GN 146.1-B40-2-SW	40	-	8.5	M10	M5	56	83	42	10	78	52	108	82	GN 911-M10-40	430
GN.46426	GN 146.1-B50-2-SW	50	-	11	M10	M6	65	95	50	14	92	62	128	98	GN 911-M10-55	675
GN.46436	GN 146.1-B60-2-SW	60	-	11	M10	M8	80	112	60	14	110	74	154	118	GN 911-M10-55	1130
GN.46446	GN 146.1-G30-2-SW	-	30	6.5	M8	M4	40	62	30	7	52	35	70	53	GN 911-M8-32	140
GN.46456	GN 146.1-G40-2-SW	-	40	8.5	M10	M5	56	83	42	10	78	52	108	82	GN 911-M10-40	400
GN.46466	GN 146.1-G50-2-SW	-	50	11	M10	M6	65	95	50	14	92	62	128	98	GN 911-M10-55	625
GN.46476	GN 146.1-G60-2-SW	-	60	11	M10	M8	80	112	60	14	110	74	154	118	GN 911-M10-55	1130

Hole without sliding bushing.
Hole with sliding bushing.