

# EAO – Your Expert Partner for Human Machine Interfaces

## 45-2819.1C90.003 - Selector switch actuator 3 positions, short lever

### 45-2819.1C90.003 - Selector switch actuator 3 positions, short lever



*Attention: The preview is based on a sample product. This can differ from your current configuration.*

#### Mounting

Mounting cut-out Design Ø 22.5 mm raised

#### Front

Front shape round  
Front dimension Ø 29.45 mm  
Front ring material Plastic  
Front ring colour black

#### Other Attributes

Weight 0.022 kg

#### Operating-/Indication part

Lever material Plastic  
Lever colour white  
Switching angle C = 45°

#### IP-Rating

Front protection IP66, IP67, IP69K

#### Actuator

Switching action Maintained - Rest - Maintained  
Housing material Plastic

#### Switching element

Rotary positions 3  
max. number of switching elements 6

#### Function

Selector switch

# EAO – Your Expert Partner for Human Machine Interfaces

45-2819.1C90.003 - Selector switch actuator 3 positions, short lever

## Dimensions

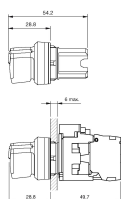

## Mounting cut-outs

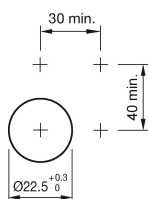

## Wiring diagram

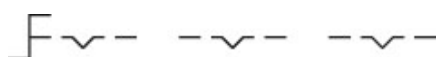

## Switching positions

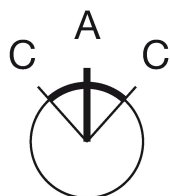

## Additional information

External diameter of the short lever 32.3 mm

## Legend

Switching action: A = Rest, B = Momentary