

E43301

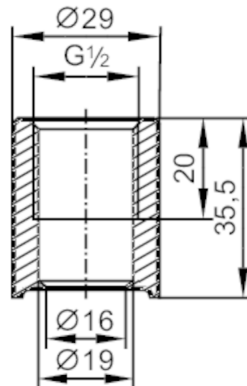

Welding adapter for process sensors

ADAPT G1/2-WELDING FOR PIPE



EC 1935/2004 EHEDG Certified **FCM** 

Application

Design	for pipes
Pressure rating [bar]	50
Note on pressure rating	for the connection sensor - adapter

Mechanical data

Weight [g]	173.5
Materials	stainless steel (1.4435 / 316L)
Sensor connection	G 1/2
Process connection	welding adapter D29
Surface characteristics Ra/Rz of the wetted parts	0.4 / 4

Accessories

Accessories (supplied)	O-rings:, FKM
------------------------	---------------

Remarks

Pack quantity	1 pcs.
---------------	--------