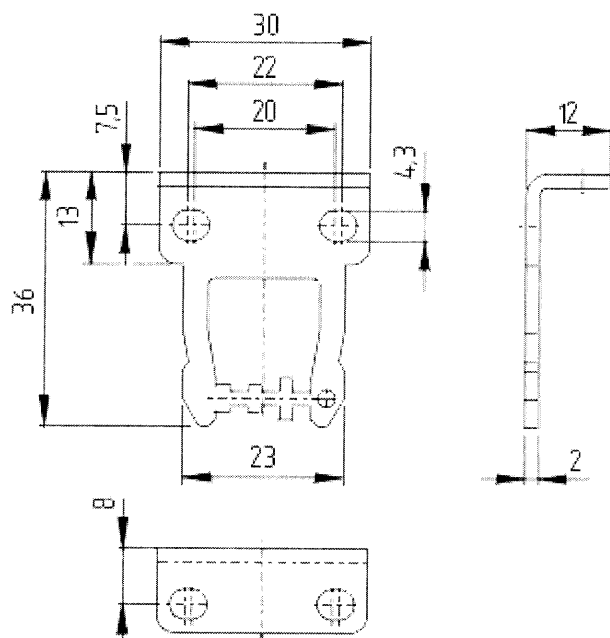

SCHMERSAL**Safety switch with separate actuator / Class 2
Actuator****Coded angled actuator B5**

418 6291

**Features:**

- Particularly suitable for hinged guards (front mounting)
- On hinged guards, minimum actuating radius at 90° to the plane of the actuator 140 mm
- Minimum actuating radius in line with the plane of the actuator 200 mm