



Product Change Notification (PCN)

PCN Number	510328	Date Issued	July 09, 2021
Reason for Change	Capacity change or tool replacement		
Change Type Description	This letter is to inform you that another set of tooling is being added to meet the current and future demands of this product. There will be no changes in the fit, form or function from the additional tooling when compared to the current tooling.		
Reason for Short Notice	New Capacity		
Assessment of Change	Product will be fully qualified before it is shipped. Qualification reports will be available after below listed date		
Internal Molex Qualification Date	September 29, 2021		
Sample Availability Date (Changed Part)	September 29, 2021		
Planned Implementation Date	October 15, 2021		
Method of Identifying Change	Product made after planned implementation date can contain the change		

RELEASED

Before Change

- 5559 Series

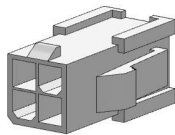

After Change

Overview

- To ensure business continuity, another set of tooling is being added
 - New tooling will be an exact replica of current tooling
 - Tooling being added to keep up with current and future demand
- There is NO impact to Fit, Form or Function
- Samples available upon request after date shown above
- Part Numbers Impacted
 - See attached list



Product Change Notification (PCN)

You may address any technical inquiries regarding this PCN by sending E-mail to pcn_coordinator@molex.com or your Local Sales Engineer.

Note: While responding, please retain "**PCN Notification:510328**" in the e-mail Subject line for faster response.

RELEASED

Molex, LLC
2222 Wellington Court
Lisle, IL 60532
TEL: 630-969-4747
www.molex.com

PCN #	Customer #	Customer Name	Search Term	Molex Part #	Customer Material #	City
510328	103679	TTI; Inc.	TTI INC	39014036	MLX39-01-4036	Maisach-Gernlinden
510328	103679	TTI; Inc.	TTI INC	39014037	MLX39-01-4037	Maisach-Gernlinden
510328	103679	TTI; Inc.	TTI INC	1726460313	MLX172646-0313	Maisach-Gernlinden
510328	103989	TTI INCORPORATED	TTI INC	39014036	MOL39-01-4036	FORT WORTH
510328	103989	TTI INCORPORATED	TTI INC	39014037	MOL39-01-4037	FORT WORTH
510328	CCC-10770	TTI	TTI	39014036		Lisle
510328	CCC-10770	TTI	TTI	39014037		Lisle
510328	CCC-10770	TTI	TTI	1726460313		Lisle