



Figure similar

**Model**

<b>Design of the surface</b>		untreated
------------------------------	--	-----------

**Suitability**

Suitability for use / for outside use		No
---------------------------------------	--	----

**Appearance**

<b>Color</b>		pebble grey
--------------	--	-------------

**Mechanical Design**

<b>Depth</b>	mm	800
--------------	----	-----

<b>Material</b>		steel
-----------------	--	-------

<b>General Product Approval</b>	<b>EMC</b>	<b>Declaration of Conformity</b>	<b>Test Certificates</b>	<b>other</b>
---------------------------------	------------	----------------------------------	--------------------------	--------------



[other](#)



[Special Test Certificate](#)

[other](#)

**Further information**

**Information- and Downloadcenter (Catalogs, Brochures,...)**  
<http://www.siemens.com/lowvoltage/catalogs>

**Industry Mall (Online ordering system)**  
<https://eb.automation.siemens.com/mall/en/WW/Catalog/Product/8MF10082VB>

**Service&Support (Manuals, Certificates, Characteristics, FAQs,...)**  
<http://support.automation.siemens.com/WW/view/en/8MF10082VB/all>

**Image database (product images, 2D dimension drawings, 3D models, device circuit diagrams, ...)**  
[http://www.automation.siemens.com/bilddb/cax\\_en.aspx?mlfb=8MF10082VB](http://www.automation.siemens.com/bilddb/cax_en.aspx?mlfb=8MF10082VB)

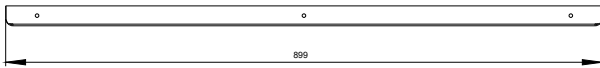

**last modified:**

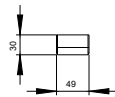

**16.03.2015**