

KS2-12L/A

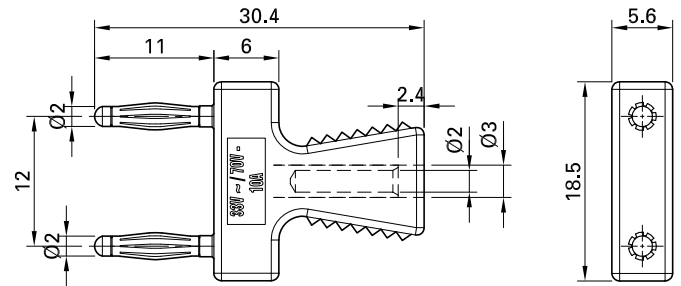
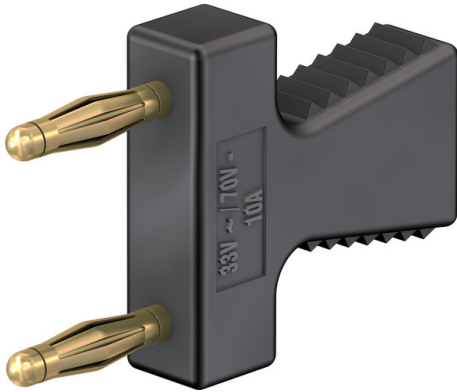

Item number 63.9354-*

Insulated, Ø 2 mm, with rigid Ø 2 mm socket in handling part.

Technical data	
Diameter of plug system	2 mm
Rated Values	30 VAC, 10 A / 60 VDC, 10 A
Surface treatment electrical contact	Au
Base material electrical contact	CuZn
Colours *	21 22 23 24 25
Plug spacing	12 mm
Suitable for	BL2-12/20/A
Test accessory acc. to	IEC EN 61010-031
Remarks	Other colors available on request.