



Model Number

NEB22-30GM60-E2-V1

Features

- 22 mm quasi-embeddable
- Increased operating distance

Connection

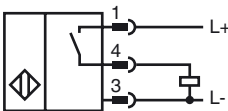

Pinout

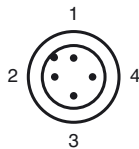

Wire colors in accordance with EN 60947-5-2

1	BN	(brown)
2	WH	(white)
3	BU	(blue)
4	BK	(black)

Accessories

BF 30

Mounting flange, 30 mm

V1-G

4-pin, M12 female field-attachable connector

V1-W

4-pin, M12 female field-attachable connector

V1-G-2M-PUR

Cable socket, M12, 4-pin, PUR cable

V1-W-2M-PUR

Cable socket, M12, 4-pin, PUR cable

Dimensions

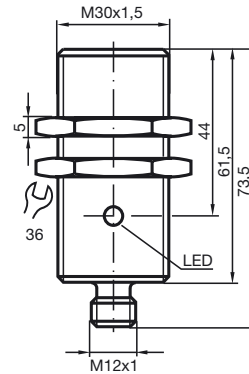

Technical Data

General specifications

Switching element function	PNP	NO
Rated operating distance	s_n	22 mm
Installation	quasi embedd.	
Output polarity	DC	
Assured operating distance	s_a	0 ... 17.8 mm
Reduction factor r_{Al}	0.25	
Reduction factor r_{Cu}	0.22	
Reduction factor r_{304}	0.65	

Nominal ratings

Installation conditions

A	6 mm
B	37 mm
C	66 mm
F	80 mm

Operating voltage	U_B	10 ... 30 V
Switching frequency	f	0 ... 150 Hz
Hysteresis	H	≤ 10 %
Reverse polarity protected	reverse polarity protected	
Short-circuit protection	pulsing	
Voltage drop	U_d	≤ 5 V
Operating current	I_L	0 ... 200 mA
Off-state current	I_r	≤ 0.1 mA
No-load supply current	I_0	≤ 10 mA
Indication of the switching state	LED, yellow	

Functional safety related parameters

MTTF _d	213 a
Mission Time (T_M)	20 a
Diagnostic Coverage (DC)	0 %

Ambient conditions

Ambient temperature	-25 ... 70 °C (-13 ... 158 °F)
---------------------	--------------------------------

Mechanical specifications

Connection type	Device connector M12 x 1 , 4-pin
Housing material	chromium plated brass
Sensing face	PBT
Protection degree	IP67

Compliance with standards and directives

Standard conformity	
Standards	EN 60947-5-2:2007 IEC 60947-5-2:2007 Non-standard connector assignment

Approvals and certificates

UL approval	cULus Listed, General Purpose
CSA approval	cCSAus Listed, General Purpose
CCC approval	Products with a maximum operating voltage of ≤36 V do not bear a CCC marking because they do not require approval.

Installation conditions

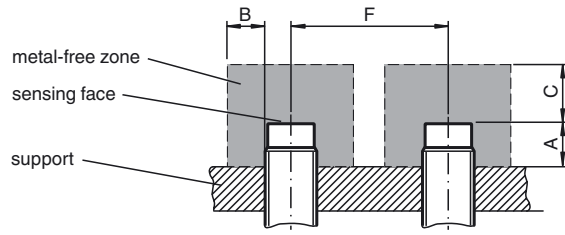

Release date: 2011-07-14 10:58 Date of issue: 2012-02-03 023490_eng.xml