

| | | | | | | | |
|-----|-------------------------|------|------|-----|-------------------------|------|------|
| No. | Changes and/or Note No. | Date | Sign | No. | Changes and/or Note No. | Date | Sign |
| | | | | | | | |

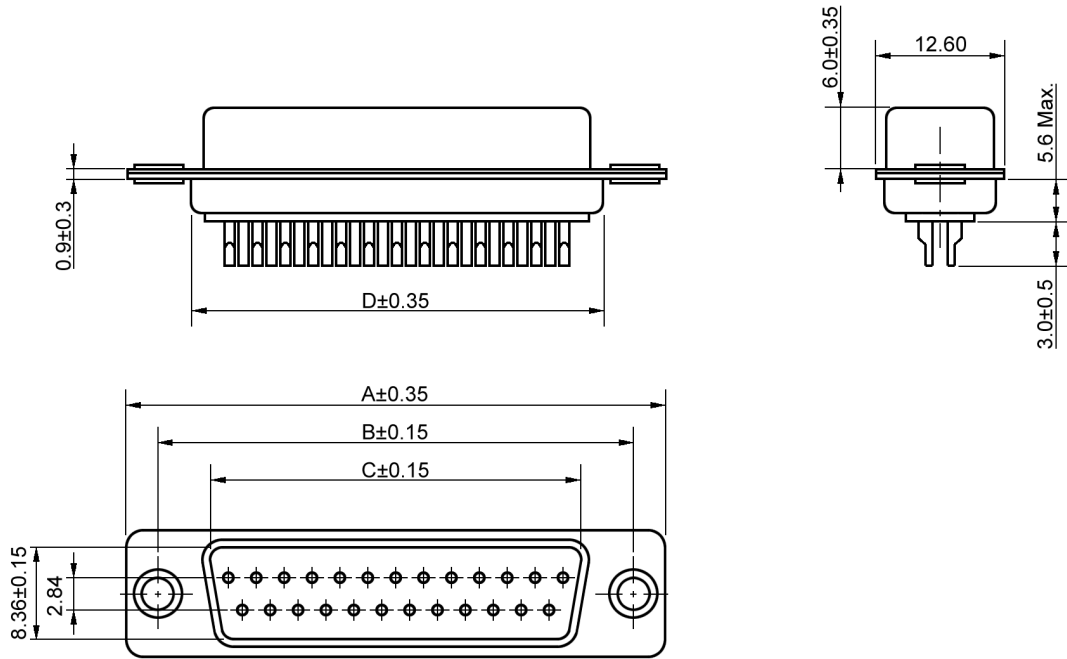

UNIT: (mm)

DIMENSIONS

| Size: | A | B | C | D | Part No: |
|-------|-------|-------|-------|-------|--------------|
| 09P | 30.80 | 24.99 | 16.92 | 19.20 | 2101-0180-01 |
| 15P | 39.15 | 33.32 | 25.25 | 27.70 | 2101-0180-02 |
| 25P | 53.00 | 47.04 | 38.96 | 41.10 | 2101-0180-03 |
| 37P | 69.30 | 63.50 | 55.42 | 57.30 | 2101-0180-04 |
| 50P | | | | | On Request |

MATERIAL SPECIFICATIONS:

Shell: Steel, Tin or Ni Plated (With Dimples)
 Zinc Plated (Without Dimples)
 Insulator: Glass Filled PBT, UL 94 V-0
 Contacts: Brass, Stamped Pins
 Gold over Nickel
 Rivet: Copper-Alloy, Ni Plated

TECHNICAL SPECIFICATIONS:

Current Rating:
 Contact Resistance: 15 mΩ Max.
 Insulator Resistance: 1000 MΩ Min.
 Test Voltage: 500V AC for 1 Minute
 Operating Temperature: -55°C to +105°C

| | | | |
|--------------------|--------------|-------|---------------|
| DATE 2011-06-10 | DRAWN MRR | SCALE | MATERIAL TYPE |
| | APPROVED | | REPLACES |



DBxx-SP
 Sub-D Male, Solder Cup

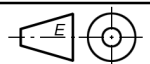

DRAWING No. 2101-0180-0x