

TECHNICAL SPECIFICATIONS

D-Sub Hood:

Material: Zinc, Nickel Plated
 Operating Temperature: -25°C to +90°C
 Cable Entry: 90° Side Entry
 Jackscrews: UNC 4-40, M3 on request
 Cable O.D:
 9-way: Up to 8,1mm
 15-way: Up to 8,1mm
 25-way: Up to 11,4mm
 37-way: Up to 16,5mm
 50-way: Up to 16,5mm
 Type of grommets: Compression Inserts

D-Sub High Density:

Insulator: PBT, Black, UL94 V-0
 Shell: Stamped Steel, Tin Plated
 Contact pins: Copper Alloy
 Stamped & Formed pins: 100 inserts min
 Contacts Plating: Selective Gold over Nickel
 Operating Temperature: -55°C to +105°C
 Withstanding voltage: 500V for 1 minute

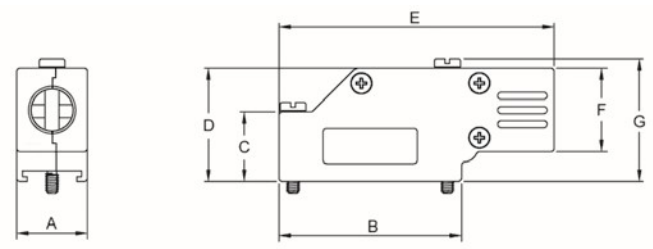

Features:

- Available in sizes 15-26-44
 Other sizes on request
- Suitable for any common Sub-D connector
- Re-Openable

Size	A	B	C	D	E	F	G
9	15,0	31,0	15,0	24,4	50,8	18,0	26,5
15	15,3	39,2	15,0	24,0	59,0	18,0	26,5
25	16,0	54,0	23,0	34,5	73,0	24,5	37,0

Ordering information:

D-Sub Connector Kits (100 inserts min.)

Size:	P/N - Kitted:	Product Code - MALE Conn. Kit
HD 15	6355-0100-01	DCMR09-ULP-HDP15-K
HD 26	6355-0100-02	DCMR15-ULP-HDP26-K
HD 44	6355-0100-03	DCMR25-ULP-HDP44-K

Size:	P/N - Kitted:	Product Code - FEMALE Conn. Kit
HD 15	6355-0100-11	DCMR09-ULP-HDS15-K
HD 26	6355-0100-12	DCMR15-ULP-HDS26-K
HD 44	6355-0100-13	DCMR25-ULP-HDS44-K

