

AC2255

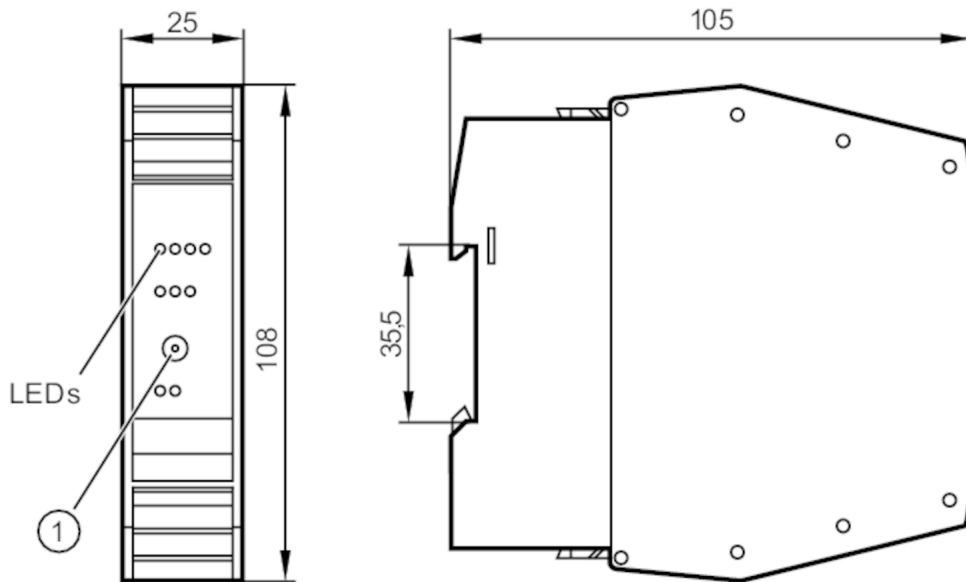

AS-Interface control cabinet module

SmartL25 4DI 2DO R C



1 addressing socket



Electrical data

Operating voltage	[V]	26.5...31.6 DC
Max. current consumption from AS-i	[mA]	50
Max. current load total	[A]	6; (resistive)
Integrated watchdog		yes

Inputs / outputs

Number of inputs and outputs	Number of digital inputs: 4; Number of relay outputs: 2
------------------------------	---

Inputs

Number of digital inputs		4
Input circuit of digital inputs		PNP
Sensor supply of the inputs		external (E+/E-), to PELV
Voltage supply	[V]	20...30
Max. total current rating of inputs	[mA]	500
Input current High	[mA]	6...10
Input current Low	[mA]	0...2
Min. switching level high signal	[V]	11
Digital inputs protected against short circuits		yes



AS-Interface control cabinet module

SmartL25 4DI 2DO R C

Outputs																
Voltage range DC [V]	24; (All outputs have to be supplied with the same voltage. 2 x 24 V DC)															
Voltage range AC [V]	10...240; (All outputs have to be supplied with the same voltage. 2 x 240 V AC, same phase conductor)															
Max. current load per output [mA]	6000; (resistive)															
Number of relay outputs	2															
Short-circuit proof	no															
Electrically separated	yes															
Operating conditions																
Ambient temperature [°C]	-25...70															
Note on ambient temperature	cRUus: -25...60 °C															
Protection	IP 20															
Tests / approvals																
EMC	EN 50295															
	EN 50178															
MTTF [years]	410															
AS-i classification																
AS-i version	2.1															
AS-i addressing	addressing socket															
Extended addressing mode possible	yes															
AS-i profile	S-7.A.E															
AS-i I/O configuration [hex]	7															
AS-i ID code [hex]	A.E															
AS-i certificate pending	yes															
Assignment of the data bits	<table border="1"> <thead> <tr> <th>data bit</th> <th>D0</th> <th>D1</th> <th>D2</th> <th>D3</th> </tr> </thead> <tbody> <tr> <td>input</td> <td>I-1</td> <td>I-2</td> <td>I-3</td> <td>I-4</td> </tr> <tr> <td>Output</td> <td>O-1</td> <td>O-2</td> <td>-</td> <td>-</td> </tr> </tbody> </table>	data bit	D0	D1	D2	D3	input	I-1	I-2	I-3	I-4	Output	O-1	O-2	-	-
	data bit	D0	D1	D2	D3											
	input	I-1	I-2	I-3	I-4											
Output	O-1	O-2	-	-												
Mechanical data																
Weight [g]	172															
Type of mounting	mounting on DIN rail; string mounting possible															
Materials	PA															
Displays / operating elements																
Display	switching status	LED, yellow														
	operation	LED, green														
	errors	LED, red														
Accessories																
Accessories (optional)	COMBICON connectors															
Remarks																
Pack quantity	1 pcs.															



AS-Interface control cabinet module

SmartL25 4DI 2DO R C

Electrical connection

COMBICON:

Connection

I-	I-	E+	E-
I1	I2	I3	I4
I+	I+	I+	I+

14	11	11	12
24	21	21	22
A+	A-		

A+	AS-i +
A-	AS-i -
I+	Sensor supply +24V
I-	Sensor supply 0V
E+	external supply +24V
E-	external supply 0V
I1...I4	switching input sensor 1...4