

3-641242-3 ✓ ACTIVE

MTA | MTA 100

TE Internal #: 3-641242-3

MTA 100, Standard Rectangular Connectors, Connector Assembly, Receptacle, Mating Retention, Locking Ramp Mating Retention Type

[View on TE.com >](#)



Connectors > Rectangular Connectors > Standard Rectangular Connectors > Nylon Gold Plated Receptacle: 2.54mm, No Mating Alignment, MTA 100

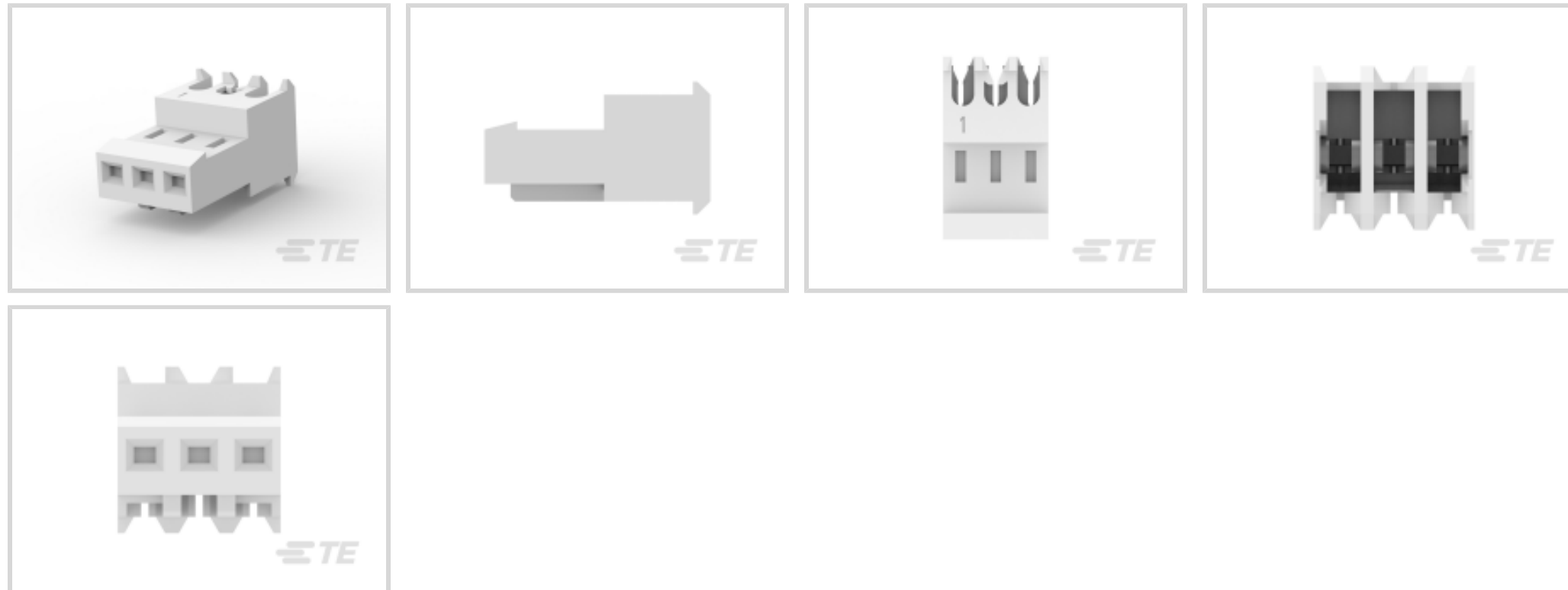

Connector Product Type: **Connector Assembly**

Connector & Housing Type: **Receptacle**

Mating Alignment: **Without**

Mating Retention: **With**

Mating Retention Type: **Locking Ramp**

[All Nylon Gold Plated Receptacle: 2.54mm, No Mating Alignment, MTA 100 \(479\)](#)

## Features

### Product Type Features

|                                   |                    |
|-----------------------------------|--------------------|
| Product Style                     | Assembly           |
| Shape                             | Rectangular        |
| Wire/Cable Type                   | Stranded           |
| Connector Type                    | Connector Assembly |
| Housing Type                      | Receptacle         |
| Connector Product Type            | Connector Assembly |
| Connector & Housing Type          | Receptacle         |
| Connector System                  | Wire-to-Board      |
| Sealable                          | No                 |
| Connector & Contact Terminates To | Wire & Cable       |

### Configuration Features

|                     |   |
|---------------------|---|
| Number of Cavities  | 3 |
| Number of Positions | 3 |



|                |         |
|----------------|---------|
| Number of Rows | 1       |
| Panel Gasket   | Without |

### Electrical Characteristics

|                   |         |
|-------------------|---------|
| Operating Voltage | 250 VAC |
|-------------------|---------|

### Contact Features

|  |         |
|--|---------|
| Contact Layout                                 | In-line |
| Contact Transmits (Typical)                    | Signal  |
| Contact Type                                   | Female  |
| Wire Contact Termination Area Plating Material | Tin     |
| Contact Underplating Material                  | Nickel  |
| Contact Mating Area Plating Material           | Gold    |
| Contact Retention Within Housing               | With    |
| Contact Current Rating (Max)                   | 5 A     |

### Termination Features

|                                    |                                     |
|------------------------------------|-------------------------------------|
| Termination Method to Wire & Cable | Insulation Displacement Crimp (IDC) |
|------------------------------------|-------------------------------------|

### Mechanical Attachment

|                                       |                            |
|---------------------------------------|----------------------------|
| Panel Mount                           | No                         |
| Contact Retention Type Within Housing | Locking Lance              |
| Panel Mount Feature                   | Without                    |
| Mating Alignment                      | Without                    |
| Mating Retention                      | With                       |
| Mating Retention Type                 | Locking Ramp               |
| Connector Mounting Type               | Cable Mount (Free-Hanging) |

### Housing Features

|                    |                |
|--------------------|----------------|
| Housing Color      | White          |
| Housing Material   | Nylon 6/6      |
| Centerline (Pitch) | 2.54 mm[.1 in] |

### Dimensions

|           |                    |
|-----------|--------------------|
| Width     | 7.75 mm[.305 in]   |
| Height    | 13.21 mm[.52 in]   |
| Length    | 7.62 mm[.3 in]     |
| Wire Size | .2 mm <sup>2</sup> |



### Usage Conditions

|                             |                            |
|-----------------------------|----------------------------|
| Operating Temperature Range | -55 – 105 °C[-67 – 221 °F] |
|-----------------------------|----------------------------|

### Operation/Application

|                     |        |
|---------------------|--------|
| Shielded            | No     |
| Circuit Application | Signal |

### Industry Standards

|                        |            |
|------------------------|------------|
| CSA Rating             | Certified  |
| Agency/Standard        | CSA, UL    |
| UL Rating              | Recognized |
| CSA File Number        | LR7189     |
| UL File Number         | E28476     |
| UL Flammability Rating | UL 94V-2   |

### Packaging Features

|                    |         |
|--------------------|---------|
| Packaging Quantity | 500     |
| Packaging Method   | Bag/Box |

### Product Compliance

[For compliance documentation, visit the product page on TE.com>](#)

|   |   |
|---|---|
| EU RoHS Directive 2011/65/EU                  | Compliant   |
| EU ELV Directive 2000/53/EC                   | Compliant   |
| China RoHS 2 Directive MIIT Order No 32, 2016 | No Restricted Materials Above Threshold   |
| EU REACH Regulation (EC) No. 1907/2006        | Current ECHA Candidate List: JAN 2021 (211)<br>Candidate List Declared Against: JAN 2021 (211)<br>Does not contain REACH SVHC |
| Halogen Content                               | Low Halogen - Br, Cl, F, I < 900 ppm per homogenous material. Also BFR/CFR/PVC Free   |
| Solder Process Capability                     | Not applicable for solder process capability  |

#### Product Compliance Disclaimer

This information is provided based on reasonable inquiry of our suppliers and represents our current actual knowledge based on the information they provided. This information is subject to change. The part numbers that TE has identified as EU RoHS compliant have a maximum concentration of 0.1% by weight in homogenous materials for lead, hexavalent chromium, mercury, PBB, PBDE, DBP, BBP, DEHP, DIBP, and 0.01% for cadmium, or qualify for an exemption to these limits as defined in the Annexes of Directive 2011/65/EU (RoHS2). Finished electrical and electronic equipment products will be CE marked as required by Directive 2011/65/EU. Components may not be CE marked. Additionally, the part

numbers that TE has identified as EU ELV compliant have a maximum concentration of 0.1% by weight in homogenous materials for lead, hexavalent chromium, and mercury, and 0.01% for cadmium, or qualify for an exemption to these limits as defined in the Annexes of Directive 2000/53/EC (ELV). Regarding the REACH Regulation, the information TE provides on SVHC in articles for this part number is based on the latest European Chemicals Agency (ECHA) 'Guidance on requirements for substances in articles' posted at this URL: <https://echa.europa.eu/guidance-documents/guidance-on-reach>

## Compatible Parts



Also in the Series | **MTA 100**



Insertion & Extraction Tools(2)



PCB Connector Covers(107)



PCB Connector Keying(1)



Standard Rectangular Connectors (1730)



Wire-to-Board Connector Contacts(18)



Wire-to-Board Headers & Receptacles (1182)

## Customers Also Bought



TE Part #2013393-1  
DYNAMIC ME INSIDE HSG



TE Part #1775443-2  
AMP HPI 1.5MM HEADERS

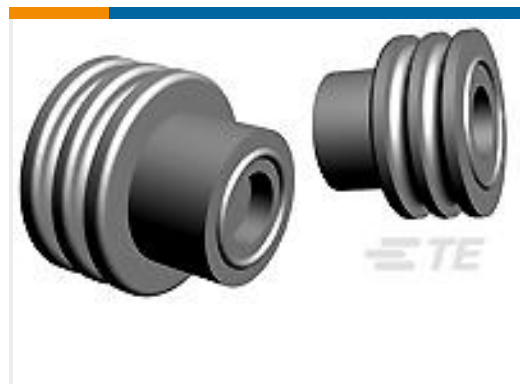

TE Part #1823111-1  
SINGLE WIRE SEAL, FOR WIRE 2.5  
SQMM, BN



TE Part #1623402-1  
CRG1206 1% 100K



TE Part #1981919-1  
DYNAMIC ME OUTSIDE CASE



TE Part #2-1971793-2  
Glow Wire Sig GRACE INERTIA Plug



TE Part #1-146261-5  
30 MODII HDR DRST B/A .100CL



TE Part #1734098-6  
Champ050 60p A/P RCPT 25CL PB



TE Part #1744427-6  
EP Header Asy, Shrouded, 6 Pos, GW



TE Part #EG8801-000  
400R0111-24-9

## Documents



**Product Drawings**

[03P MTA100 CONN ASSY NATL](#)

English

---

**CAD Files**

[3D PDF](#)

3D

**Customer View Model**

[ENG\\_CVM\\_CVM\\_3-641242-3\\_R.2d\\_dxf.zip](#)

English

**Customer View Model**

[ENG\\_CVM\\_CVM\\_3-641242-3\\_R.3d\\_igs.zip](#)

English

**Customer View Model**

[ENG\\_CVM\\_CVM\\_3-641242-3\\_R.3d\\_stp.zip](#)

English

By downloading the CAD file I accept and agree to the [Terms and Conditions](#) of use.

---

**Datasheets & Catalog Pages**

[MTA, CST-100 II, SL-156 and AMP Economy Power \(EP\) Connectors](#)

English

---

**Product Specifications**

[Application Specification](#)

English

---

**Agency Approvals**

[Agency Approval Document](#)

English

---