

Series 11

MINIATURE 10 AMP DOUBLE-BREAK SNAP ACTION SWITCHES

This rugged miniature switch features the Butterfly® double-break snap action switch mechanism. It is ideal for tough applications where high current capability and Butterfly® reliability are needed.

APPLICATIONS:

- Welding guns
- Pipeline valve actuator
- Discrete length tape dispenser machines
- Lift trucks
- Electrical contractors

KEY FEATURES:

- Gold or silver contacts
- Variety of terminals configurations and styles available
- UL recognized and CSA certified
- Reset style switch available
- Roller lever and overtravel plunger actuator are available



ACTUAL SIZE

ORDERING INFORMATION:

Switches

Part Number	Terminals
11-104	End Solder
11-204	#4 Screw
11-304	Side Solder
11-314 Reset	Side Solder
11-504	Quick Disconnect .250

Actuators (see page 59 for additional specifications)

Part Number	Oper. Force	Release Force	Pretravel	Overtravel	Movement Diff.	Operating Point
71-1040 Roller Lever	3.5 oz max	2 oz min	.093 max	.062 min	.030 ± .015	.671 ± .031
71-2010 Over Travel	8 ± 3 oz	4 oz min	.050 max	.215 min	.020 ± .005	.828±.015

STANDARDS / AGENCY / RATINGS:



SERIES 11: MINIATURE 10 AMP DOUBLE-BREAK

END SOLDER

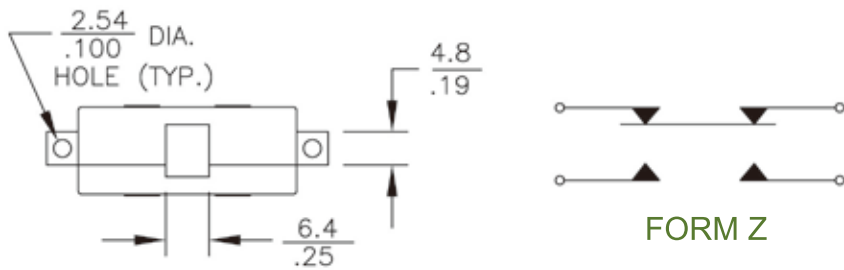

4 SCREW

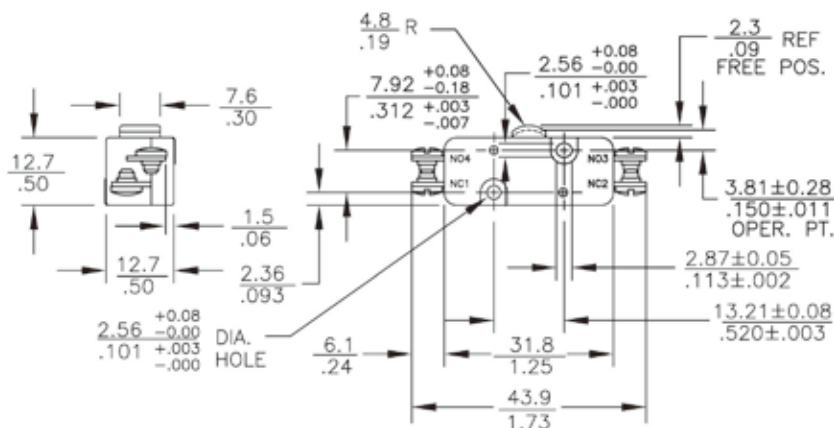
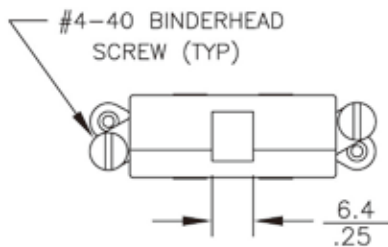

SIDE SOLDER

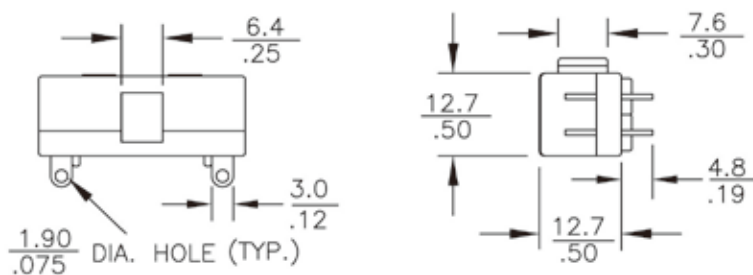

QUICK DISCONNECT

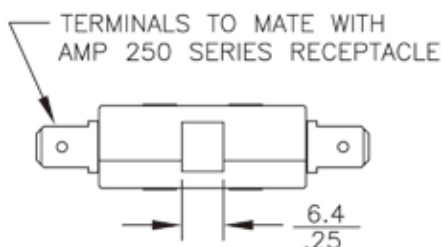

MECHANICAL / ELECTRICAL CHARACTERISTICS:

Pretravel:

0.050 inches max

Overtravel:

0.015 inches min

Operating Force:

8 oz + 3 oz

Release Force:

4 oz min

Movement Differential:

0.020 ± 0.007 inches

Operating Point:

0.150 ± 0.011 inches

(from mounting hold centers)

Circuit:

SPDT-DB (Form Z)

Electrical Ratings (Typical):

Circuitry	125/250 VAC	28 VDC
SPST-DB NC (Form Y) or NO (Form X)	10 amp (75-80% PF)	10 amp Ind 15 amp Res
SPDT-DB (Form Z)	1/2 HP 125 VAC	7 amp Ind 10 amp Res
SPDT-SB (Form C)	3/4 HP 250 VAC	4 amp Ind 6 amp Res